

**Re-survey**  
**Township N<sup>o</sup> 16 N. Range N<sup>o</sup> 8 W. Mer. Mich.**

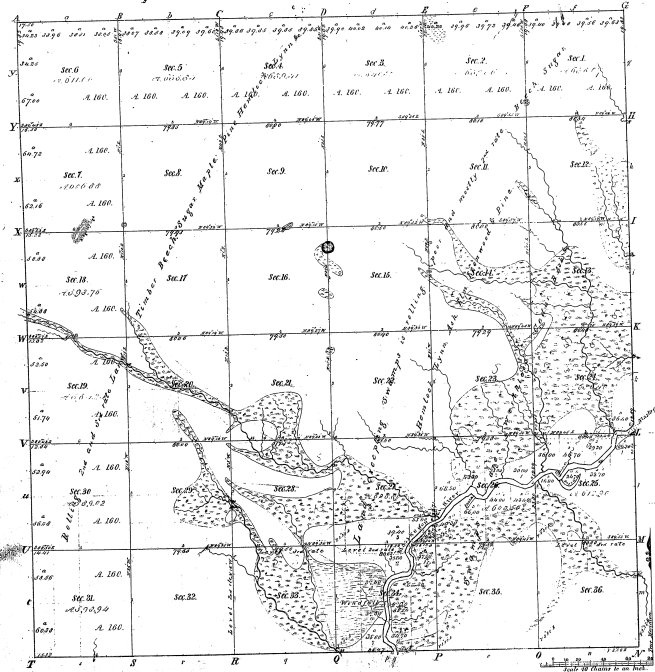

Mileage of		Mileage of	
Public Courses	Private Courses	Public Courses	Private Courses
12	9		

12-9

**Total number of Acres 22651.72**

Survey Estimated	By Whom Surveyed	Date of Estimate	Amount of Survey	When Surveyed	How far and out of the Reg. Book
Township Lines	Wm. H. Hays	Nov 28, 1852	22,651.72	1852	1250
Subdivisions	Wm. H. Hays	Apr 16, 1853	22,651.72	1853	1250
Clearances	Wm. H. Hays	Apr 16, 1853	22,651.72	1853	1250

The above Map of Township N. 16 N. Range N. 8 W. Mer. Mich. is a true and correct copy of the original survey, and is hereby confirmed to the field notes of the survey thereof on file in this Office, which have been examined and approved.

Surveyor General's Office  
 Detroit City, 26. 1868.