

Township 1° 32' N. Range 1° 2' W. Mer. Mich.

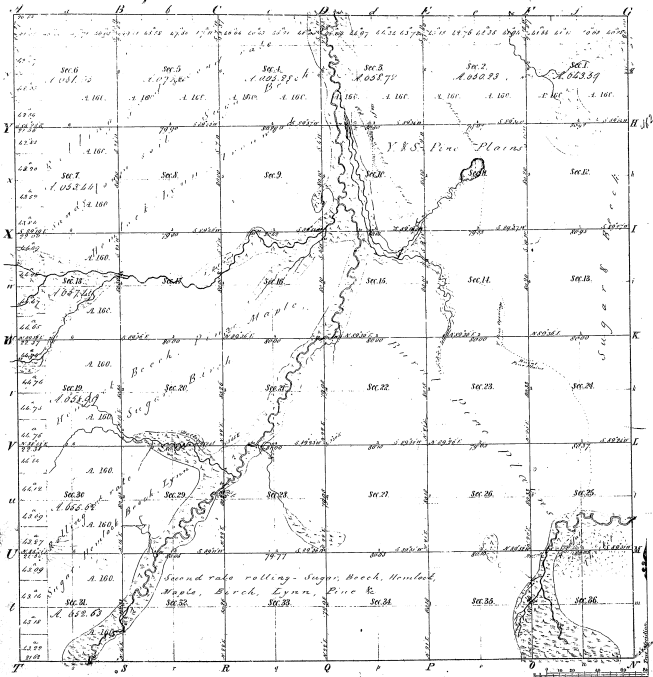

Boundaries of
 Public Courses: 1814 Public Courses: 1825 Public Courses: 1832

18-22

18-22

Total number of Acres 23 240 44

Survey designated	By whom performed	Date of Contract	Amount of Survey	Plan designated	Plan filed and date of Survey
Township Survey	John McLean	Jan. 25 1830	36 35 1/2	2nd Quarter 1830	
Subdivisions	William Beards	Apr. 22 1850	62 31 1/2	2nd Quarter 1850	

The above Map of Township 1° 32' North of Range 1° 2' West of the Principal Meridian Michigan is strictly conformable to the field notes of the survey thereon filed in the Office which have been examined and approved

Surveyor General's Office
 Detroit, Jan. 22 1850

Charles Hodge, Supt. Genl.