

TOWNSHIP NO. 34 NORTH, RANGE NO. 7 EAST, MICHIGAN MERIDIAN, MICHIGAN.

SURVEY OF ISLAND IN SECTION 36.

20-3

20-3-10

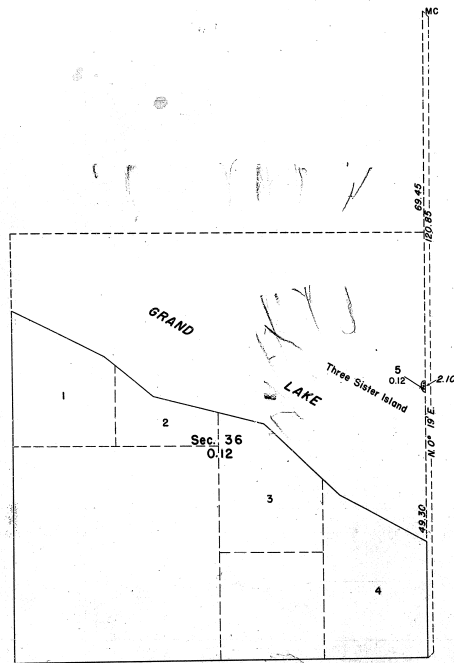

MEMORANDUM

THIS PLAT REPRESENTS THE SURVEY OF THAT PORTION OF THREE SISTER ISLAND IN GRAND LAKE IN SECTION 36, T.34 N., R.7 E., S. THE ISLAND WAS NOT INCLUDED IN THE ORIGINAL SURVEY OF THE TOWNSHIP NOR SHOWN UPON THE OFFICIAL PLATS APPROVED FEBRUARY 7, 1941, AND AUGUST 3, 1957.

THE SURVEY WAS EXECUTED PURSUANT TO AUTHORITY CONTAINED IN GENERAL LAND OFFICE LETTER 1020424 "E" DATED JULY 9, 1940, WHICH BEARS DEPARTMENTAL APPROVAL UNDER DATE OF JULY 12, 1940.

Scale: 10 Chains to an inch. AREA SURVEYED 0.12 ACRES.

EXTENSION DESIGNATED BY WHOM SURVEYED	GROUP	NO.	DATE	M.B.	CHS.	BEGUN	COMPLETED	WELLS	WELLS
								EXAMINED	EXAMINED
EXTENSION BEARERS	HUGH B. CRAWFORD SURVEYOR	47	JULY 26 1940.	1	45.85	OCT. 1, 1940.			
		0			2.06				

OFFICE OF SUPERVISOR OF SURVEYS
DENVER, COLORADO, FEBRUARY 14, 1941.

THE ABOVE PLAT OF TOWNSHIP NO. 34 NORTH, RANGE NO. 7 EAST, OF THE MICHIGAN MERIDIAN, MICHIGAN, IS STRICTLY CONFORMABLE TO THE FIELD NOTES OF THE SURVEY THEREON, WHICH HAVE BEEN EXAMINED AND APPROVED.

W. D. Johnson
SUPERVISOR OF SURVEYS.

UNITED STATES
DEPARTMENT OF THE INTERIOR
GENERAL LAND OFFICE
WASHINGTON, D.C., MARCH 7, 1941.

THE SURVEY REPRESENTED BY THIS PLAT, HAVING BEEN CORRECTLY EXECUTED IN ACCORDANCE WITH THE REQUIREMENTS OF LAW AND THE REGULATIONS OF THIS OFFICE, IS HEREBY ACCEPTED.

Paul Ward Hefner
ACTING ASSISTANT COMMISSIONER.

TOWNSHIP 34 NORTH, RANGE 7 EAST, MICHIGAN MERIDIAN, MICHIGAN
ISLAND SURVEYS, SECS. 23, 24 & 26

20-3-14

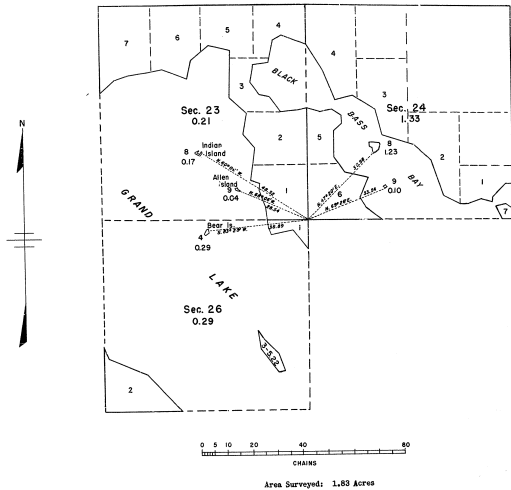

This plat represents the survey of islands in Grand Lake and Black Bay of Grand Lake, in secs. 23, 24 and 26, which were not included in the original survey of the township which is represented on the plat approved August 3, 1857.

Surveyed by Hugh B. Crawford, Cadastral Engineer, from September 29 to October 10, 1953 under Special Instructions for Group 65, Michigan, dated June 3, 1953 and Supplemental Special Instructions dated August 25, 1953.

The island in sec. 26, containing 5.22 acres, shown as surveyed on the plat approved August 3, 1857, is designated as Lot 3 in order to finish a legal description thereof.

UNITED STATES DEPARTMENT OF THE INTERIOR
BUREAU OF LAND MANAGEMENT
Washington, D. C., August 11, 1964

This plat is strictly conformable to the approved field notes, and the survey, having been correctly executed in accordance with the requirements of law and the regulations of this Bureau, is hereby accepted.

For the Director

Earl S. Harrington
Cadastral Engineering Officer

20-30

TOWNSHIP 34 NORTH, RANGE 7 EAST, MICHIGAN MERIDIAN, MICHIGAN
ISLAND SURVEYS, SECS. 23, 24 & 26

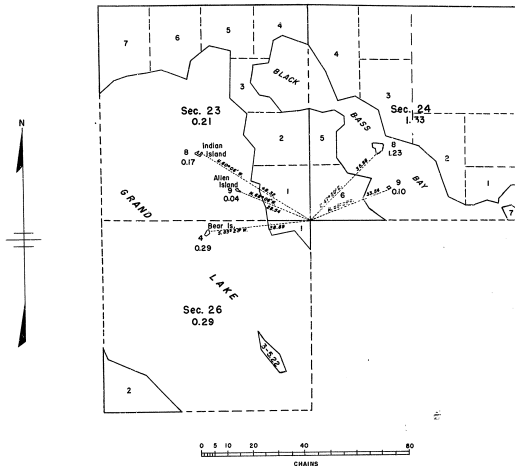

Area Surveyed: 1.83 Acres

This plat represents the survey of islands in Grand Lake and Black Bass Bay of Grand Lake, in secs. 23, 24 and 26, which were not included in the original survey of the township which is represented on the plat approved August 9, 1887.

Surveyed by Hugh B. Crawford, Cadastral Engineer, from September 20 to October 10, 1953 under Special Instructions for Group 50, Michigan, dated June 5, 1953 and Supplemental Special Instructions dated August 26, 1953.

The island in sec. 26, containing 0.29 acres, shown as surveyed on the plat approved August 9, 1887, is designated as Lot 3 in order to furnish a legal description thereof.

UNITED STATES DEPARTMENT OF THE INTERIOR
BUREAU OF LAND MANAGEMENT
Washington, D. C., August 11, 1954

This plat is strictly conformable to the approved field notes, and the survey, having been correctly executed in accordance with the requirements of law and the regulations of this Bureau, is hereby accepted.

For the Director

Carl A. Harrington
Cadastral Engineering Officer