

County of _____

Township N^o 2 N Range N^o 15 East Mer. Mich.

26-39

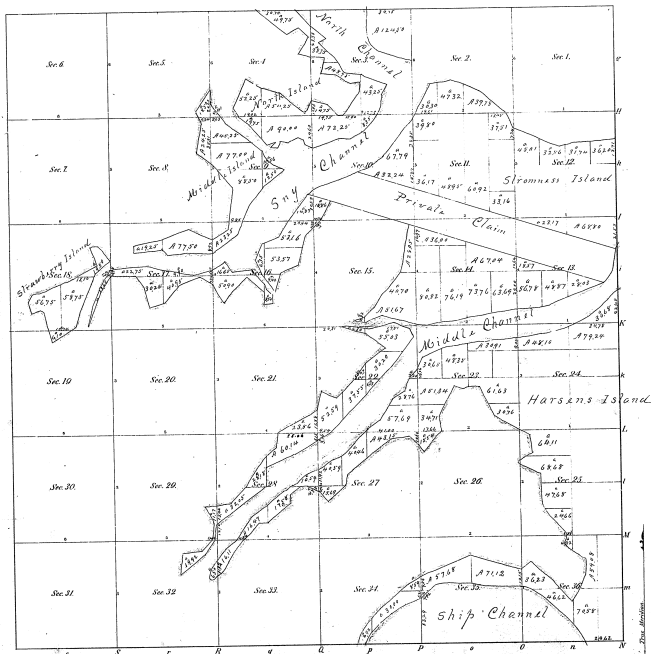

Surveyed in 1887, by W. B. Bland Deputy Surveyor.
 This plot is strictly in conformity with the
 field notes of the Survey and is hereby approved
 in presence of
Rowan B. Smith
 Commissioner of the State Land Office

I certify that the above is a true copy of the
 plot in this office.
Michigan State Land Office
 Lansing

December 31, 1891

T 2 N R 15 E

26-39.

2639 ②



County of St. Clair

Township N^o 2 N Range N^o 15 E Mer. Mich.

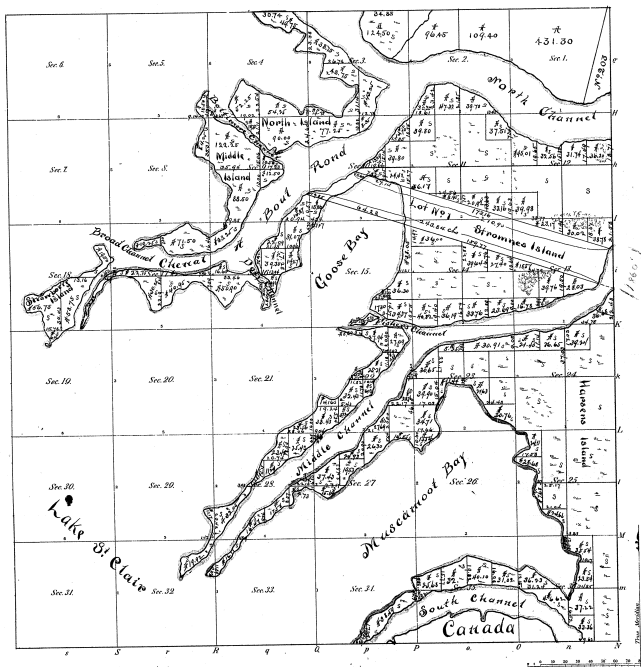

Surveyed in 1887, by H.D. Bartholomew, Deputy Surveyor.

This plat is strictly in conformity
with the first notes of the survey
and is hereby approved
Respectfully,
Rover D Dix

December 31, 1890

Cum state land office

I certify that the above is a true copy of the
plat in this office.

Rover D Dix
Michigan State Land Office,
 Lansing, Dec 31, 1890.

26-39

County of St. Clair

Township 1° 2' N Range 1° 15' E Mer. Mich.

26-39-3

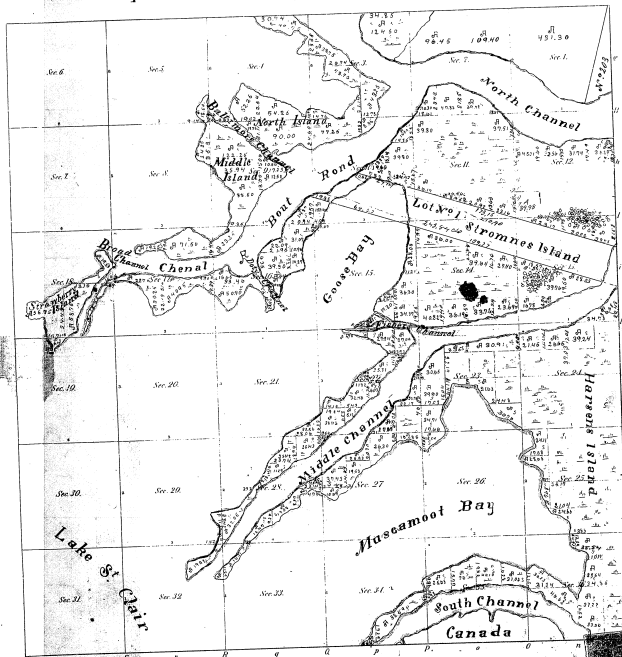

Surveyed in 1833, by H.S. Bartholemew, Deputy Surveyor.

This plot is strictly in conformity
with the Field Notes of the Survey
and is hereby approved
R. D. Dine
Deputy Surveyor

I certify that the above is a true copy of the
plot on file in the
Michigan State Land Office
 Lansing, Mich. 21 1870
Rover

Deputy