

26-25

26-25 (2)

Pursuant to a contract with and instructions from Edward Tiffin Esquire Surveyor General
 of the United States bearing date the 20th day of November 1874 I have a survey and laid out and
 surveyed the above described fractional Township and do hereby certify that it had such marks and bounds
 laid out and surveyed as are represented on said plat and described in the field notes hereto annexed
 and returned to the 19th day of the Surveyor General's Office bearing date the 19th day of the 1875

Township N° 6 N., Range N° 11 E., Mer. (Mich.)

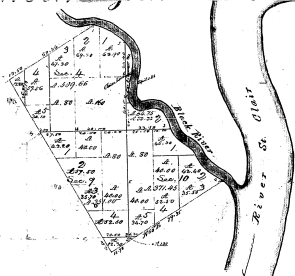

26° 25'

26-25

Meadow of	
St. Clair	
Sec.	Acres
1	1000
2	1000
3	1000
4	1000
5	1000
6	1000
7	1000
8	1000
9	1000
10	1000
11	1000
12	1000
13	1000
14	1000
15	1000
16	1000
17	1000
18	1000
19	1000
20	1000
21	1000
22	1000
23	1000
24	1000
25	1000
26	1000
27	1000
28	1000
29	1000
30	1000
31	1000
32	1000
33	1000
34	1000
35	1000
36	1000
37	1000
38	1000
39	1000
40	1000
41	1000
42	1000
43	1000
44	1000
45	1000
46	1000
47	1000
48	1000
49	1000
50	1000

Survey	By	Date	Book	Page	Section	Acres
1	2	3	4	5	6	7
8	9	10	11	12	13	14
15	16	17	18	19	20	21
22	23	24	25	26	27	28
29	30	31	32	33	34	35
36	37	38	39	40	41	42
43	44	45	46	47	48	49
50	51	52	53	54	55	56
57	58	59	60	61	62	63
64	65	66	67	68	69	70
71	72	73	74	75	76	77
78	79	80	81	82	83	84
85	86	87	88	89	90	91
92	93	94	95	96	97	98
99	100	101	102	103	104	105

The above map of Township N° 6 N., Range N° 11 E., Mer. Mich., is truly conformable to the field notes of the Survey of the St. Clair River, which have been examined and approved by the Surveyors General Office.

