

Township N. VII south, Range N. III west (Mc. Tor.)

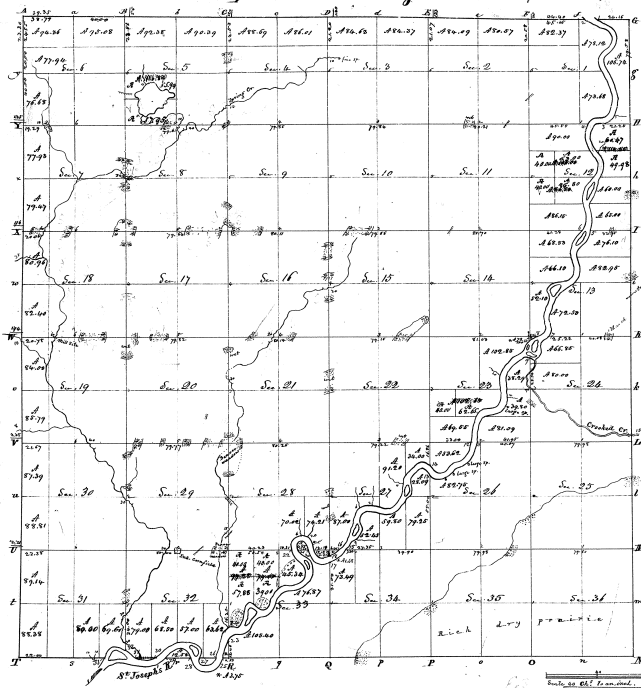

Continued

Surveyed in April 1828 by Calvin Rutens Del.

23 ✓

10

2-12

Bound		Bound	
Acres	Value	Acres	Value
8 1/2	111 74	8 1/2	320
8 1/2	24 15	8 1/2	80
8 1/2	93 37	8 1/2	70 00
8 1/2	80	8 1/2	80
8 1/2	78 68	8 1/2	82 79
8 1/2	180	8 1/2	60
8 1/2	70 07	8 1/2	60
8 1/2	80	8 1/2	60
8 1/2	80 09	8 1/2	38 00
8 1/2	80	8 1/2	101 85
8 1/2	80	8 1/2	160
8 1/2	80 37	8 1/2	39 80
8 1/2	80	8 1/2	81 00
8 1/2	80 63	8 1/2	104 60
8 1/2	80	8 1/2	60 60
8 1/2	80	8 1/2	160
8 1/2	80 01	8 1/2	66 80
8 1/2	80 69	8 1/2	320
8 1/2	80	8 1/2	78
8 1/2	80	8 1/2	160
8 1/2	80 39	8 1/2	160
8 1/2	80	8 1/2	80 75
8 1/2	80 38	8 1/2	81 80
8 1/2	80	8 1/2	80
8 1/2	160	8 1/2	80 00
8 1/2	113 89	8 1/2	30 00
8 1/2	80 08	8 1/2	160
8 1/2	80 36	8 1/2	79 25
8 1/2	77 94	8 1/2	79 00
8 1/2	160	8 1/2	80 00
8 1/2	80	8 1/2	80 00
8 1/2	74 68	8 1/2	320
8 1/2	80	8 1/2	70 25
8 1/2	80	8 1/2	40 50
8 1/2	77 93	8 1/2	80
8 1/2	80	8 1/2	80
8 1/2	80 47	8 1/2	320
8 1/2	80	8 1/2	80
8 1/2	80	8 1/2	80 39
8 1/2	80	8 1/2	80
8 1/2	110 65	8 1/2	80 80
8 1/2	80 00	8 1/2	160
8 1/2	80 00	8 1/2	80 16
8 1/2	80 00	8 1/2	69 60
8 1/2	80 80	8 1/2	80
8 1/2	81 15	8 1/2	80
8 1/2	74 10	8 1/2	80 38
8 1/2	80 85	8 1/2	80
8 1/2	80 53	8 1/2	80 12
8 1/2	81 10	8 1/2	80
8 1/2	160	8 1/2	80 30
8 1/2	80 50	8 1/2	80
8 1/2	80 10	8 1/2	120 50
8 1/2	80	8 1/2	3 75
8 1/2	80	8 1/2	80
8 1/2	80	8 1/2	80 33
8 1/2	80	8 1/2	70 75
8 1/2	80	8 1/2	40 30
8 1/2	80 18	8 1/2	70 00
8 1/2	80	8 1/2	70 78
8 1/2	80 96	8 1/2	160
8 1/2	80	8 1/2	160 00
8 1/2	80	8 1/2	80 00
8 1/2	160 17	8 1/2	720 00

Continued

8 1/2	320
8 1/2	80
8 1/2	73 00
8 1/2	160
8 1/2	80
8 1/2	80 96
8 1/2	80
8 1/2	80 00
8 1/2	80
8 1/2	160 17

Original.

2-37

DIAGRAM of a former LAKEBED
 IN SEC. 5, TOWNSHIP 7 SOUTH, RANGE 12 WEST,
 IN THE STATE OF MICHIGAN.

46° 11' 1"	2.128
48° 01' 0"	2.142
49° 50' 0"	2.156
51° 39' 0"	2.170
53° 28' 0"	2.184
55° 17' 0"	2.198
57° 06' 0"	2.212
58° 55' 0"	2.226
60° 44' 0"	2.240
62° 33' 0"	2.254
64° 22' 0"	2.268
66° 11' 0"	2.282
68° 00' 0"	2.296
69° 49' 0"	2.310
71° 38' 0"	2.324
73° 27' 0"	2.338
75° 16' 0"	2.352
77° 05' 0"	2.366
78° 54' 0"	2.380
80° 43' 0"	2.394
82° 32' 0"	2.408
84° 21' 0"	2.422
86° 10' 0"	2.436
87° 59' 0"	2.450
89° 48' 0"	2.464
91° 37' 0"	2.478
93° 26' 0"	2.492
95° 15' 0"	2.506
97° 04' 0"	2.520
98° 53' 0"	2.534
100° 42' 0"	2.548
102° 31' 0"	2.562
104° 20' 0"	2.576
106° 09' 0"	2.590
107° 58' 0"	2.604
109° 47' 0"	2.618
111° 36' 0"	2.632
113° 25' 0"	2.646
115° 14' 0"	2.660
117° 03' 0"	2.674
118° 52' 0"	2.688
120° 41' 0"	2.702
122° 30' 0"	2.716
124° 19' 0"	2.730
126° 08' 0"	2.744
127° 57' 0"	2.758

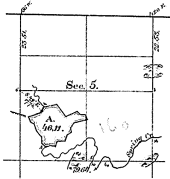

Department of the Interior
 General Land Office

July 22, 1875.

The above diagram of a former Lakebed in Sec. 5, Township 7 South, Range 12 West of the Michigan Meridian, in the State of Michigan, has been constructed from the field notes on file in this office and area calculated in pursuance of the act of Congress, approved 22^d of January 1853.

J. S. Mearns
 Commissioner

U. S. Office Surveyor General of Michigan.

Township N^o 7 S. Range N^o 12 W.
 Lands in St. Joseph River.

Mer. Mich.

2-37

(9)
 2
 1
 2

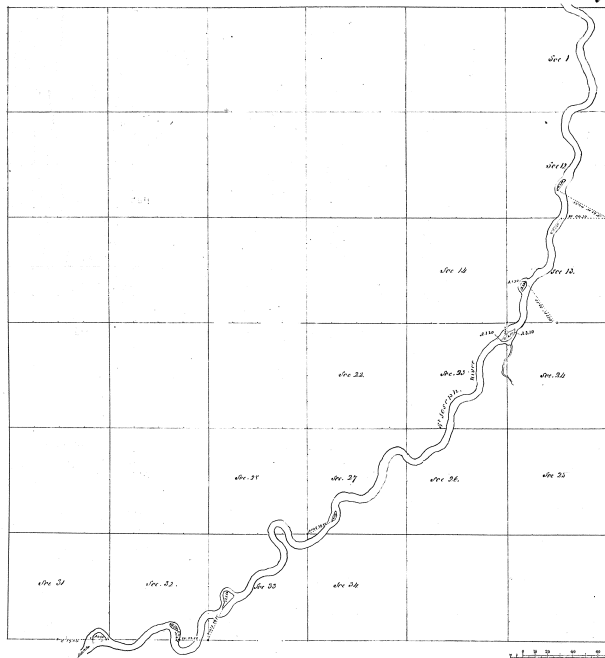

Boundaries of

Pat.	Patress	(1812)	Pat.	Patress	(1812)	Pat.	Patress	(1812)

Total number of Acres 2329

Survey designed.	By Whom Surveyed	Date of Contract	Amount of Survey Acres 25 1/2	When Surveyed	When Claimed in the Court (month year)
Township lines Mandates Additions.	And. Beardslee & Co.	Oct. 11. 1811	2,326.70	2. 1816	

The above Map of Township N^o 7 South of Range N^o 12 West of the Principal Meridian Michigan is a plat of portions in the full view of the survey thereof on file in this Office, which have been examined and approved.

Surveyor General's Office,
 Detroit (1816)

Sacres Lynde, Sec^y Genl