

Township 19<sup>o</sup> 42' N. Range 15<sup>o</sup> W. Mex. Mich.

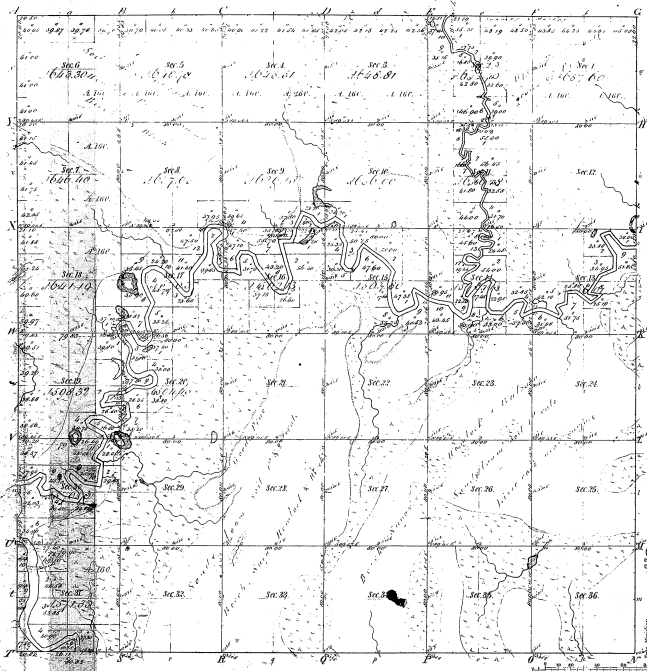

Boundaries of  
 36  
 33  
 36-33

Total number of Acres 2238.38

Original Donor	By Whom Surveyed	Date of Conveyance	Amount of Acres	When Surveyed	By Whom Surveyed
	Wm. H. H. H.	1857-75	6 54 60	1857	Wm. H. H. H.
Underwritten	M. H. H. H.	Jan. 8 1860	92 67 63	1860	M. H. H. H.
J. H. H. H.	M. H. H. H.	Feb. 1860	6 02 60	1860	M. H. H. H.

The above map of Township 19 42' North of Range 15 West, Michigan, was a survey performed in the field under the supervision of the Surveyor General of the State of Michigan, which has been examined and approved.

Surveyor General's Office,  
 Detroit April 7, 1867.  
 Charles H. H.