

Township N<sup>o</sup> 42 N. Range N<sup>o</sup> 16 W.

Mer. Mich.

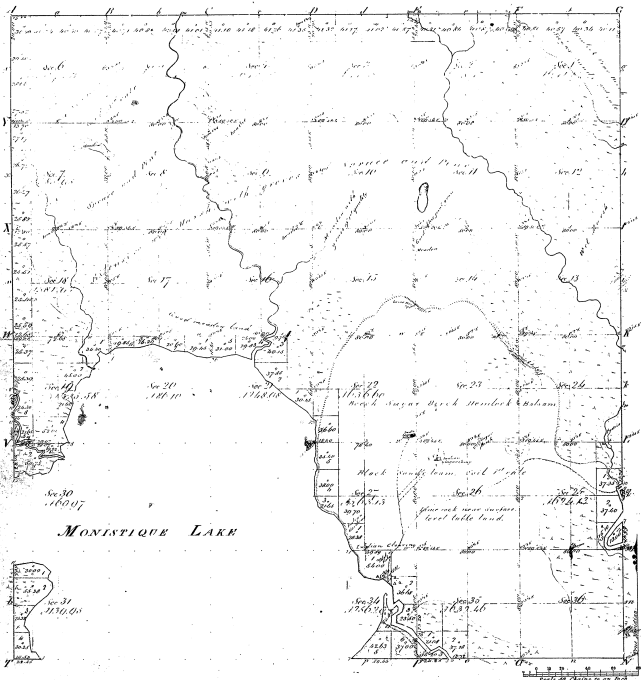

Boundaries of  
Township N42N Range N16W Mer. Mich.

7-3

37-30

Total number of Acres 1,846.53

Survey designated	By Whom Surveyed	Date of Contract	Number of Acres	When Surveyed	When Closed or in the hands of the State
Township line	John Macr- A. Macgregor	28 <sup>th</sup> 58 1853	3 72 59	1853	
Subdivisions	A. Macgregor	June 1856	61 28 59	1856	

The above Map of Township N42 North of Range 01<sup>st</sup> West of the Principal Meridian Michigan is being submitted to the field office of the Survey Dept. in file in this Office which have been examined and approved.

Surveyor General's Office  
Detroit July 28<sup>th</sup> 1857

Wm. H. C. [Signature]  
Clerk