

Township N: 45 N. Range N: 14 W. Mer. Mich.

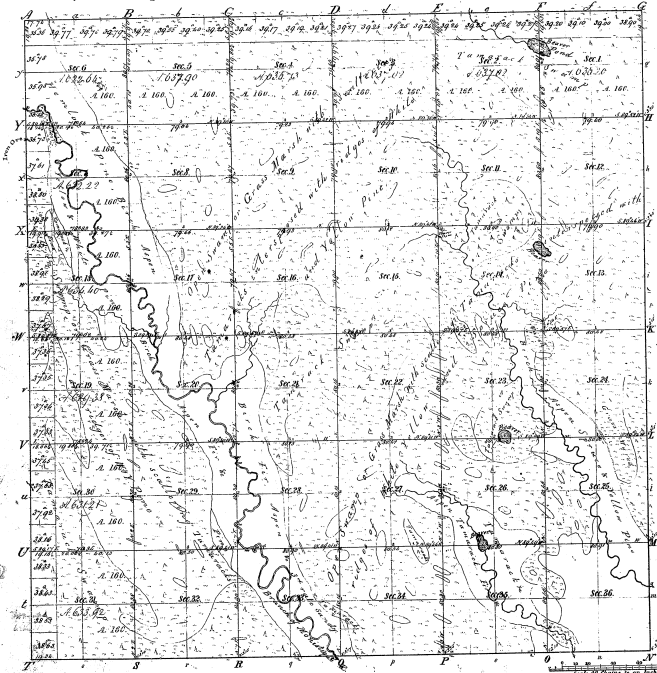

Mileage of			
Partial Courses	1872-1874	Partial Courses	1874-1876
36-23			

36-23

Total number of Acres 22,962.64

	By Whom Surveyed	Date of Contract	Amount of Survey	When Surveyed	How far and what in the Territory was
Township lots	McA. Blunt	April 11 1851	24 59 1/2	1851	5 th Range 1851
Subdivisions	Case, H. Co. & Co.	Nov. 10 1850	66 22 7/8	1850	1 st Range 1850

*The above Map of Township N: 45 North of Range N: 14 West of the Principal Meridian Michigan is truly conformable to the field notes of the survey hereon on file in this Office, which have been examined and approved.
Surveyor General's Office
Detroit Feb 15 1851*

*Charles W. Keeney
Surveyor*