

Township N. 11 South, Range N. 111 West Mer. (Mch. Ter.)

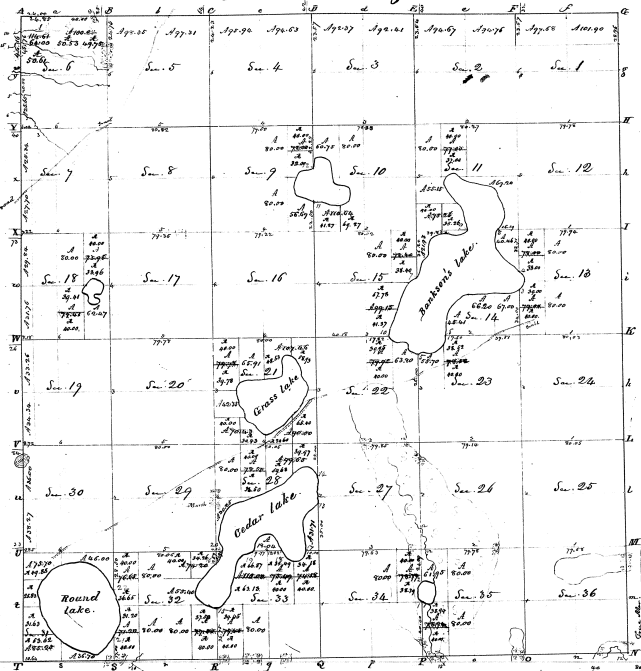

Surveyed on Dec. 1829 & Jan. 1830. by Edward H. Allyn, C.S.

2-15

①
5-2

Section		Section	
Acres	Acres	Acres	Acres
101.90	101.90	16.00	16.00
30.00	30.00	17.00	17.00
27.68	27.68	18.00	18.00
30.00	30.00	19.00	19.00
30.00	30.00	20.00	20.00
30.00	30.00	21.00	21.00
30.00	30.00	22.00	22.00
30.00	30.00	23.00	23.00
30.00	30.00	24.00	24.00
30.00	30.00	25.00	25.00
30.00	30.00	26.00	26.00
30.00	30.00	27.00	27.00
30.00	30.00	28.00	28.00
30.00	30.00	29.00	29.00
30.00	30.00	30.00	30.00
30.00	30.00	31.00	31.00
30.00	30.00	32.00	32.00
30.00	30.00	33.00	33.00
30.00	30.00	34.00	34.00
30.00	30.00	35.00	35.00
30.00	30.00	36.00	36.00
30.00	30.00	37.00	37.00
30.00	30.00	38.00	38.00
30.00	30.00	39.00	39.00
30.00	30.00	40.00	40.00
30.00	30.00	41.00	41.00
30.00	30.00	42.00	42.00
30.00	30.00	43.00	43.00
30.00	30.00	44.00	44.00
30.00	30.00	45.00	45.00
30.00	30.00	46.00	46.00
30.00	30.00	47.00	47.00
30.00	30.00	48.00	48.00
30.00	30.00	49.00	49.00
30.00	30.00	50.00	50.00
30.00	30.00	51.00	51.00
30.00	30.00	52.00	52.00
30.00	30.00	53.00	53.00
30.00	30.00	54.00	54.00
30.00	30.00	55.00	55.00
30.00	30.00	56.00	56.00
30.00	30.00	57.00	57.00
30.00	30.00	58.00	58.00
30.00	30.00	59.00	59.00
30.00	30.00	60.00	60.00

made by Ed. H. Allyn

101.90	160.00
30.00	320.00
27.68	300.00
30.00	360.00
30.00	420.00
30.00	480.00
30.00	540.00
30.00	600.00
30.00	660.00
30.00	720.00
30.00	780.00
30.00	840.00
30.00	900.00
30.00	960.00
30.00	1020.00
30.00	1080.00
30.00	1140.00
30.00	1200.00
30.00	1260.00
30.00	1320.00
30.00	1380.00
30.00	1440.00
30.00	1500.00
30.00	1560.00
30.00	1620.00
30.00	1680.00
30.00	1740.00
30.00	1800.00
30.00	1860.00
30.00	1920.00
30.00	1980.00
30.00	2040.00
30.00	2100.00
30.00	2160.00
30.00	2220.00
30.00	2280.00
30.00	2340.00
30.00	2400.00
30.00	2460.00
30.00	2520.00
30.00	2580.00
30.00	2640.00
30.00	2700.00
30.00	2760.00
30.00	2820.00
30.00	2880.00
30.00	2940.00
30.00	3000.00

102800

Original.

PLAT
of
AN ISLAND IN
SECS. 14, 15 AND 22, T. 4 S. R. 13 W. MICH. MER.
MICHIGAN.

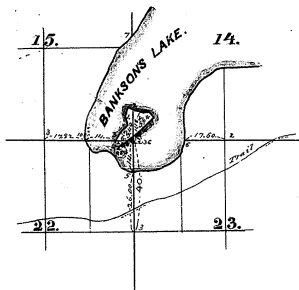

Variation 3° East.
Scale 40 Chains to an inch.

Department of the Interior,
General Land Office,
Washington, D.C. March 17, 1883.

I hereby certify that the above plat of an Island in Secs. 14, 15, & 22, T. 4 S. R. 13 W. Mich. Mer. Michigan, is a correct plat of a survey executed by J. C. Braidt, Deputy Surveyor under a contract with the Commissioner of the General Land Office; bearing date Oct. 28, 1882. and is strictly conformable to the field notes thereof on file in this office, which have been examined and approved.

A. G. M. Garland
Commissioner and
Ex-Officio Sur. Genl. of Michigan.

2-51-2

3-4

2-15-2

Original

PLAT
OF
AN ISLAND IN
SECS. 14, 15 AND 22, T. 4 S. R. 13 W. Mon. Mer.
MICHIGAN.

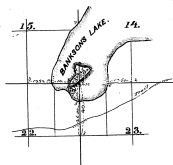

Meridian 3° East.
Scale 40 Chains to an Inch.

Department of the Interior,
General Land Office,
Washington, D.C. March 17, 1883.

I hereby certify that the above plat of an island in Secs. 14, 15, & 22, T. 4 S. R. 13 W. Mon. Mer. Michigan, is a correct plat of survey executed by W. C. Brewster, Deputy Surveyor under a contract with the Commissioner of the General Land Office; bearing date Oct. 25, 1882, and is strictly conformable to the field notes thereof on file in this office, which have been examined and approved.

A. M. Fairland
Commissioner and
Ex. Officer Gen. Land Office Michigan.