

Re-survey  
Township N<sup>o</sup> 24 N Range N<sup>o</sup> 10 W Mer.

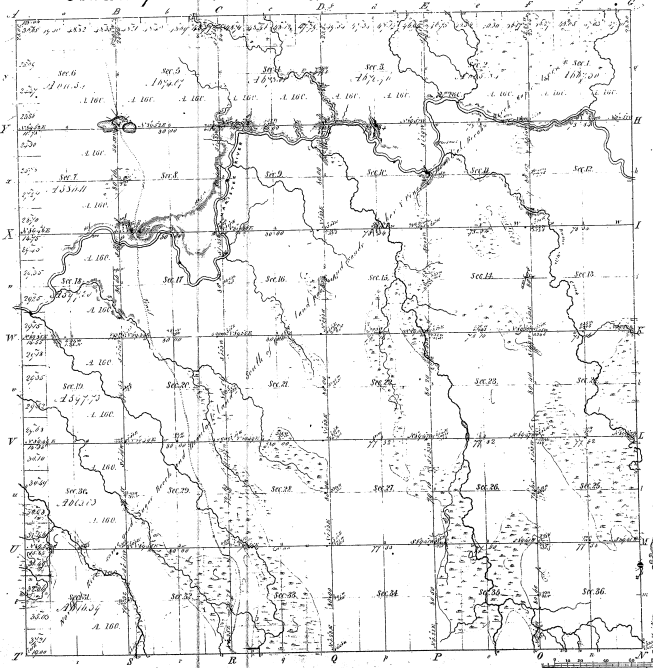

Standard of  
Plate Corner 1848 Plate Corner 1848 Plate Corner 1848

16-27

16-27

Total number of Acres 22663.24

Survey Description	By Whom Surveyed	Date of Concl <sup>d</sup>	Amount of Survey	When Surveyed	Range and Mer.
Township Area	John Deane	Nov. 12, 1853	16,500	1853	
Subdivisions	Lot division	Nov. 12, 1852	59,22.07	8 <sup>th</sup> Quarter 1852	

The above Map of Township N<sup>o</sup> 24 North of Range N<sup>o</sup> 10 West of the Principal Meridian of Michigan is a truly and correctly made & the field notes of the survey being on file in the office which have been examined and approved  
Surveyor General's Office  
Edwards August 11, 1863

*Severus Chapman*  
Surveyor General