

REMONUMENTATION

FEB 22 1996

COMMISSION

ALCONA COUNTY REMONUMENTATION
LAND CORNER RECORDATION CERTIFICATE
Filing Requirement of Act 74, Mich. P.A. 1970

Alcona County
Remonumentation
Liber 1 Page 142

For corners in

ALCONA (County)	Located In:	Corner Code #
1. Public Land Survey	T 25N R 7E	C-1
	T R	
	T R	
	T R	
2. Property Controlling in Section	S T R	
	S T R	
3. Miscellaneous Property in Sec.	S T R	
	S T R	

APPROVED LAND CORNER
P A 345 of 1990
ALCONA COUNTY

Date
County Rep E.L.L.

RECORDED

DEC 20 4 34 PM '95

Doris A. Smith
REGISTER OF DEEDS
ALCONA COUNTY MICHIGAN

Register of Deeds Stamp & File Number

4. Lot No. _____, Recorded Plat _____
5. Private Claims _____

I, WILLIAM E. WOODS, in a field survey on 12-12-, 19 95 do hereby state that under requirements of P.A. 74, Michigan P.A. of 1970, the corner points mentioned in lines 1 and 2 above were in conformance with regulations and rules therefore as required in the current manual of survey instructions of the United States Department of the Interior, Bureau of Land Management or by a decree of a Court of Law and /or that the corner points mentioned in lines 3, 4 and 5 above were in conformance with the rules of the Michigan Board of Land Surveyors or by a Decree of a Court of Law; established, re-established, monumented, recovered, found as expressed below:

NOTE: Not more than 2 corners, all in the same town and range, may be recorded on this certificate.

	A	B	C	D	E	F	G	H	I	J	K	L	M
1													
2	6		5		4		3		2		1		
3													
4	7		8		9		10		11		12		
5													
6	18		17		16		15		14		13		
7													
8	19		20		21		22		23		24		
9													
10	30		29		28		27		26		25		
11													
12	31		32		33		34		35		36		
13													

A. Description of original monument and accessories and/or subsequent restoration:

1844: JAMES MULLETT SET POST
18 LK W. OF POST
W.PINE 24" S59°E 25
Y.PINE 20" S35°W 20

B. Description of corner evidence found and/or method applied in restoring or reestablishing corner:

1928: INDEPENDENT RESURVEY ESTABLISHED CORNER. SET AN IRON POST 3 FT.
LONG 2" IN DIAMETER WITH BRASS CAP.
W.OAK 6" S85°45'W., 104 LKS. DIST., MKD.
T25N R7E S 6 C C B T.

C. Description of monument for corner and accessories established to perpetuate locating the position of the corner:

1995: REMONUMENTATION, WILLIAM E. WOODS P.S. 25882
TO USE BRASS CAP SET BY INDEPENDENT RE SURVEY.
28" WHITE OAK S84°W 31.97 20" TWIN WHITE OAK S37°W 29.58
14" TWIN MAPLE S15°E 12.71 36" OAK N76°E 53.89

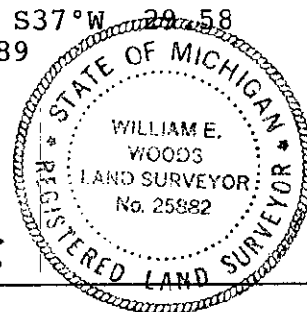

Signed by William E Woods
Surveyor's Michigan License No. 25882

Date 12-20-95