

FEB 07 2001

2000 Alcona County Remonumentation

LAND CORNER RECORDATION CERTIFICATE
 Filing Requirement of Act 74, Mich. P.A. 1970

SECTION
 Alcona County
 Remonumentation
 Liber 2 Page 85

For corners in Alcona Located In: _____ Corner Code # _____
 (County)

- | | | |
|------------------------------------|-------------------|-------|
| 1. Public Land Survey | T 25NR 09E | A-5 |
| | T 25NR 08E | M-5 ✓ |
| | T ___ R ___ | _____ |
| | T ___ R ___ | _____ |
| 2. Property Controlling In Section | S ___ T ___ R ___ | _____ |
| | S ___ T ___ R ___ | _____ |
| 3. Miscellaneous Property in Sec. | S ___ T ___ R ___ | _____ |
| | S ___ T ___ R ___ | _____ |

Filed for Record in
 ALCONA COUNTY MICHIGAN
 DORIS A GAUTHIER
 On 09-20-2000 At 09:54 am.
 LAND CORNER 9.00

Register of Deeds Stamp & File Number

4. Lot No. _____, Recorded Plat _____
 5. Private Claims _____

I, Wayne T. Lewis, in a field survey on 3-30-2000, 19____ do hereby state that under requirements of P.A. 74, Michigan P.A. of 1970, the corner points mentioned in lines 1 and 2 above were in conformance with regulations and rules therefore as required in the current manual of survey instructions of the United States Department of the Interior, Bureau of Land Management or by a decree of a Court of Law and/or that the corner points mentioned in lines 3, 4 and 5 above were in conformance with the rules of the Michigan Board of Land Surveyors or by a Decree of a Court of Law; established, re-established, monumented, recovered, found as expressed below:

NOTE: Not more than 2 corners, all in the same town and range, may be recorded on this certificate.

	A	B	C	D	E	F	G	H	I	J	K	L	M
1													
2	6		5		4		3		2		1		
3													
4	7		8		9		10		11		12		
5													
6	10		17		16		15		14		13		
7													
8	19		20		21		22		23		24		
9													
10	30		29		28		27		26		25		
11													
12	31		32		33		34		35		36		
13													

A. Description of original monument and accessories and/or subsequent restoration:

- 1838 - Lewis Clason: Set post and witnessed
- 1902 - E. Chapelle, C.S.: Found post, no witnesses given
- 1977 - John F. Oliver, P.S.: Found 1/2" iron pipe, and recorded LCRC (L 1, P 45), and witnessed
- 1996 - Northeast Land Surveys (Bill Woods, P.S.): Found 1/2" bar and cap N.E.L.S., no witnesses given

APPROVED LAND CORNER
 P A 345 of 1990
 ALCONA COUNTY
 Date 9-6-2000
 County Rep. W.T.L.

B. Description of corner evidence found and/or method applied in restoring or reestablishing corner:

Found N.E.L.S. cap #25882 on c/l of Wissmiller Rd. and 6' West of Barlow Rd.

This corner position is accepted as a careful and faithful perpetuation of the position of the original corner.

C. Description of monument for corner and accessories established to perpetuate locating the position of the corner:

2000 - Placed 3" Alcona County cap, stamped to identify the corner, on existing 1/2" rerod in mon. box

Witnesses:

- N 45° E 36.42' . Set 1/2" rerod
- S 55° E 77.82' Power Pole (set tag #41922)
- S 35° E 79.94' 6" White Birch (set tag #41922)
- N 15° W 107.26' 12" Balsam Poplar (set tag #41922)

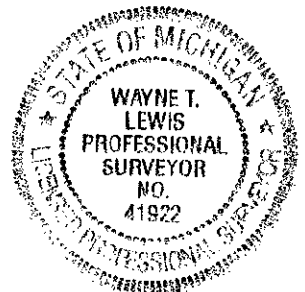

Signed by [Signature]
 Surveyor's Michigan License No. 41922

Date September 14, 2000