

2000 Alcona County Remonumentation

LAND CORNER RECORDATION CERTIFICATE
Filing Requirement of Act 74, Mich. P.A. 1970

For corners in
Alcona

(County)

Located In:

Corner Code #

1. Public Land Survey

T 25N R 09E B-5 ✓

T R

T R

T R

2. Property Controlling
in Section

S T R

S T R

3. Miscellaneous
Property in Sec.

S T R

S T R

Alcona County
Remonumentation
Liber 2 Page 94

Filed for Record in
ALCONA COUNTY MICHIGAN
DORIS A GAUTHIER
On 09-20-2000 At 09:54 am.
LAND CORNER 9.00

Register of Deeds Stamp & File Number

4. Lot No. _____, Recorded Plat _____

5. Private Claims _____

I, Wayne T. Lewis, in a field survey on 3-30-2000, 19__ do hereby state that under requirements of P.A. 74, Michigan P.A. of 1970, the corner points mentioned in lines 1 and 2 above were in conformance with regulations and rules therefore as required in the current manual of survey instructions of the United States Department of the Interior, Bureau of Land Management or by a decree of a Court of Law and/or that the corner points mentioned in lines 3, 4 and 5 above were in conformance with the rules of the Michigan Board of Land Surveyors or by a Decree of a Court of Law; established, re-established, monumented, recovered, found as expressed below:

NOTE: Not more than 2 corners, all in the same town and range, may be recorded on this certificate.

1	A	B	C	D	E	F	G	H	I	J	K	L	M
2		6		5		4		3		2		1	
3													
4		7		8		9		10		11		12	
5													
6		18		17		16		15		14		13	
7													
8		19		20		21		22		23		24	
9													
10		30		29		28		27		26		25	
11													
12		31		32		33		34		35		36	
13													

A. Description of original monument and accessories and/or subsequent restoration:

- 1843 - James A. Mullet: Set post and witnessed
- 1903 - County Surveyor: Found post, no witnesses given
- 1977 - John F. Oliver, P.S.: Found 1" iron pipe, and recorded LCRC (L 1, P 49) and witnessed
- 1996 - Northeast Land Surveys (Bill Woods, P.S.): Found 3/4" pipe and raised with 1/2" bar, no witnesses given

APPROVED LAND CORNER
P A 345 of 1990
ALCONA COUNTY

Date 9-6-2000
County Rep. Wayne T. Lewis

B. Description of corner evidence found and/or method applied in restoring or reestablishing corner:

Found 1/2" rerod, 3' North of c/l of Wissmiller Rd. and in line w/fence to the South

This corner position is accepted as a careful and faithful perpetuation of the position of the original corner.

C. Description of monument for corner and accessories established to perpetuate locating the position of the corner:

2000 - Placed 3" Alcona County cap, stamped to identify the corner, on existing 1/2" rerod in mon. box

Witnesses:

- S 75° E 185.07' 35" Maple (set tag #41922)
- S 35° W 94.71' Power Pole (set tag #41922)
- N 65° W 77.10' 15" Poplar (set tag #41922)
- N 50° W 78.37' 26" Maple (set tag #41922, exist. Spike, 0.4' back from tag)

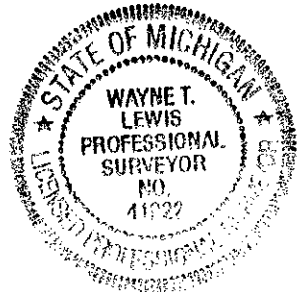

Signed by Wayne T. Lewis
Surveyor's Michigan License No. 41922

Date September 14, 2000

SURVEY &
REMONUMENTATION

FEB 07 2001

SECTION