

1998 Alcona County Remonumentation

LAND CORNER RECORDATION CERTIFICATE
Filing Requirement of Act 74, Mich. P.A. 1970

Alcona County
Remonumentation
Liber 1 Page 286

Filed for Record in
ALCONA COUNTY MICHIGAN
DORIS A GAUTHIER
On 11-05-1998 At 04:38:09 pm.
LAND CORNER 9.00
OR

For corners in
Alcona
(County)

Located In: Corner Code #

1. Public Land Survey T 26NR 09E F-11
T R
T R
T R

2. Property Controlling
in Section S T R
S T R

3. Miscellaneous
Property in Sec. S T R
S T R

4. Lot No. _____, Recorded Plat _____

5. Private Claims _____

APPROVED LAND CORNER
P A 345 of 1990
ALCONA COUNTY
Date 10/28/98
County Rep Det. B. Lee
Register of Deeds Stamp & File Number

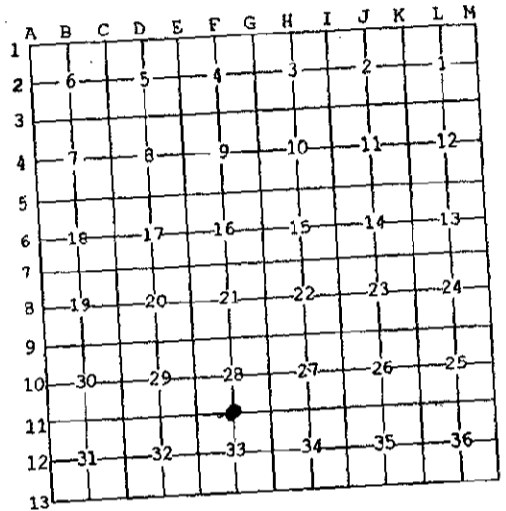

I, Wayne T. Lewis, in a field survey on 7-29, 19 98 do hereby state that under requirements of P.A. 74, Michigan P.A. of 1970, the corner points mentioned in lines 1 and 2 above were in conformance with regulations and rules therefore as required in the current manual of survey instructions of the United States Department of the Interior, Bureau of Land Management or by a decree of a Court of Law and /or that the corner points mentioned in lines 3, 4 and 5 above were in conformance with the rules of the Michigan Board of Land Surveyors or by a Decree of a Court of Law; established, re-established, monumented, recovered, found as expressed below:

NOTE: Not more than 2 corners, all in the same town and range, may be recorded on this certificate.

A. Description of original monument and accessories and/or subsequent restoration:

- 1843: J. MULLET - SET POST AND WITNESSED
- 1908: EDWARD CHAPPELLE - FOUND CORNER AND ORIGINAL WITNESSES
- 1994: NORTHEAST LAND SURVEYS (BILL WOODS, P.S. AND JOHN OLIVER, P.S.) - FOUND 3" PIPE AND RECORDED SURVEY, NO WITNESSES GIVEN

SURVEY &
REMONUMENTATION

NOV 25 1998

B. Description of corner evidence found and/or method applied in restoring or reestablishing corner:

SECTION

FOUND 3" PIPE, W/1" PIPE INSIDE, IN LINE WITH FENCE TO THE NORTH AND EAST/WEST ROAD C/L

THIS CORNER POSITION IS ACCEPTED AS A CAREFUL AND FAITHFUL PERPETUATION OF THE POSITION OF THE ORIGINAL CORNER.

C. Description of monument for corner and accessories established to perpetuate locating the position of the corner:

1998: PLACED 3" ALCONA COUNTY CAP, STAMPED TO IDENTIFY THE CORNER, OVER 1/2" REDD INSIDE EXISTING 1" PIPE

- WITNESSES:
- S 65° W 62.74' 6" MAPLE
 - N 40° W 38.02' POWER POLE (TAG "WITNESS TAG")
 - NORTH 34.33' FENCE CORNER
 - N 30° E 36.84' GATE POST

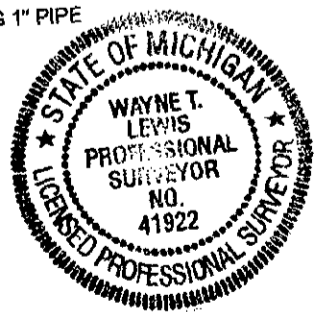

Signed by Wayne T. Lewis
Surveyor's Michigan License No. 41922

Date November 2, 1998