

FEB 07 2001

LAND CORNER RECORDATION CERTIFICATE

SECTION

FILING REQUIREMENT OF ACT 74, MICH. P.A.1970

2000 Alcona County Remonumentation

FOR CORNERS OF--:	LOCATED IN--:	CORNER CODE NUMBER
1. PUBLIC LAND SURVEY	T. <u>27N</u> N. S., R. <u>8E</u> E. W.	<u>F-11</u> ✓
2. PROPERTY CONTROLLING IN SECTION	, T. _____ N. S., R. _____ E. W.	_____
3. MISCELLANEOUS PROPERTY IN SECTION	, T. _____ N. S., R. _____ E. W.	_____
4. LOT NO. _____, RECORDED PLAT _____		
5. PRIVATE CLAIMS _____		

Alcona County Remonumentation Liber 2 Page 67

Filed for Record in ALCONA COUNTY MICHIGAN DORIS A GAUTHIER On 09-20-2000 At 09:36 am. LAND CORNER 9.00

REGISTER OF DEEDS STAMP AND FILING NUMBER

I, John F. Oliver do hereby certify that under requirements of P.A. 74, Michigan P.A. of 1970, the corner points mentioned in lines 1 and 2 above (identified with circles on index code diagram - over) were, in a field survey on Aug. 10, 2000, established, re-established, monumented, re-monumented, recovered or restored as expressed below and in conformance with regulations and rules therefore as required in the current manual of survey instructions of the United States Department of the Interior, Bureau of Land Management or by a decree of a court of law. Furthermore, that the corner points mentioned in lines 3, 4 and 5 above were, in a field survey on _____ 19____, found, recovered, restored, established or re-established as expressed below and in conformance with the rules of the Michigan State Board of Registration for Land Surveyors or, by a Decree of a Court of law:

A. Description of original monument and accessories and/or subsequent restoration:

- F-11: 1838: GLO survey by L. Clason - set post and referenced
- 1906: sur. by E. Chapelle - no description of corner
- 1912: sur. by A. Freer - cor. is cedar stake 4 x 4
- 1979: sur. by Scott Eng. - existing nail
- 1993: sur. by Scott Eng. - existing nail
- 1993: sur. by NE sur - corner not identified

B. Description of corner evidence found and/or method applied in restoring or re-establishing corner:

F-11: found PK nail with nothing under

no evidence recovered from GLO survey of 1838

previous witnesses from 1979 Scott Eng. survey verify location for the corner. distances and alignment are compatable with surveys of 1993.

accepted as the correct location for the corner

C. Description of monument for corner and accessories established to perpetuate locating the position of the corner:

F-11: placed pavement box with 1/2" rod and brass cap referenced:

- 7" maple - North - 49.61 ft
- 10" maple - S 45°W - 59.30 ft
- 11" maple - S 52°W - 59.29 ft
- 8" maple - S 45°E - 82.62 ft
- 5" w. pine - N 57°E - 51.90 ft

APPROVED LAND CORNER P A 345 of 1990 ALCONA COUNTY Date 7-6-2000 County Rep. [Signature]

SIGNED BY [Signature] DATE Aug. 10, 2000
John F. Oliver
SURVEYOR'S MICHIGAN REGISTRATION NO. 19840

FOR STATE AND UNITED STATES AGENCIES:

SIGNED BY _____ DATE _____
CHIEF OF SURVEY PARTY
APPROVED AND SIGNED BY _____ DATE _____
MICHIGAN REGISTERED LAND SURVEYOR

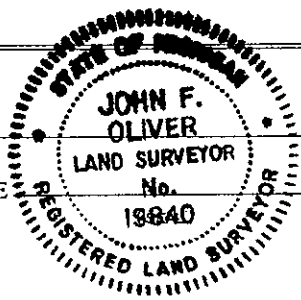

SURVEYOR'S MICHIGAN REGISTRATION NO. _____