

**SURVEY
REMONUMENTATION**

APR 29 1999

SECTION

**ALLEGAN COUNTY REMONUMENTATION
LAND CORNER RECORDATION CERTIFICATE
FILING REQUIREMENT OF ACT 74, MICH. P. A. 1970**

LIBR0007 PAGE 214

FOR CORNERS IN:	LOCATED IN:	CORNER CODE #
ALLEGAN COUNTY		
1. Public Land Survey	T. 1N R. 12W	L-13
S. 1/4 COR. COMMON TO SECTION 36 OTSEGO TOWNSHIP	T. R.
	T. R.
	T. R.
2. Property Controlling in section	S. T. R.
	S. T. R.
3. Miscellaneous Property in Sec.	S. T. R.
4. Lot No., Recorded Plat.		
5. Private Claims.		

FILED

1/28/1999 2:44:39 PM

JOYCE A. WATTS
REGISTER OF DEEDS
ALLEGAN COUNTY, MICH

REGISTER OF DEEDS STAMP & FILE NUMBER

	A	B	C	D	E	F	G	H	I	J	K	L	M
2	8	5	4	3	2	1							
3													
4	7	6	9	10	11	12							
5													
6	18	17	16	15	14	13							
7													
8	19	20	21	22	23	24							
9													
10	30	29	28	27	26	25							
11													
12	31	32	33	34	35	36							
13													

I, Raymond Moored in a field survey on Sept. 23, 1998 do hereby state that under requirements of P.A 74, Michigan P.A of 1970, corner points mentioned in lines 1 and 2 above were in conformance with regulations and rules therefore as required in the current manual of survey instructions of the United States Department of the Interior Bureau of Land management or by a decree of a Court of Law and/or that the corner points mentioned in the lines 3, 4, and 5 above were in conformance with the rules of the Michigan Board of Land Surveyors or by a Decree of a Court of Law established, monumented, recovered, found as expressed below.

Note: Not more than 2 corners, all the same town and range, may be recorded on this certificate.

A. Description of original monument and accessories and/or subsequent restoration:

- G.L.O. 40.00 SET QR SEC POST, BEECH 18 N64E 16, BEECH 10 N20W 30
- COUNTY SURVEYOR RECORDS, J.W. HICKS, DATED: 02-09-1870
DISTANCE BETWEEN S 1/4 & NW COR OF SEC. 1 ALAMO IS 13.75 CH
DISTANCE BETWEEN S 1/4 & SE COR OF SEC. 36 OTSEGO IS 39.86 (2630.76)
- RATEKIN, SECTION CARD INFORMATION
SMALL STONE IN FENCE
20" APPLE-N67°W-62.85'
7" APPLE-N46°W-80.19'
DISTANCE BETWEEN S 1/4 COR. SEC. 36 OTSEGO & NW COR. OF SEC. 1 ALAMO IS 306.01
DISTANCE BETWEEN NW COR. SEC. 1 ALAMO & SE COR. OF SEC. 36 OTSEGO IS 2324.50
- M-DOT RIGHT OF WAY MAP
DISTANCE BETWEEN S 1/4 COR. SEC. 36 OTSEGO & NW COR. OF SEC. 1 ALAMO IS 306.01
DISTANCE BETWEEN NW COR. SEC. 1 ALAMO & SE COR. OF SEC. 36 OTSEGO IS 2324.50
1/2 MILE = 2630.51'

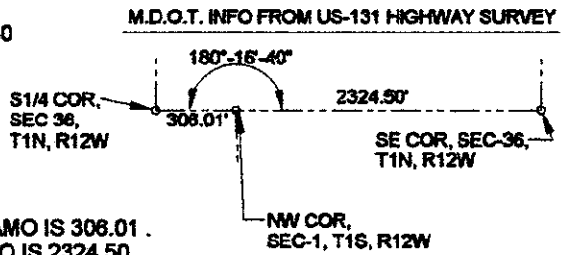

APPROVED REMONUMENTATION CORNER
P.A. 345 OF 1990
ALLEGAN COUNTY
DATE APPROVED Nov. 24, 1998
COUNTY REP. [Signature]

B. Description of corner evidence found and/or method applied in restoring or reestablishing corner:

FOUND NO EVIDENCE OF ORIGINAL CORNER OR SUBSEQUENT RESTORATION.
ESTABLISHED CORNER POSITION 306.01' WEST OF NW COR., SEC. 1 ALAMO PER MDOT INFO

SET 3/4" x 24" ALLEGAN COUNTY REMONUMENTATION IRON WITH CAP.
THIS POSITION ACCEPTED AS A CAREFUL AND FAITHFUL REESTABLISHMENT OF THE POSITION OF THE ORIGINAL CORNER.
APPROVED BY ALLEGAN COUNTY REMONUMENTATION PEER GROUP ON NOV. 24, 1998

TOTAL ON ROAD TRAVERSING= 2340.40'
TOTAL OFF ROAD TRAVERSING= 2920.09'

C. Description of monument for corner and accessories established to perpetuate locating the position of the corner:

- SET STANDARD ALLEGAN COUNTY REMONUMENTATION IRON WITH CAP
- NAIL & TAG IN N SIDE 9" TW ELM S70°W 5.44'
 - NAIL & TAG IN N SIDE 6" TW ELM N85°E 17.83'
 - NAIL & TAG IN E SIDE 6" OAK SOUTH 3.69'
 - NAIL & TAG IN N SIDE 6" OAK S60°W 7.81'
 - IN EAST AND WEST FENCE LINE

Raymond Moored

Date 12/16/98

Surveyors License No. 26463

