

LAND CORNER RECORDATION CERTIFICATE
Filing Requirement of Act 74, Mich. P.A. 1970

For corners in

Allegan County <small>(County)</small>	Located In:	Corner Code //
1. Public Land Survey	T 1N R 12W T 1N R 12W T R T R	A-6 A-7
2. Property Controlling in Section	S T R S T R	
3. Miscellaneous Property in Sec.	S T R S T R	
4. Lot No. _____, Recorded Plat _____		
5. Private Claims _____		

Register of Deeds Stamp & File Number

Gary C. Bilow March 6, 1990

I, _____, in a field survey on _____, do hereby certify that under requirements of P.A. 74, Michigan P.A. of 1970, the corner points mentioned in lines 1 and 2 above were in conformance with regulations and rules therefore as required in the current manual of survey instructions of the United States Department of the Interior, Bureau of Land Management or by a decree of a Court of Law and/or that the corner points mentioned in lines 3, 4 and 5 above were in conformance with the rules of the Michigan Board of Land Surveyors or by a Decree of a Court of Law, established, re-established, monumented, re-monumented, recovered, found as expressed below:

NOTE: Not more than 4 corners, all in the same town and range, may be recorded on this certificate.

A	B	C	D	E	F	G	H	I	J	K	L	M
2	6	5	4	3	2	1						
3												
4	7	8	9	10	11	12						
5												
6	18	17	16	15	14	13						
7												
8	19	20	21	22	23	24						
9												
10	30	29	28	27	26	25						
11												
12	31	32	33	34	35	36						
13												

A. Description of original monument and accessories and/or subsequent restoration:

(A-6) Corner not set in original survey. Monumented 1885 by Allegan County Surveyor, J.W. Hicks who set "long stone near 3' in length point up and a X on top at corner".

(A-7) Corner perpetuated CA. 1885 by Allegan County Surveyor who set "stone about 20" long broken alittle on S. edge". County surveyor records do not mention GLO monument or accessories. Corner recorded by D. A. Ratekin, 1973 as set 1/2" iron with cap on old fence line east and fence line to south.

B. Description of corner evidence found and/or method applied in restoring or reestablishing corner:

(A-6) Found newer wire fence going east from corner location with remains of much older wire fence at its base. Traced fence to 600'± east of corner location and conclude that newer fence represents location of older. Projected fence line westerly to intersection with range line. This position falls 1.5' N of a point equidistant between A-5 and A-7. Excavated 3'x3'x1.5' deep hole at this position and found nothing. Accepted fence line as perpetuation of old county surveyor monument and set 1/2"x36" long re-rod encased in 4" dia. concrete cylinder with cast aluminum Mich. Dept. of Natural Resources cap on the range line at its intersection with the westerly projection of fence line.

(A-7) ~~Re-established~~ found and accepted 1/2" re-rod with cap # 8781 5" below gravel surface. Ratekin's road calls check. Other accessories not found. Distance A-7 to B-7 checks well with distant shown on survey Rec. L. 828 - p.406.

C. Description of monument for corner and accessories established to perpetuate locating the position of the corner:

(A-6) Set 4' dia. concrete monument with MDNR cap 8" below gravel surface N40°E 32.56' Set nail and MDNR tag in W. face 13" locust South 35.70' Found 1/2" iron and cap # 8781 at E 1/4 Cor. Sec.13 T1N - R13W S60°W 23.70' Set nail & MDNR tag in N. Face 8" Locust N60°W 35.46' Set nail & MDNR tag in S. Face 32" Walnut	(A-7) Found 1/2" iron with cap # 8781 South 50.81' found iron bar at SE cor. Sec. 13 T1N-R13W N73°E 31.67' Set nail and MDNR tag NW Face 8" Locust N20°E 51.12' set nail and MDNR tag E. Face 8" Locust N24°W 64.82' set nail and MDNR tag NW Face 18" Maple Determined to be 0.11' east of range line.
--------------------------------------------------------------------------------------------------------------------------------------------------------------------------------------------------------------------------------------------------------------------------------------------------------------------------------------------	------------------------------------------------------------------------------------------------------------------------------------------------------------------------------------------------------------------------------------------------------------------------------------------------------------------------------------

Signed by Gary C. Bilow
 Surveyor's Michigan License No. 26453

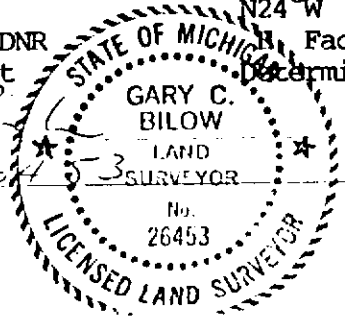

Date 11/16/90