

LAND CORNER RECORDATION CERTIFICATE
Filing Requirement of Act 74, Mich. P.A. 1970

For corners in

<u>Allegan County</u> <small>(County)</small>	Located In:	Corner Code <u>##</u>
1. Public Land Survey	T 1N R 12W T 1N R 12W T _____ R _____ T _____ R _____	M-8 K-9 _____ _____
2. Property Controlling in Section	S _____ T _____ R _____ S _____ T _____ R _____	_____ _____
3. Miscellaneous Property in Sec.	S _____ T _____ R _____ S _____ T _____ R _____	_____ _____
4. Lot No. _____, Recorded Plat _____		
5. Private Claims _____		

Register of Deeds Stamp & File Number

I, Gary C. Bilow, in a field survey on March 6, 1990, do hereby certify that under requirements of P.A. 74, Michigan P.A. of 1970, the corner points mentioned in lines 1 and 2 above were in conformance with regulations and rules therefore as required in the current manual of survey instructions of the United States Department of the Interior, Bureau of Land Management or by a decree of a Court of Law and/or that the corner points mentioned in lines 3, 4 and 5 above were in conformance with the rules of the Michigan Board of Land Surveyors or by a Decree of a Court of Law; established, re-established, monumented, re-monumented, recovered, found as expressed below:

NOTE: Not more than 4 corners, all in the same town and range, may be recorded on this certificate.

A	B	C	D	E	F	G	H	I	J	K	L	M
2	6	5	4	3	2	1						
3												
4	7	8	9	10	11	12						
5												
6	18	17	16	15	14	13						
7												
8	19	20	21	22	23	24						
9												
10	30	29	28	27	26	25						
11												
12	31	32	33	34	35	36						
13												

A. Description of original monument and accessories and/or subsequent restoration:

(M-8) John Mullet, Deputy Surveyor, set wood post for original monument, 1826. Accessories: W.Oak 14" N26 1/2°W, 39.60', W. Oak 12" S80 1/2°W, 5.94'. Corner shown on map by W.G. Fargo, Engineer, Ca. 1900 of flowage of the then proposed Plainwell Dam and of parcels eventually acquired by the power company operating the dam. No monument type or accessories specified. Corner also referred to in description on deed Rec. L.126 - P. 234, Allegan County records, dated 1902 which also notes accessories to the P.O.B. 515 feet South of corner.

(K-9) Corner recorded by Donald A. Ratekin, RLS 8781, June, 1971 as found stone with "x" on top. Accessories noted on L.C.R.C. L.1 - P4.

B. Description of corner evidence found and/or method applied in restoring or reestablishing corner:

(M-8) No monumentation or accessories recovered. Accessories noted in deed not found. Found N-S wire fence along range line which runs from Miller Road South to the Kalamazoo River but no acceptable evidence of latitudinal position of corner recovered. Accepted fence as evidence of old corner location and set monument in fence equidistant from M-7 (Rec. L.2 - P.249) and M-9 (Rec. L.3 - P.188). From this position, distance South to top of Northerly bank of Kalamazoo River matches well with distance call of 880' from deed above. Monument is 0.6' west of straight line between M-7 and M-9.

(K-9) Found and accepted stone with "x" on top 1.4' below ground surface and placed 1" pipe with cap # 26453 above "x". Three remaining accessories by Ratekin check as noted below.

C. Description of monument for corner and accessories established to perpetuate locating the position of the corner:

(M-8) Set 1/2" re-rod encased in 4" dia. concrete cylinder capped with cast aluminum Michigan Department of Natural resources tablet.

N10°E 18.12' Set nail and MDNR tag in W. Face 3" Oak
 S55°E 2.12' Set nail and MDNR tag in NE Face 4" Oak
 South 14.46' Set nail and MDNR tag in W. Face 10" Juniper

South 515.00 4" Dia. concrete monument with aluminum DNR cap on east line of Sec. 24.

(K-9) Set 1" pipe with cap # 26453 above found stone.
 East 0.9' corner fence post
 S20°E 6.2' Twin Sassafras
 East 13.85' Corner fence post
 S62°W 2.65' Set nail and MDNR tag in 3" Sassafras

Signed by Gary C. Bilow
 Surveyor's Michigan License No. 26453

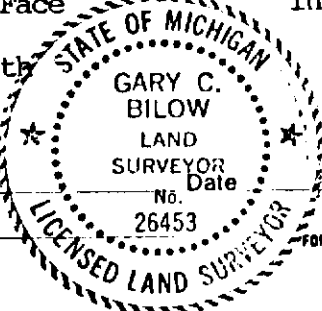

FORM APPROVED BY MICHIGAN STATE BOARD OF LAND SURVEYORS, JAN. 28, 1971
 REVISED MAY 14, 1975
 REVISED JAN., 1983