

ALLEGAN COUNTY REMONUMENTATION  
LAND CORNER RECORDATION CERTIFICATE  
Filing Requirement of Act 74, Mich. P.A. 1970

For Corners in  
ALLEGAN (County)

Located in: Corner Code 44

- 1. Public Land Survey T 1N R 14W L-3 (S 1/4, 1)  
T \_\_\_ R \_\_\_ CHESHIRE TWP.  
T \_\_\_ R \_\_\_  
T \_\_\_ R \_\_\_
- 2. Property Controlling S \_\_\_ T \_\_\_ R \_\_\_  
in Section S \_\_\_ T \_\_\_ R \_\_\_
- 3. Miscellaneous S \_\_\_ T \_\_\_ R \_\_\_  
Property in Sec. S \_\_\_ T \_\_\_ R \_\_\_

Register of Deeds Stamp & File Number

1994 JAN -5 PM 4: 02  
Singer  
REGISTER OF DEEDS  
ALLEGAN COUNTY, MICH.

FILED

- 4. Lot No. \_\_\_\_\_, Recorded Plat \_\_\_\_\_
- 5. Private Claims \_\_\_\_\_

	A	B	C	D	E	F	G	H	I	J	K	L	M
2	6	5	4	3	2	1							
3													
4	7	8	9	10	11	12							
5													
6	13	17	16	15	14	13							
7													
8	19	20	21	22	23	24							
9													
10	30	29	28	27	26	25							
11													
12	31	32	33	34	35	36							
13													

I, BASIL ADDRESS, in a field survey on DECEMBER 30, 19 93, do hereby certify that under requirements of P.A. 74, Michigan P.A. of 1970, the corner points mentioned in lines 1 and 2 above were in conformance with regulations and rules therefore as required in the current manual of survey instructions of the United States Department of the Interior, Bureau of Land Management or by a decree of a Court of Law and/or that the corner points mentioned in lines 3, 4 and 5 above were in conformance with the rules of the Michigan Board of Land Surveyors or by a Decree of a Court of Law, established, re-established, monumented, re-monumented, recovered, found as expressed below:

NOTE: Not more than 4 corners, all in the same town and range, may be recorded on this certificate.

- A. Description of original monument and accessories and/or subsequent restoration:  
G.L.O. - WEST CORRECT LINE BETWEEN SECTIONS 1 & 12 39.75 CHS. (2623.50')  
WITNESSES: PEPPERAGE 16 S 53 E 18 LKS. (11.88')  
BEECH 6 N 40 W 6 LKS. (3.96')  
OLD COUNTY SURVEYOR'S NOTES: STONE- MEAS. 2646' NORTH TO CENTER  
WITNESSES: ST SIGN NW 28.8'  
12" LOCUST NE 54.3'  
30" OAK ENE 100.4'  
30" OAK SW 78.3'  
25" APPLE NW 38.9'

(CONTINUED ON BACK OF CERTIFICATE)

- B. Description of corner evidence found and/or method applied in restoring or reestablishing corner:  
FD. STONE W/ IRON SLANTED OVER IT.  
REMOVED IRON AND GROUTED IN A STD. ALLEGAN CO. MON. OVER STONE.  
THIS CORNER IS ACCEPTED AS A CAREFUL AND FAITHFUL PERPETUATION OF THE POSITION OF THE ORIGINAL CORNER.  
APPROVED BY THE ALLEGAN COUNTY REMONUMENTATION PEER GROUP 12-21-93.

- C. Description of monument for corner and accessories established to perpetuate locating the position of the corner:  
REMOVED IRON AND GROUTED A STD. ALLEGAN CO. MON. (3/4" IRON W/ REMON. CAP) OVER STONE.  
SW COR. HSE FND NE 122.87'  
NAIL & REMON. WASHER S SDE 12" LOCUST NW 75.77'  
NAIL & REMON. WASHER SE SDE 10" LOCUST SW 73.43'  
NAIL & REMON. WASHER NE SDE 9" ELM SE 82.63'  
NAIL & REMON. WASHER SW SDE 10" MAPLE ESE 85.41'

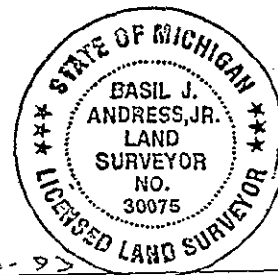

Signed by Basil Address Date 12-30-93  
Surveyor's Michigan License No. 30075

liber 4 page 357

(CONTINUED FROM FRONT OF CERTIFICATE)

A. DESCRIPTION OF ORIGINAL MONUMENT AND ACCESSORIES AND/ OR SUBSEQUENT RESTORATION.

5-18-73 - D. A. RATEKIN, C.S. (L.C.R.C., L-2, P-191)  
1/2" OVER STONE

WITNESSES: ST SIGN S 45 W 42.67'  
NW COR TEL. PED. N 40 E 53.42'  
18" LOCUST N 30 E 54.10'  
30" OAK (BOAT SPK NE SDE) 77.35'

1993 - WIGHTMAN MOORED MEAS. NORTH 2646.20' TO CENTER  
MEAS. EAST 2612.81' TO SEC COR  
ANGLE NORTH TO EAST 88-17-39