

LAND CORNER RECORDATION CERTIFICATE
Filing Requirement of Act 74, Mich. P.A. 1970

For corners in
ALLEGAN

	Located In:	Corner Code <i>≠</i>
(County)		
1. Public Land Survey	T <u>1N</u> R <u>14W</u>	<u>A3</u>
	T _____ R _____	_____
	T _____ R _____	_____
	T _____ R _____	_____
2. Property Controlling in Section	S _____ T _____ R _____	_____
	S _____ T _____ R _____	_____
3. Miscellaneous Property in Sec.	S _____ T _____ R _____	_____
	S _____ T _____ R _____	_____
4. Lot No. _____, Recorded Plat _____		
5. Private Claims _____		

Register of Deeds Stamp & File Number

I, GARY C. BILOW, in a field survey on April 10, 1991, 19_____, do hereby certify that under requirements of P.A. 74, Michigan P.A. of 1970, the corner points mentioned in lines 1 and 2 above were in conformance with regulations and rules therefore as required in the current manual of survey instructions of the United States Department of the Interior, Bureau of Land Management or by a decree of a Court of Law and/or that the corner points mentioned in lines 3, 4 and 5 above were in conformance with the rules of the Michigan Board of Land Surveyors or by a Decree of a Court of Law; established, re-established, monumented, re-monumented, recovered, found as expressed below:

NOTE: Not more than 4 corners, all in the same town and range, may be recorded on this certificate.

	A	B	C	D	E	F	G	H	I	J	K	L	M
2	6	5	4	3	2	1							
3													
4	7	8	9	10	11	12							
5													
6	18	17	16	15	14	13							
7													
8	19	20	21	22	23	24							
9													
10	30	29	28	27	26	25							
11													
12	31	32	33	34	35	36							
13													

A. Description of original monument and accessories and/or subsequent restoration:

(A-3) ORIGINAL CORNER POST ESTABLISHED BY U.S. GOVERNMENT DEPUTY SURVEYOR C. BRITIAN, 1831. ACCESSORIES: MAPLE 10 N36E 40, THORN 6 S52E 14. FALLING 15 "2.42 CH. SOUTH OF POST". CORNER SHOWN IN PERSONAL RECORD OF FORMER COUNTY SURVEYOR HUGH MacDOUGALL (NOV. 8, 1897) AS "STONE & (ILLEGIBLE) MIT".

B. Description of corner evidence found and/or method applied in restoring or reestablishing corner:

(A-3) ORIGINAL CORNER POST AND ACCESSORIES NOT RECOVERED. FOUND 1 1/4" IRON PIPE 155.79' SOUTH OF SOUTHEAST CORNER OF SECTION 1, T1N-R15W AND 4.3' EAST OF THE RANGE LINE. DID NOT SEARCH FOR STONE.

C. Description of monument for corner and accessories established to perpetuate locating the position of the corner:

(A-3) FOUND 1 1/4" IRON PIPE
 N74E 3.56' SET NAIL AND MICHIGAN
 DEPARTMENT OF NATURAL RESOURCES TAG IN
 NORTH FACE 9" HICKORY; S45W 12.06' SET
 NAIL AND MDNR TAG IN EAST FACE 8" MAPLE
 CLUMP; N10W 38.05' SET NAIL AND MDNR TAG
 IN EAST FACE POWER POLE; N05E 31.85' SET
 NAIL AND MDNR TAG IN WEST FACE 6" MAPLE;
 NORTH 110' CENTERLINE OF 110th AVENUE

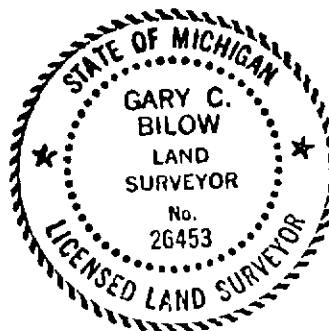

Signed by Gary C. BiLow Date 8/1/91
 Surveyor's Michigan License No. 26453

FORM APPROVED BY MICHIGAN STATE BOARD OF LAND SURVEYORS, JAN. 28, 1971
 REVISED MAY 14, 1975
 REVISED JAN., 1983