

LAND CORNER RECORDATION CERTIFICATE
Filing Requirement of Act 74, Mich. P.A. 1970

For corners in
ALLEGAN

	Located In:	Corner Code ##	
(County)			
1. Public Land Survey	T <u>1N</u> R <u>15W</u>	<u>M4</u>	
	T _____ R _____	_____	
	T _____ R _____	_____	
	T _____ R _____	_____	
2. Property Controlling in Section	S <u>2</u> T <u>1N</u> R <u>15W</u>	<u>16</u>	
	S _____ T _____ R _____	_____	
3. Miscellaneous Property in Sec.	S _____ T _____ R _____	_____	
	S _____ T _____ R _____	_____	

Register of Deeds Stamp & File Number

4. Lot No. _____, Recorded Plat _____
 5. Private Claims _____

I, GARY C. BILOW, in a field survey on April 10, 1991, 19_____, do hereby certify that under requirements of P.A. 74, Michigan P.A. of 1970, the corner points mentioned in lines 1 and 2 above were in conformance with regulations and rules therefore as required in the current manual of survey instructions of the United States Department of the Interior, Bureau of Land Management or by a decree of a Court of Law and/or that the corner points mentioned in lines 3, 4 and 5 above were in conformance with the rules of the Michigan Board of Land Surveyors or by a Decree of a Court of Law; established, re-established, monumented, re-monumented, recovered, found as expressed below:

A	B	C	D	E	F	G	H	I	J	K	L	M
2	6	5	4	3	2	1						
3												
4	7	8	9	10	11	12						
5												
6	18	17	16	15	14	13						
7												
8	19	20	21	22	23	24						
9												
10	30	29	28	27	26	25						
11												
12	31	32	33	34	35	36						
13												

NOTE: Not more than 4 corners, all in the same town and range, may be recorded on this certificate.

A. Description of original monument and accessories and/or subsequent restoration:

(M-4) ORIGINAL POST ESTABLISHED BY U.S. GOVERNMENT DEPUTY SURVEYOR L. LYON, 1831. ACCESSORIES: PINE 16 S28W 15, WHITE 10 N58W 21. WITNESSES FROM RAY MOORED, R.L.S. 26463: 20° ELM SE 49.5', 20° ELM SE 31.9', 26° W. OAK SW 40.8', FENCE POST SW 31.9', 20° BEECH NNE 65.7'. MONUMENT TYPE NOT NOTED.

(16) CORNER NOT ESTABLISHED IN ORIGINAL SURVEY. SHOWN IN PERSONAL RECORD OF FORMER ALLEGAN COUNTY SURVEYOR HUGH MacDOUGALL (ca.1900) AS "STAKE" MIDWAY BETWEEN J-3 AND K-3. NO ACCESSORIES NOTED.

B. Description of corner evidence found and/or method applied in restoring or reestablishing corner:

(M-4) ORIGINAL POST AND ACCESSORIES NOT RECOVERED. FOUND AND ACCEPTED 1 1/2" IRON PIPE 12" BELOW GROUND AND IN ACCORD WITH MOORED'S WITNESSES. RAISED TO SURFACE WITH A 1/2"x18" REBAR WITH YELLOW PLASTIC CAP STAMPED "G.C. BILOW LLS 26453". DISTANCE NORTH TO M-3 MEASURES 2641.01'.

(16) FOUND REMAINS OF OLD WIRE FENCE LINE TO NORTH MIDWAY BETWEEN J-3 AND K-3, BOTH AS REESTABLISHED AND RECORDED THIS DATE. REESTABLISHED 16 AT SOUTHERLY PROJECTION OF SAID FENCE AT ITS INTERSECTION WITH A STRAIGHT LINE BETWEEN J-3 AND K-3. MONUMENTED CORNER POSITION WITH A 1/2"x18" REBAR CAPPED WITH A YELLOW PLASTIC CAP STAMPED "G.C. BILOW LLS 26453", SET 6" BELOW GRAVEL SURFACE.

C. Description of monument for corner and accessories established to perpetuate locating the position of the corner:

(M-4) SET 1/2" REBAR WITH PLASTIC CAP
 S52W 41.07' SET NAIL AND MICHIGAN
 DEPARTMENT OF NATURAL RESOURCES TAG IN
 NORTH FACE 36" W. OAK; SOUTH 30.23'
 FOUND 1/2" IRON BAR WITH CAP #19619;
 SOUTH 6' FENCE CORNER POST; NORTH 28'
 CENTERLINE OF E-W ROAD; EASTERLY 98.5'
 WEST EDGE OF WEST HEADWALL OF BRIDGE OVER
 CREEK, SOUTH SIDE OF ROAD.

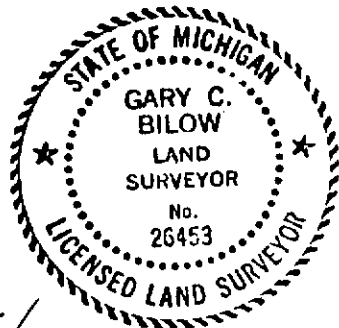

(16) SET 1/2" REBAR WITH CAP #26453
 N35E 41.99' SET NAIL AND MICHIGAN
 DEPARTMENT OF NATURAL RESOURCES TAG IN
 WEST FACE 16" TWIN OAK; N45W 49.52' SET
 NAIL AND MDNR TAG IN SW FACE 5" PINE;
 S25E 22.31' SET NAIL AND MDNR TAG IN NE
 FACE 5" OAK; S45W 20.07' SET NAIL AND
 MDNR TAG IN NW FACE 6" PINE; NORTH 2'
 CENTERLINE OF GRAVEL SURFACE OF 110th
 AVENUE.

Signed by Gary C. Bilow Date 8/1/91
 Surveyor's Michigan License No. 26453

FORM APPROVED BY MICHIGAN STATE BOARD OF LAND SURVEYORS, JAN. 28, 1971
 REVISED MAY 14, 1975
 REVISED JAN. 1983