

APR 29 1996

COMMISSION

FILED

Allegan County Remonumentation
LAND CORNER RECORDATION CERTIFICATE
Filing Requirement of Act 74, Mich. P.A. 1970

For corners in
Allegan
(County)

Located In:	Corner Code ##
T <u>2N</u> R <u>11W</u>	B-13(S1/4,31)
T _____ R _____	Martin
T _____ R _____	_____
T _____ R _____	_____
S _____ T _____ R _____	_____
S _____ T _____ R _____	_____
S _____ T _____ R _____	_____
S _____ T _____ R _____	_____

REGISTER OF DEEDS
ALLEGAN COUNTY, MICHIGAN
1995 APR 24 PM 2:20

Register of Deeds Stamp & File Number

- 4. Lot No. _____, Recorded Plat _____
- 5. Private Claims _____

	A	B	C	D	E	F	G	H	I	J	K	L	M
2	6	5	4	3	2	1							
3													
4	7	8	9	10	11	12							
5													
6	16	17	16	15	14	13							
7													
8	19	20	21	22	23	24							
9													
10	30	29	28	27	26	25							
11													
12	31	32	33	34	35	36							
13													

I, David Peabody, in a field survey on November 10, 1994, do hereby certify that under requirements of P.A. 74, Michigan P.A. of 1970, the corner points mentioned in lines 1 and 2 above were in conformance with regulations and rules therefore as required in the current manual of survey instructions of the United States Department of the Interior, Bureau of Land Management or by a decree of a Court of Law and/or that the corner points mentioned in lines 3, 4 and 5 above were in conformance with the rules of the Michigan Board of Land Surveyors or by a Decree of a Court of Law; established, re-established, monumented, re-monumented, recovered, found as expressed below:

NOTE: Not more than 4 corners, all in the same town and range, may be recorded on this certificate.

A. Description of original monument and accessories and/or subsequent restoration:

G.L.O. (set post)
W. Oak 16 N77E 294
Elm 7 N821/2W 99

County Surveyor Notes March 9, 1896 state
S 1/4 post is pieces of broken plow point
9 1/3 links North of a straight line from
corner of Section to corner of Section.
2881.51 feet from SW corner Sec.31, Martin
(record dist.)

B. Description of corner evidence found and/or method applied in restoring or reestablishing corner:

Found pieces of broken plow point
6.89' North of a straight line from corner of Section to corner of Section,
2880.52 feet distant from the SW corner Section 31, Martin Twp. (meas. dist.)

And is accepted as a careful and faithful perpetuation of the position of the original corner.

APPROVED REMONUMENTATION CORNER
P.A. 345 OF 1990
ALLEGAN COUNTY
DATE APPROVED 11-8-94
COUNTY REP. [Signature]

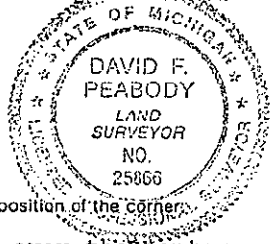

Peer Group Approved 11-08-94

C. Description of monument for corner and accessories established to perpetuate locating the position of the corner:

Placed 3/4" x 36" Iron rod with Allegan County Remon. Cap over the center of the pieces of broken plow points.
Set 20d nail w/Allegan Co. Tag in SW side quad 24" Basswood N45°W 87.82'
Set 20d nail w/Allegan Co. Tag in NE side 24" Basswood N55°W 83.72'
Set 20d nail w/Allegan Co. Tag in SE side 12" Maple S35°W 83.80'
Set 20d nail w/Allegan Co. Tag in SE side 12" Ash S15°W 106.60'
Found 1 1/4" Iron pipe as recorded in L.C.R.C. Liber 2, Pg. 129, East 15.09'
Corner is set in old road grade between pond area.

1187 0005 PAGE 169

Signed by David F. Peabody Date 1/26/95
Surveyor's Michigan License No. 25866