

**SURVEY
REMONUMENTATION**

APR 29 1999

SECTION

**ALLEGAN CO. REMONUMENTATION
LAND CORNER RECORDATION CERTIFICATE
Filing Requirement of Act 74, Mich. P.A. 1970**

LIBR0007 PAGE 111

For corners in Allegan County

<u>ALLEGAN</u> (County)	Located in:	Corner Code #
1. Public Land Survey	T-2N R-12W	C-1
	T R	NW SEC. 5
	T R	WATSON TWP
	T R	
2. Property Controlling in Section	S T R	
	S T R	
3. Miscellaneous Property in Sec.	S T R	
	S T R	
4. Lot No. _____, Recorded Plat _____		
5. Private Claims _____		

FILED
1/28/1999 2:44:39 PM
JOYCE A. WATTS
REGISTER OF DEEDS
ALLEGAN COUNTY, MICH

Register of Deeds Stamp & File Number

I, ARTHUR W. BRINTNALL, in a field survey on 27 AUG 19 98 do hereby state that under requirements of P.A. 74, Michigan P.A. of 1970, the corner points mentioned in lines 1 and 2 above were in conformance with regulations and rules therefore as required in the current manual of survey instructions of the United States Department of the Interior, Bureau of Land Management or by a decree of a Court of Law and/or that the corner points mentioned in lines 3, 4 and 5 above were in conformance with the rules of the Michigan Board of Land Surveyors or by a Decree of a Court of Law, established, re-established, monumented, recovered, found as expressed below.

NOTE: Not more than 2 corners, all in the same town and range, may be recorded on this certificate.

A	B	C	D	E	F	G	H	I	J	K	L	M
1												
2	6	5	4	3	2							
3												
4	7	8	9	10	11	12						
5												
6	18	17	16	15	14	13						
7												
8	19	20	21	22	23	24						
9												
10	30	29	28	27	26	25						
11												
12	31	32	33	34	35	36						
13												

A. Description of original monument and accessories and/or subsequent restoration:

G.L.O.
NORTH BTWN SECS 5 & 6
77.73 INTERSECT N BOUNDARY 36 LKS (23.76') W OF POST
- ELM 16 S 81 E 56
- PINE 22 S 35 W 5

APR 30, 1897 E.P. WATERMAN
NOTES SHOW PINE STAKE
- DIST E TO 1/8 POST OF 20.09
- DIST E TO N 1/4 COR OF 40.18 (2651.88)

CONT ON BACK OF CERTIFICATE

B. Description of corner evidence found and/or method applied in restoring or reestablishing corner:

FD 1 1/4" PIPE 0.61' SOUTH OF TOWN LINE PER W. M
A.C. MON EAST 23.61
44" MAPLE S 85° E 115.6'±
16" ELM S 55° W 23.5'±

SET STD A.C. MON (3/4" X 24" IRON WITH CAP) 0.61' N OF FD 1 1/4" PIPE AND IS ACCEPTED AS A CAREFUL AND FAITHFUL PERPETUATION OF THE POSITION OF THE ORIGINAL CORNER

APPROVED BY ALLEGAN PEER GROUP 11 AUG 98

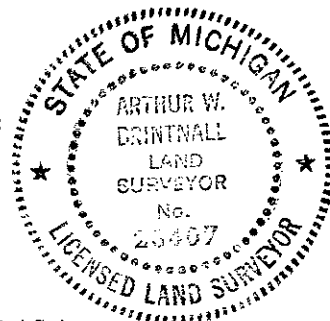

C. Description of monument for corner and accessories established to perpetuate locating the position of the corner:

STD A.C. MON (3/4" X 24" IRON WITH CAP
1 1/4" PIPE SOUTH 0.61'
NAIL & REMON TAG W SDE 24" W CHERRY S 10° E 184.17'
NAIL & REMON TAG NW ROOT 44" MAPLE S 85° E 114.41'
NAIL & REMON TAG S SDE 16" W CHERRY N 80° E 113.43'
NAIL & REMON TAG N SDE 16" ELM S 60° W 23.52'
CENTERLINE 22ND ST EAST 30'±
C-13 (T-3N, R-12W) STD A.C. MON EAST 23.76'

APPROVED REMONUMENTATION CORNER
P.A. 345 OF 1990
ALLEGAN COUNTY
DATE APPROVED AUG. 11, 1998
COUNTY REP. [Signature]

Signed by Arthur W. Brintnall
PREIN&NEWHOF
Surveyor's Michigan License No. #28407

Date SEPT 8, 1998

SURVEY
REMONUMENTATION

APR 29 1990

C-1 WATSON TWP.

A. CONTINUED

CIRCA 1965 D.A. RATEKIN, C.S.
- SURVEY FOR CONSUMER POWER CO.
- SET 1 1/4" PIPE
24" MAPLE ESE 114.6'
9" CHERRY ENE 113.05'
ST SIGN NE 54.7'
- WITNESS CARD
SAME WITNESSES
DIST E TO N 1/4 COR OF 2648.61
DIST W TO N 1/4 COR OF 2661.36
DIST S TO E 1/4 COR OF 2501.52

JAN 9, 1973 D.A. RATEKIN, C.S.
- ACT 132 SURVEY L-826, P-689
NE COR (C-1) PIPE
SW COR TEL CAB BX S 80° E 10.71
SW COR ST SIGN POST S 85° E 48.49
1" IRON (SE COR SEC 31) E 23.76
CENTERLINE 124TH AVE N 13'±

SECTION

AUG 22, 1974 D.A. RATEKIN, C.S.
- ACT 132 SURVEY L-858, P-769
SAME WITNESS AS ABOVE

NOV 17, 1977 D.A. RATEKIN, C.S.
- ACT 132 SURVEY (NOT RECORDED)
NW CORNER SECTION 5, T-2N, R-12W
1 1/4" PIPE
24" MAPLE ESE 114.6
9" CHERRY ENE 113.05
ST SIGN NE 54.7

MAY 6, 1982 J.H. DILLINGHAM, R.L.S
ACT 132 SURVEY (NOT RECORDED)
SAME WITNESSES AS REC'D SURVEYS

AUG 9, 1990 D.R. GREER, L.S.
ACT 132 SURVEY L-1265, P-707
NW COR SEC 5
1 1/2" PIPE
SW COR TEL CAB BX S 80° E 10.35'
1" IRON (SE CO SEC 31) E 23.76'
30" MAPLE S 85° E 115.59
12" CHINESE ELM S 56° W 23.52'

