

APR 29 1999

SECTION

ALLEGAN CO. REMONUMENTATION
LAND CORNER RECORDATION CERTIFICATE
Filing Requirement of Act 74, Mich. P.A. 1970

For corners in Allegan County

<u>ALLEGAN</u> (County)	Located in:	Corner Code #
1. Public Land Survey	T-2N R-12W	D-1
	T- R-	N-1/2 SEC. 5
	T- R-	WATSON TWP
	T- R-	
2. Property Controlling in Section	S- T- R-	
	S- T- R-	
3. Miscellaneous Property in Sec.	S- T- R-	
	S- T- R-	

FILED

1/28/1999 2:44:39 PM

JOYCE A. WATTS
REGISTER OF DEEDS
ALLEGAN COUNTY, MICH

LIBERO 007 PAGE 1 13

Register of Deeds Stamp & File Number

4. Lot No. _____, Recorded Plat _____
5. Private Claims _____

I, ARTHUR W. BRINTNALL, in a field survey on 27 AUG 19 98 do hereby state that under requirements of P.A. 74, Michigan P.A. of 1970, the corner points mentioned in lines 1 and 2 above were in conformance with regulations and rules therefore as required in the current manual of survey instructions of the United States Department of the Interior, Bureau of Land Management or by a decree of a Court of Law and/or that the corner points mentioned in lines 3, 4 and 5 above were in conformance with the rules of the Michigan Board of Land Surveyors or by a Decree of a Court of Law, established, re-established, monumented, recovered, found as expressed below.

NOTE: Not more than 2 corners, all in the same town and range, may be recorded on this certificate.

	A	B	C	D	E	F	G	H	I	J	K	L	M
1													
2	6		5		4		3		2		1		
3													
4	7		8		9		10		11		12		
5													
6	18		17		16		15		14		13		
7													
8	19		20		21		22		23		24		
9													
10	30		29		28		27		26		25		
11													
12	31		32		33		34		35		36		
13													

A. Description of original monument and accessories and/or subsequent restoration:

THIS POSITION WAS NOT ESTABLISHED BY GOVT. SURVEYORS.

CONT ON BACK OF CERTIFICATE

B. Description of corner evidence found and/or method applied in restoring or reestablishing corner:

FD 1/2" IRON ON TWP LINE
36" MAPLE S 35° W 34.0
40 D NE SDE 24" MAPLE S 52° E 36.68
16 D NW SDE 44" MAPLE S 41° W 95.35
36" MAPLE S 70° E 70.6'
D-13 (T-3N, R-12W) 1" IRON EAST 15.65

REPLACED 1/2" IRON WITH STD A.C. MON (3/4" X 24" IRON WITH CAP)
THIS POSITION NOT ESTABLISHED BY G.L.O.
THIS MONUMENT IS ACCEPTED AS BEST AVAILABLE EVIDENCE OF THE POSITION OF THE CORNER

APPROVED BY ALLEGAN PEER GROUP 11 AUG 98

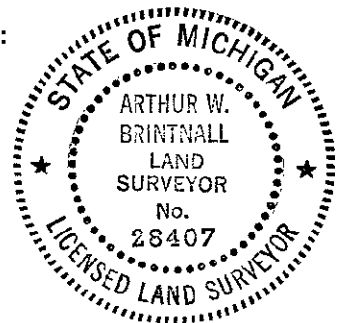

C. Description of monument for corner and accessories established to perpetuate locating the position of the corner:

STD A.C. MON (3/4" X 24" IRON WITH CAP)
IN CENTERLINE 124TH AVE
CENTERLINE DR TO NORTH HOUSE #2095 EAST 11'±
NAIL & REMON TAG NE SDE 20" MAPLE S 60°E 46.33'
NAIL & REMON TAG NE SDE 24" MAPLE S 50° E 36.66'
NAIL & REMON TAG SE SDE 36" MAPLE S 35° W 34.08'
NAIL & REMON TAG S'LY SDE 24" MAPLE N 80° E 73.68'
D-13 (T-3N, R-12W) STD A.C. MON EAST 15.65'

APPROVED REMONUMENTATION CORNER
P.A. 345 OF 1990
ALLEGAN COUNTY
DATE APPROVED AUG. 11, 1998
COUNTY REP. Phil A. Van Oort

Signed by Arthur W. Brintnall
PREIN&NEWHOF
Surveyor's Michigan License No. #28407

Date SEPT 8, 1998

D-1 WATSON TWP,

A CONTINUED

SURVEY
REMONUMENTATION

APR 29 1990

SECTION

D.A. RATEKIN, C.S.

WITNESS CARD

SET 1" IRON

WEST 2648.61' TO C-1

EAST 2648.61' TO E-1

ANGLE TO SOUTH AT D-13 (T-3N, R13W) OF 179°-46'-30"

10" MAPLE N 21.35

14" MAPLE NNW 22.80

24" OAK SW 44.60

14" MAPLE SE 35.60

AUG 9, 1990 D.R. GREER, P.S.

ACT 132 SURVEY

1" IRON FD BENT, RESET 1/2" IRON

30" MAPLE S 35° W 34.03'

14" MAPLE S 52° E 36.68'

32" MAPLE S 41° W 95.42'

30" MAPLE S 70° E 70.59'

IRON 3/4 COR SEC 31-3-12 EAST 15.77

LINERO 007 PAGE 114

