

**SURVEY
REMONUMENTATION**

APR 29 1998

SECTION

**ALLEGAN CO. REMONUMENTATION
LAND CORNER RECORDATION CERTIFICATE
Filing Requirement of Act 74, Mich. P.A. 1970**

For corners in Allegan County

<u>ALLEGAN</u> (County)	Located in:	Corner Code #
1. Public Land Survey	T-2N R-12W	E-1
	T R	NE SEC. 5
	T R	WATSON TWP
	T R	
2. Property Controlling in Section	S T R	
	S T R	
3. Miscellaneous Property in Sec.	S T R	
	S T R	

4. Lot No. _____, Recorded Plat _____
5. Private Claims _____

FILED

1/28/1999 2:44:39 PM

JOYCE A. MATTS
REGISTER OF DEEDS
ALLEGAN COUNTY, MICH

LIBERO 007 PAGE 15

Register of Deeds Stamp & File Number

I, ARTHUR W. BRINTNALL, in a field survey on 27 AUG 19 98 do hereby state that under requirements of P.A. 74, Michigan P.A. of 1970, the corner points mentioned in lines 1 and 2 above were in conformance with regulations and rules therefore as required in the current manual of survey instructions of the United States Department of the Interior, Bureau of Land Management or by a decree of a Court of Law and/or that the corner points mentioned in lines 3, 4 and 5 above were in conformance with the rules of the Michigan Board of Land Surveyors or by a Decree of a Court of Law, established, re-established, monumented, recovered, found as expressed below:

NOTE: Not more than 2 corners, all in the same town and range, may be recorded on this certificate.

1	A	B	C	D	E	F	G	H	I	J	K	L	M
2		6		5		4		3		2		1	
3													
4		7		8		9		10		11		12	
5													
6		18		17		16		15		14		13	
7													
8		19		20		21		22		23		24	
9													
10		30		29		28		27		26		25	
11													
12		31		32		33		34		35		36	
13													

A. Description of original monument and accessories and/or subsequent restoration:

G.L.O.
NORTH BETN SECS 4&5
78.10 INTERSECT N. BOUNDARY 33 LKS (21.78')
W OF POST WHERE SET COR SECS 4&5
BEECH 6 S 50 E 36
ELM 19 S 68 W 51

SEPT 19, 1979 D.A. RATEKIN, C.S.
ACT 132 SURVEY
FD 1 1/4" PIPE
SE COR HDWL W. 13.11'
NE COR HDWL SW 26.35'
36" ASH NNW 44.7'
ST SIGN E 31.08'
8" WALNUT SE 75.45'

FEB 4, 1980 G.D. NEDERVELD, P.S.
ACT 132 SURVEY
1 1/2" IRON
N&T W. SDE 48" ASH NNW 46.5'
N&T N. SDE 16" WALNUT WNW 38.2'
N&T S. SDE FE COR POST E. 40.7'

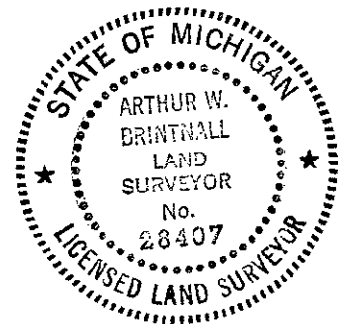

B. Description of corner evidence found and/or method applied in restoring or reestablishing corner:

FD 3/4" IRON IN M. BOX ON TOWNSHIP LINE
E-13 (3/4" IRON IN M. BOX) T-3N, R-12W EAST 21.70

REPLACE 3/4" IRON WITH STD A.C. MON (3/4" X 24" IRON WITH CAP) AND IS ACCEPTED AS A CAREFUL AND FAITHFUL PERPETUATION OF THE POSITION OF THE ORIGINAL CORNER.

APPROVED BY ALLEGAN PEER GROUP 11 AUG 98

C. Description of monument for corner and accessories established to perpetuate locating the position of the corner:

STD A.C. MON (3/4" X 24" IRON WITH CAP) IN MON BOX IN LINE WITH CENTERLINE 124TH AVE TO WEST
CENTERLINE 24TH ST EAST 13.0'
NAIL & REMON TAG S SDE COR FE POST EAST 44.28'
NAIL & REMON TAG NW COR FE POST S 45° W 40.18'
S. EDGE S LEG DIRECTION SIGN S 85° E 34.11
FD 1/2" IRON WITH CAP N 45° W 45.59'
E-13 (T-3N, R-12W) STD A.C. MON IN MON BOX EAST 21.78'

APPROVED REMONUMENTATION CORNER
P.A. 345 OF 1990
ALLEGAN COUNTY
DATE APPROVED AUG 11 1998
COUNTY REP. [Signature]

Signed by Arthur W. Brintnall

Date SEPT 8, 1998

Surveyor's Michigan License No. PREIN&NEWHOF #28407