

**ALLEGAN COUNTY REMONUMENTATION
LAND CORNER RECORDATION CERTIFICATE
Filing Requirement of Act 74, Mich. P.A. 1970**

For corners in

<u>ALLEGAN</u> (County)	Located in:	Corner Code #
1. Public Land Survey	T <u>2N</u> R <u>13W</u>	<u>D-3</u>
	T <u> </u> R <u> </u>	<u>S1/4 SEC. 5</u>
	T <u> </u> R <u> </u>	<u>ALLEGAN TWP</u>
	T <u> </u> R <u> </u>	_____
2. Property Controlling in Section	S <u> </u> T <u> </u> R <u> </u>	_____
	S <u> </u> T <u> </u> R <u> </u>	_____
3. Miscellaneous Property in Sec.	S <u> </u> T <u> </u> R <u> </u>	_____
	S <u> </u> T <u> </u> R <u> </u>	_____
4. Lot No. _____, Recorded Plat _____		
5. Private Claims _____		

FILED
1/28/1999 2:44:39 PM
JOYCE A. WATTS
REGISTER OF DEEDS
ALLEGAN COUNTY, MICH

Register of Deeds Stamp & File Number

LIBR0005 PAGE 329

I, ARTHUR W. BRINTNALL, in a field survey on 27 AUG 19 98 do hereby state that under requirements of P.A. 74, Michigan P.A. of 1970, the corner points mentioned in lines 1 and 2 above were in conformance with regulations and rules therefore as required in the current manual of survey instructions of the United States Department of the Interior, Bureau of Land Management or by a decree of a Court of Law and/or that the corner points mentioned in lines 3, 4 and 5 above were in conformance with the rules of the Michigan Board of Land Surveyors or by a Decree of a Court of Law; established, re-established, monumented, recovered, found as expressed below:

NOTE: Not more than 2 corners, all in the same town and range, may be recorded on this certificate.

A	B	C	D	E	F	G	H	I	J	K	L	M
1												
2	6		5		4		3		2		1	
3			⊕									
4	7		8		9		10		11		12	
5												
6	18		17		16		15		14		13	
7												
8	19		20		21		22		23		24	
9												
10	30		29		28		27		26		25	
11												
12	31		32		33		34		35		36	
13												

A. Description of original monument and accessories and/or subsequent restoration:

D-3
G.L.O.
EAST RANDOM BETWEEN SECTIONS 5 & 8
80.19' TO E. LINE OF SECS. 8 LKS S OF POST
WEST CORRECT BETN SECS. 5 & 8
40.04 SET QR SEC POSIT
BEECH 6 S 64° W 30
BEECH 20 N 24° E 14
NOV. 1912 H. MAC DOUGAL, C.S.
MEAS. 2674' W. TO SW COR SECTION 5

CONT. ON BACK OF CERTIFICATE

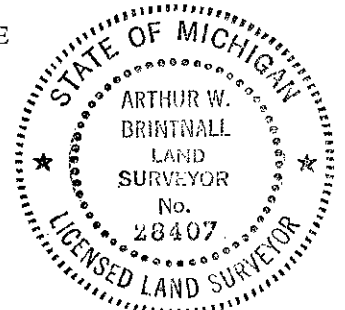

B. Description of corner evidence found and/or method applied in restoring or reestablishing corner:

D-3 FND 1" SQ IRON IN MON. BOX
NE COR M.B.T. PED. N 45° W 55.1'
MEAS. 268° 27' 54" 2674.58 TO SW COR.
MEAS. 88° 33' 36" 2679.78 TO SE COR.

REPLACED 1" SQ. IRON W/STD. A.C. MON AND IS ACCEPTED AS A CAREFUL AND FAITHFUL PERPETUATION OF THE POSITION OF THE ORIGINAL CORNER

APPROVED BY ALLEGAN PEER GROUP 11 AUG 98

C. Description of monument for corner and accessories established to perpetuate locating the position of the corner:

D-3 STD ALLEGAN COUNTY MON (3/4 X 24" IRON W/CAP) IN MON BOX
E. EDGE STOP SIGN POST N 35° W 41.08'
E. EDGE DEAD END ROAD SIGN POST N 15° E 108.17'
NAIL & REMON TAG SE SDE PP N 50° E 80.68'
E. EDGE E. LEG OF DIRECTION SIGN S 03° W 19.98'
CENTERLINE 122ND AVE SOUTH 1'± IN LINE W/CENTERLINE 33RD ST TO NORTH

APPROVED REMONUMENTATION CORNER
P.A. 345 OF 1990
ALLEGAN COUNTY

DATE APPROVED AUG 11, 1998
COUNTY REP. [Signature]

Signed by Arthur W. Brintnall
PREIN & NEWHOF

Date SEPT 8, 1998

Surveyor's Michigan License No. #28407

