

**ALLEGAN CO. REMONUMENTATION
LAND CORNER RECORDATION CERTIFICATE
Filing Requirement of Act 74, Mich. P.A. 1970**

FILED

LIBERO 006 PAGE 336

For corners in Allegan County

1/28/1999 2:44:39 PM

JOYCE A. WATTS
REGISTER OF DEEDS
ALLEGAN COUNTY, MICH

Register of Deeds Stamp & File Number

<u>ALLEGAN</u> (County)	Located in:	Corner Code #
1. Public Land Survey	T-2N R-13W	G-3
	T R	SE SEC. 4
	T R	ALLEGAN TWP
	T R	
2. Property Controlling in Section	S T R	
	S T R	
3. Miscellaneous Property in Sec.	S T R	
	S T R	
4. Lot No. _____, Recorded Plat _____		
5. Private Claims _____		

I, ARTHUR W. BRINTNALL, in a field survey on 27 AUG 19 98 do hereby state that under requirements of P.A. 74, Michigan P.A. of 1970, the corner points mentioned in lines 1 and 2 above were in conformance with regulations and rules therefore as required in the current manual of survey instructions of the United States Department of the Interior, Bureau of Land Management or by a decree of a Court of Law and/or that the corner points mentioned in lines 3, 4 and 5 above were in conformance with the rules of the Michigan Board of Land Surveyors or by a Decree of a Court of Law, established, re-established, monumented, recovered, found as expressed below:

NOTE: Not more than 2 corners, all in the same town and range, may be recorded on this certificate.

	A	B	C	D	E	F	G	H	I	J	K	L	M
1													
2	6	5	4				3	2	1				
3							⊕						
4	7	8	9	10	11	12							
5													
6	18	17	16	15	14	13							
7													
8	19	20	21	22	23	24							
9													
10	30	29	28	27	26	25							
11													
12	31	32	33	34	35	36							
13													

A. Description of original monument and accessories and/or subsequent restoration:

G.L.O.
NORTH BETN SECS 9&10
80.00 SET POST COR SECS 3, 4, 9 & 10
BEECH 7 N 71 E 10
BEECH 8 W 19

APRIL 27, 1972 D.A. RATEKIN, C.S.
L.C.R.C.
3/4" IRON
PK PP S 30° E 94.17
CENTERLINE PAVEMENT N 16.0
RR TIE FE POST S 70° W 43.5'
W GATE POST (RR TIE) S 60° E 51.1'
CENTERLINE W END 12" CMP S 65° E 47.55'
CENTERLINE E END 12" CMP S 70° E 71.1'
8" ASH N 50° E 111.2'

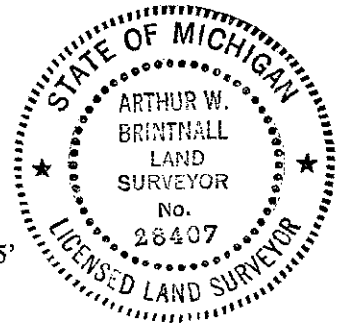

JUNE 23, 1977 D.A. RATEKIN, C.S.
- ACT 132 SURVEY
WITNESSES TO G-3 SAME AS AP. 1972

CONTINUED ON BACK OF CERTIFICATE

B. Description of corner evidence found and/or method applied in restoring or reestablishing corner:

FD 1" IRON
CENTERLINE 122ND AVE N 16.0'
CENTERLINE W END 12" CMP N 65° E 47.45'
CENTERLINE E END 12" CMP S 70° E 71.1'
24" ASH N 50° E 111.3'
269°29'39" 2626.4' TO F-3
APPROVED BY ALLEGAN PEER GROUP 11 AUG 98

REPLACED 1" IRON WITH STD A.C. MON
(3/4" X 36" IRON WITH CAP) AND IS ACCEPTED
AS A CAREFUL AND FAITHFUL PERPETUATION
OF THE POSITION OF THE ORIGINAL CORNER

C. Description of monument for corner and accessories established to perpetuate locating the position of the corner:

STD A.C. MON (3/4" X 36" IRON WITH CAP)
NAIL & REMON TAG N SIDE 18" ELM S 65° W 48.62'
NAIL & REMON TAG W SIDE TWIN 4" ASH N 15° E 52.62'
NAIL & REMON TAG W SIDE PP S 50° E 97.50'
NAIL & REMON TAG NW SIDE PP N 30° E 70.35'
CENTERLINE 122ND AVE NORTH 16.4'
CENTERLINE A-37 (30TH ST) E 295'±

APPROVED REMONUMENTATION CORNER
P.A. 345 OF 1990
ALLEGAN COUNTY
DATE APPROVED AUG 11, 1998
COUNTY REP. [Signature]

Signed by Arthur W. Brintnall
PREIN&NEWHOF
Surveyor's Michigan License No. #28407

Date SEPT 8, 1998

