

REMONUMENTATION

APR 07 1998

SECTION

ALLEGAN COUNTY REMONUMENTATION  
LAND CORNER RECORDATION CERTIFICATE  
Filing Requirement of Act 74, Mich. P.A. 1970

For corners in

<u>ALLEGAN</u> (County)	Located in:	Corner Code #
1. Public Land Survey	T-2N R-13W	✓ H-1
	T R	N-1/4-COR
	T R	SEC 3
	T R	ALLEGAN TWP
2. Property Controlling in Section	S T R	
3. Miscellaneous Property in Sec.	S T R	

98 JAN 21 PM 1:17

FILED

Register of Deeds Stamp & File Number

REGISTER OF DEEDS  
ALLEGAN COUNTY MICH.

*Joyce A. Chatter*

4. Lot No. \_\_\_\_\_, Recorded Plat \_\_\_\_\_

5. Private Claims \_\_\_\_\_

I, Arthur W. Brintnall, in a field survey on 17 OCT 19 97 do hereby state that under requirements of P.A. 74, Michigan P.A. of 1970, the corner points mentioned in lines 1 and 2 above were in conformance with regulations and rules therefore as required in the current manual of survey instructions of the United States Department of the Interior, Bureau of Land Management or by a decree of a Court of Law and/or that the corner points mentioned in lines 3, 4 and 5 above were in conformance with the rules of the Michigan Board of Land Surveyors or by a Decree of a Court of Law; established, re-established, monumented, recovered, found as expressed below:

NOTE: Not more than 2 corners, all in the same town and range, may be recorded on this certificate.

A	B	C	D	E	F	G	H	I	J	K	L	M
1												
2	6	5	4	3	2	1						
3												
4	7	8	9	10	11	12						
5												
6	18	17	16	15	14	13						
7												
8	19	20	21	22	23	24						
9												
10	30	29	28	27	26	25						
11												
12	31	32	33	34	35	36						
13												

A. Description of original monument and accessories and/or subsequent restoration:

H-1  
G.L.O.  
CORNER WAS NOT ESTABLISHED BY G.L.O.

APPROVED REMONUMENTATION CORNER  
P.A. 345 OF 1990  
ALLEGAN COUNTY  
DATE APPROVED 10-14-97  
COUNTY REP. K.V.O.

B. Description of corner evidence found and/or method applied in restoring or reestablishing corner:

H-1  
NO EVIDENCE OF THIS CORNER EVER HAVING BEEN ESTABLISHED.

SET STD. ALLEGAN CO. MON. (3/4"x36" IRON W/CAP) HALF-WAY AND ON TOWN LINE BETWEEN G-1 AND I-1.

THIS POSITION NOT ESTABLISHED BY ORIGINAL GOVERNMENT SURVEYORS. THIS MONUMENT IS ACCEPTED AS THE BEST AVAILABLE EVIDENCE OF THE POSITION OF THE CORNER

APPROVED BY ALLEGAN CO. PEER GROUP 1 OCT. 97.

C. Description of monument for corner and accessories established to perpetuate locating the position of the corner:

H-1  
STD ALLEGAN CO. MON (3/4"x36" IRON W/CAP)  
-16D & REMON TAG NE SIDE 22" HICKORY N45°W 52.69'  
-16D & REMON TAG SE SIDE 9" HICKORY S40°W 31.56'  
-16D & REMON TAG SE SIDE 16" OAK S05°W 50.50'  
-16D & REMON TAG E SIDE 18" OAK NORTH 54.82'  
-WETMORE LAKE SOUTH 645'+  
STD A.C. MON (H-13, T3N R13W) EAST 4.94'

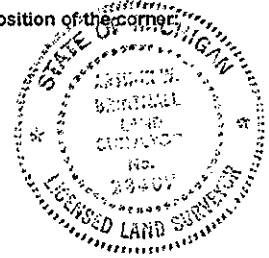

Signed by Arthur W. Brintnall Date Nov. 7, 1997

PREIN & NEWHOF  
Surveyor's Michigan License No. #28407