

**SURVEY & REMONUMENTATION**

APR 07 1998

2-2-

**SECTION**

**ALLEGAN COUNTY REMONUMENTATION  
LAND CORNER RECORDATION CERTIFICATE  
Filing Requirement of Act 74, Mich. P.A. 1970**

For corners in

<u>ALLEGAN</u> (County)	Located in:	Corner Code #
1. Public Land Survey	T-2N R-13W	✓ I-1, NE-3
	T R	ALLEGAN TWP
	T R	
	T R	
2. Property Controlling in Section	S T R	
	S T R	
3. Miscellaneous Property in Sec.	S T R	
	S T R	

REGISTER OF DEEDS  
 ALLEGAN COUNTY MICH.  
 98 JAN 21 PM 1:18  
 FILED  
 Register of Deeds Stamp & File Number

4. Lot No. \_\_\_\_\_, Recorded Plat \_\_\_\_\_  
 5. Private Claims \_\_\_\_\_

I, ARTHUR W. BRINTNALL, in a field survey on 3 JUL, 1997, do hereby state that under requirements of P.A. 74, Michigan P.A. of 1970, the corner points mentioned in lines 1 and 2 above were in conformance with regulations and rules therefore as required in the current manual of survey instructions of the United States Department of the Interior, Bureau of Land Management or by a decree of a Court of Law and/or that the corner points mentioned in lines 3, 4 and 5 above were in conformance with the rules of the Michigan Board of Land Surveyors or by a Decree of a Court of Law; established, re-established, monumented, recovered, found as expressed below:

NOTE: Not more than 2 corners, all in the same town and range, may be recorded on this certificate.

A	B	C	D	E	F	G	H	I	J	K	L	M
1												
2	6	5	4	3	2	1						
3												
4	7	8	9	10	11	12						
5												
6	18	17	16	15	14	13						
7												
8	19	20	21	22	23	24						
9												
10	30	29	28	27	26	25						
11												
12	31	32	33	34	35	36						
13												

**A. Description of original monument and accessories and/or subsequent restoration:**

I-1  
 G.L.O.  
 NORTH BETWEEN SECTION 2&3  
 80.00 SET POST 15 LKS (9.90')W OF POST IN NORTH BOUNDARY  
 CORNER SECTIONS 2&3  
 BEECH 30 S12E 29  
 BEECH 6 S66W 25

SEPTEMBER 1869 J.W. HICKS, C.S.  
 STONE  
 40.22 SOUTH TO WEST 1/4 SECTION 2

(CONT. ON BACK OF CERTIFICATE)

**B. Description of corner evidence found and/or method applied in restoring or reestablishing corner:**

I-1  
 FOUND 5/8" IRON  
 16D NAIL SOUTH SIDE 52" MAPLE EAST-NORTHEAST 54.64'  
 P.K. WEST SIDE 38" MAPLE NORTH-NORTHEAST 81.34'  
 SOUTHWEST CORNER HOUSE #2407 FND. NORTHEAST 113.95'  
 CENTERLINE 28TH STREET (GRAVEL) EAST 7±  
 3/4" IRON (I-13 MONTEREY) EAST 9.87'  
 REPLACED WITH STANDARD ALLEGAN COUNTY MONUMENT (3/4" X 24" IRON WITH CAP) AND IS ACCEPTED AS A CAREFUL AND FAITHFUL PERPETUATION OF THE POSITION OF THE ORIGINAL CORNER  
 APPROVED BY ALLEGAN PEER GROUP 10 JUN 97

APPROVED REMONUMENTATION CORNER  
 P.A. 345 OF 1990  
 ALLEGAN COUNTY  
 DATE APPROVED 6-10-97  
 COUNTY REP. K.V.C.

**C. Description of monument for corner and accessories established to perpetuate locating the position of the corner:**

I-1  
 STANDARD ALLEGAN COUNTY MONUMENT (3/4" X 24" IRON WITH CAP)  
 16 D NAIL & REMONUMENT TAG SOUTH SIDE 52" MAPLE N65°E 54.51'  
 16 D NAIL & REMONUMENT TAG WEST SIDE 48" MAPLE N15°E 149.83'  
 16 D NAIL & REMONUMENT TAG EAST SIDE POWER POLE N05°W 309.55'  
 STANDARD ALLEGAN COUNTY MONUMENT (I-13, T-3N, R-13W) EAST 9.87'  
 CENTERLINE 28TH STREET (GRAVEL) EAST 7±  
 SOUTHWEST CORNER HOUSE FND. (#2407) N50°E 113.95'

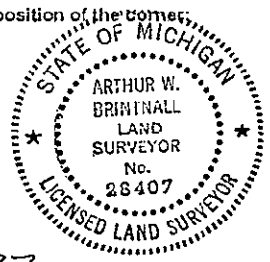

Signed by Arthur W. Brintnall Date 8-5-97  
 PREIN & NEWHOF  
 Surveyor's Michigan License No. #28407

FORM APPROVED BY MICHIGAN STATE BOARD OF PROFESSIONAL SURVEYORS, JAN. 28, 1971  
 REVISED MAY 14, 1975  
 REVISED JAN. 1983  
 REVISED OCT. 1995

LISE:0006 PAGE 019

OCTOBER 6, 1989 R.E. MOORED, P.S.  
SET 5/8" IRON ON TOWN LINE BY EXTENDING LINE FROM WEST 1/4 CORNER (1-2) THRU 1/8TH POST TO NORTH  
TELEPHONE POLE N30°W 46.63'  
40" MAPLE N60°E 54.65'  
30" MAPLE N30°E 81.33'  
CENTERLINE NORTH & SOUTH ROAD EAST 6'±  
MONTEREY CORNER EAST 10.05'

FEBRUARY 11, 1993 K.L. VANORDER, C.S.  
FOUND 1" IRON  
TELEPHONE POLE NORTH-NORTHWEST 46.65'  
48" MAPLE NORTHEAST 54.64'  
SOUTHWEST CORNER HOUSE FOUND NORTHEAST 114.00'  
36" MAPLE NORTH-NORTHEAST 81.33'