

MAR 07 2000

ALLEGAN COUNTY REMONUMENTATION
LAND CORNER RECORDATION CERTIFICATE
Filing Requirement of Act 74, Mich. P.A. 1970

00 FEB -1 AM 8:37

LEAD 007 PAGE 2 OF 6

SECTION

For corners in
Allegan (County) Located In: Corner Code #

1. Public Land Survey T2N R15W B-12
 T R
 T R
 T R
 T R
 Central 1/4 corner
 Section 31
 Clyde Twp.

2. Property Controlling S T R
 in Section S T R
 Property in Sec. S T R

3. Miscellaneous S T R
 Property in Sec. S T R

4. Lot No. _____, Recorded Plat _____

5. Private Claims _____

Joyce A. Clarke
REGISTER OF DEEDS
ALLEGAN COUNTY

Register of Deeds Stamp & File Number

I, Steve Lampen, in a field survey on December 22, 1999, do hereby certify that under requirements of P.A. 74, Michigan P.A. of 1970, the corner points mentioned in lines 1 and 2 above were in conformance with regulations and rules therefore as required in the current manual of survey instructions of the United States Department of the Interior, Bureau of Land Management or by a decree of a Court of Law and/or that the corner points mentioned in lines 3, 4 and 5 above were in conformance with the rules of the Michigan Board of Land Surveyors or by a Decree of a Court of Law; established, re-established, monumented, re-monumented, recovered, found as expressed below:

	A	B	C	D	E	F	G	H	I	J	K	L	M
1													
2	6	5	4	3	2	1							
3													
4	7	8	9	10	11	12							
5													
6	18	17	16	15	14	13							
7													
8	19	20	21	22	23	24							
9													
10	30	29	28	27	26	25							
11													
12	31	32	33	34	35	36							
13													

NOTE: Not more than 4 corners, all in the same town and range, may be recorded on this certificate.

A. Description of original monument and accessories and/or subsequent restoration:
B-12
Not set by Government

No date - County Surveyor's Notes
Power pole NNE 65.61'
14" Pine NW 55.39'
25" Cherry SW 47.17'
14" Maple S 25.82'
SE corner house NW 101.27'

1973 - G. Mitchell
Street sign S 19.68'
SE corner telephone cable box N 45° W 63.58'
Power pole N 45° E 66.80'

B. Description of corner evidence found and/or method applied in restoring or reestablishing corner:
B-12 Found railroad spike. 25" Cherry SW 46.8' to face SE corner house NW 101.27 SE corner telephone cable Box N 45° W 63.58' Power pole N 45° E 66.80'

Replaced railroad spike with an Allegan County Remonumentation iron and cap. Intersection of 1/4 lines is 0.29' North and 1.57' East of found iron. See sketch on back.

Corner not monumented by the original GLO Survey. This monument is accepted as the best evidence of the position of the corner.

Approved by the Allegan County Remonumentation Peer Group on December 28, 1999.

Traversed 7,641' on road and 2637' off road.

APPROVED REMONUMENTATION CORNER
P.A. 345 OF 1990
ALLEGAN COUNTY
DATE APPROVED DEC. 28, 1999
COUNTY REP. [Signature]

C. Description of monument for corner and accessories established to perpetuate locating the position of the corner:

B-12 Allegan County Remonumentation iron and cap
Azimuth - Michigan State Plane grid direction
Power pole remonumentation tag in NW side 206° 10' 49.76'
Power pole remonumentation tag in NW side 30° 11' 65.92'
6" Maple remonumentation tag in SW side 134° 55' 79.60'
NE corner house foundation 322° 31' 119.76'

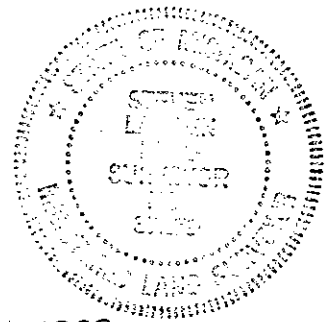

Signed by Steven Lampen Date DECEMBER 31, 1999

Surveyor's Michigan License No. 37279

RE
MAR 07 2000
SECTION

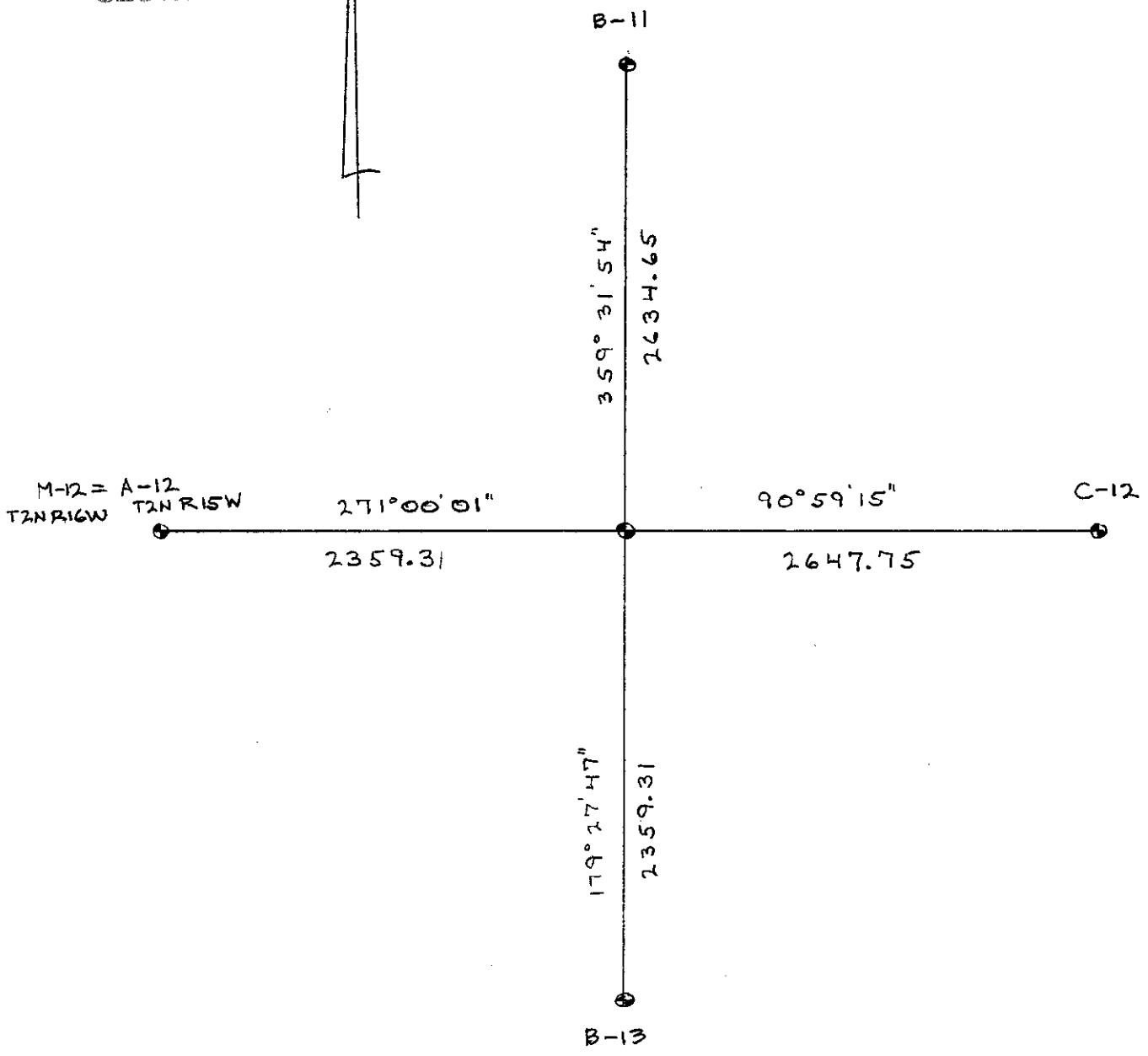

LIBR0007 PAGE2 07