

RF

MAR 07 2000

FILED

SECTION

ALLEGAN COUNTY REMONUMENTATION  
LAND CORNER RECORDATION CERTIFICATE  
Filing Requirement of Act 74, Mich. P.A. 1970

00 FEB -1 AM 8:40

LIBR00007 MAR27 1999

For corners in  
Allegan Located In: Corner Code #  
 (County)

1. Public Land Survey T2N R16W L-12  
 T R  
 T R Central 1/4 corner  
 T R Section 36  
 2. Property Controlling S T R Ganges Twp.  
 in Section S T R  
 3. Miscellaneous S T R  
 Property in Sec. S T R

*Joyce A. Bluth*  
REGISTER OF DEEDS  
ALLEGAN COUNTY, MICH.

Register of Deeds Stamp & File Number

4. Lot No. \_\_\_\_\_, Recorded Plat \_\_\_\_\_  
5. Private Claims \_\_\_\_\_

I, Steve Lampen \_\_\_\_\_, in a field survey on December 22, 1999, do hereby certify that under requirements of P.A. 74, Michigan P.A. of 1970, the corner points mentioned in lines 1 and 2 above were in conformance with regulations and rules therefore as required in the current manual of survey instructions of the United States Department of the Interior, Bureau of Land Management or by a decree of a Court of Law and/or that the corner points mentioned in lines 3, 4 and 5 above were in conformance with the rules of the Michigan Board of Land Surveyors or by a Decree of a Court of Law; established, re-established, monumented, re-monumented, recovered, found as expressed below:

NOTE: Not more than 4 corners, all in the same town and range, may be recorded on this certificate.

A. Description of original monument and accessories and/or subsequent restoration:  
L-12  
Not set by Government

No Date - County Surveyor's Records  
PK in 8" Cherry S 105.18'  
PK in 20" Cherry SE 104.70'  
SE corner telephone cable marker NW 51.26'  
PK in 16" Cherry NW 96.68

Survey records of Mitchell Surveys  
Indicate their use of a historical center

B. Description of corner evidence found and/or method applied in restoring or reestablishing corner:  
L-12 Found 1/2" iron in a monument box. PK in 16" Cherry NW 96.68  
Found an iron 33' North of found iron in monument box. The found iron in monument box is 0.78' South and 4.66' East of the intersection of the 1/4 lines. See sketch on back.

Replaced the 1/2" iron with an Allegan County Remonumentation iron and cap. This corner was not monumented by the original GLO Survey. The found iron is accepted as the best available evidence of the position of the corner.

Approved by the Allegan County Remonumentation peer Group on December 28, 1999.

Traversed 5258' on road and 5243' off road.

APPROVED REMONUMENTATION CORNER  
P.A. 345 OF 1990  
ALLEGAN COUNTY  
DATE APPROVED DEC. 28, 1999  
COUNTY REP. *[Signature]*

C. Description of monument for corner and accessories established to perpetuate locating the position of the corner:  
L-12 Allegan County Remonumentation iron and cap in monument box.

Azimuth = Michigan State Plane grid direction

20" Cherry remonumentation tag in NE side	317° 39'	82.85'
14" Cherry remonumentation tag in W side	180° 53'	104.48'
Centerline pipeline sign	331° 30'	45.28'
NE corner house foundation	212° 27'	224.03'

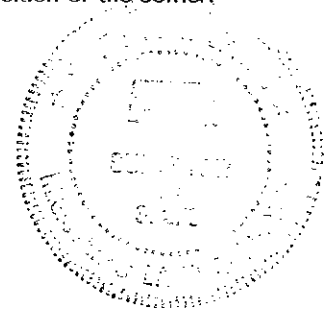

Signed by Steven Lampen

Date DECEMBER 31, 1999

Surveyor's Michigan License No. 37279

STREY &  
R.F. ...

MAR 07 2000

SECTION

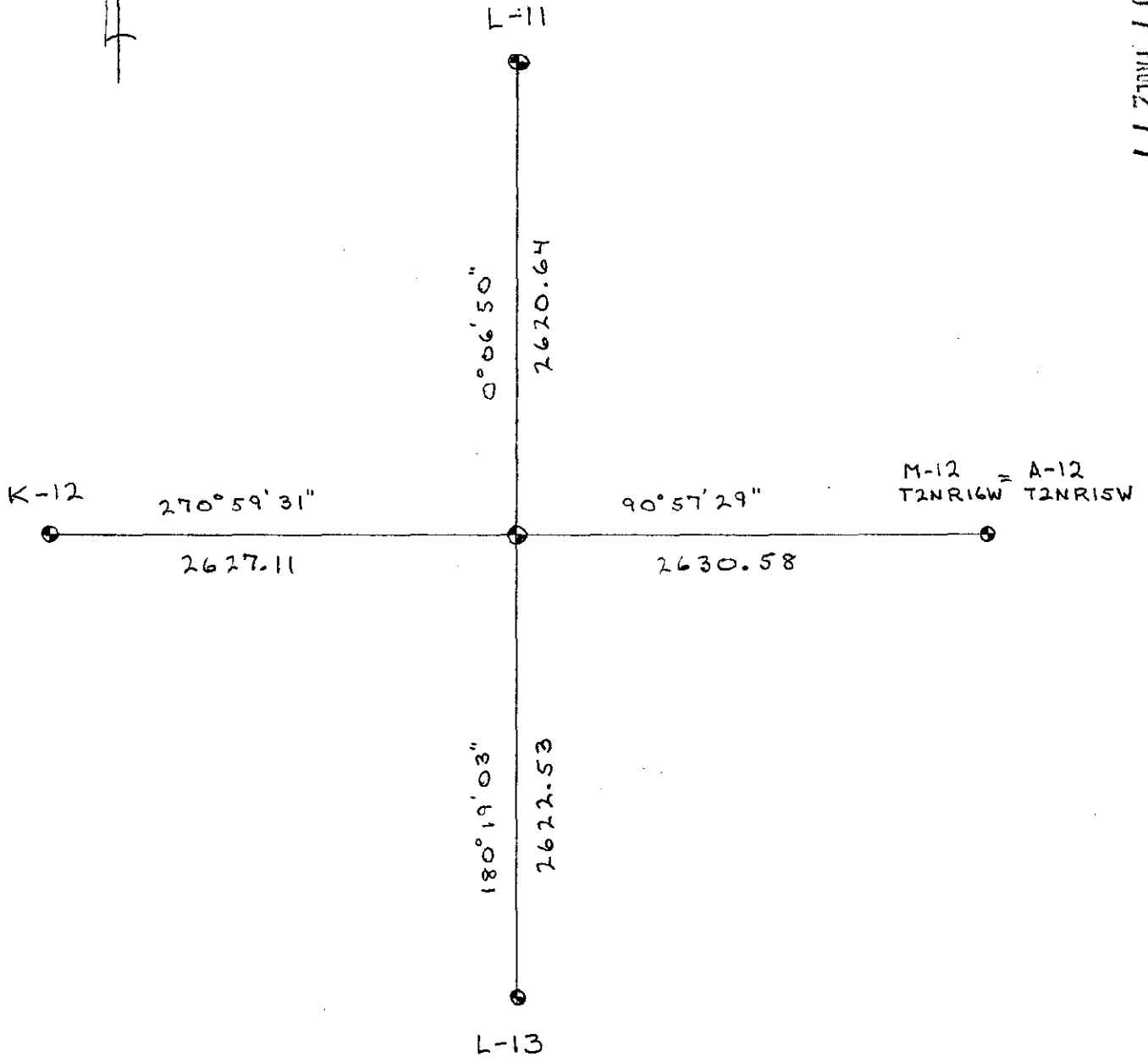

LIBRARY / FILE 1 /