

SURVEY & REMONUMENTATION

APR 07 1998

ALLEGAN COUNTY REMONUMENTATION LAND CORNER RECORDATION CERTIFICATE Filing Requirement of Act 74, Mich. P.A. 1970

For SECTION

Allegan
(County)

Located In: Wayland Township Corner Code # _____

1. Public Land Survey	T	<u>3NR</u>	<u>11W</u>	<u>1</u>	<u>E-1</u>
	T	R			
	T	R			
	T	R			
2. Property Controlling in Section	S	T	R		
	S	T	R		
3. Miscellaneous Property in Sec.	S	T	R		
	S	T	R		

Joyce A. Batten
 REGISTER OF DEEDS
 ALLEGAN COUNTY, MICH.

98 JAN 21 PM 1:37

FILED

Register of Deeds Stamp & File Number

4. Lot No. _____, Recorded Plat _____
 5. Private Claims _____

I, Robert Jonker, in a field survey on Jan. 3, 1997 do hereby state that under requirements of P.A. 74, Michigan P.A. of 1970, the corner points mentioned in lines 1 and 2 above were in conformance with regulations and rules therefore as required in the current manual of survey instructions of the United States Department of the Interior, Bureau of Land Management or by a decree of a Court of Law and for that the corner points mentioned in lines 3, 4 and 5 above were in conformance with the rules of the Michigan Board of Land Surveyors or by a Decree of a Court of Law, established, re-established, monumented, recovered, found as expressed below.

NOTE: Not more than 2 corners, all in the same town and range, may be recorded on this certificate.

	A	B	C	D	E	F	G	H	I	J	K	L	M
1													
2	6	5	4	3	2	1							
3													
4	7	8	9	10	11	12							
5													
6	13	11	16	15	14	13							
7													
8	19	20	21	22	23	24							
9													
10	30	29	28	27	26	25							
11													
12	31	32	33	34	35	36							
13													

A. Description of original monument and accessories and/or subsequent restoration:

1831 Sylvester Sibley D.S.
 North between Section 4 & 5, 79.54 ch.
 intersect N. line 2 lks. W of post & set post corners
 Section 4 & 5
 Beech 7 S 51 E 20
 Beech 10 S 57 E 48 (over)

APPROVED REMONUMENTATION CORNER
 P.A. 345 OF 1990
 ALLEGAN COUNTY
 DATE APPROVED 4-8-97
 COUNTY REP. K.V.O.

B. Description of corner evidence found and/or method applied in restoring or reestablishing corner:

Found 1" steel pin per LCRC 1, P.248 listed in "A" above.

Accepted as a careful and faithful perpetuation of the position of the original corner.

Peer group approved April 8, 1997.

C. Description of monument for corner and accessories established to perpetuate locating the position of the corner:

Set standard capped Allegan County monument.
 Allegan Co. Remon Nail & Tag E. side 10" Tw. Elm S8°W 11.10'
 Allegan Co. Remon Nail & Tag N. side 10" Ash S85°W 14.46'
 Allegan Co. Remon Nail & Tag N. side 20" Walnut S85°E 26.37'
 SE corner "L" fence post N10°E 15.03'
 E-13, Leighton Twp East 1.32'

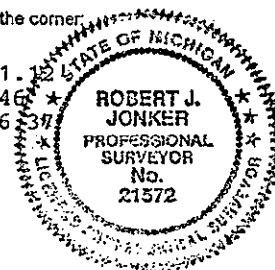

Signed by Robert Jonker
 Surveyor's Michigan License No. 21572

Date 4-4-97

E-1, T3N, R11W LCRC L. 1, Pg. 248 1972 Ratekin

Part "A"

Previous old corner was iron in fence corner

Part "B"

Found 1" Iron

Part "C" Took with.

12" Walnut	S 65° E	5.6'
14" Walnut	S 85° E	26.0'
Cor. fce. post	N 50° W	4.6'
6" Walnut	S 70° W	24.2'