

**SURVEY
REMONUMENTATION**

APR 29 1998

**ALLEGAN CO. REMONUMENTATION
LAND CORNER RECORDATION CERTIFICATE
Filing Requirement of Act 74, Mich. P.A. 1970**

SECTION

For corners in Allegan County

FILED

1/28/1999 2:44:39 PM

JOYCE A. WATTS
REGISTER OF DEEDS
ALLEGAN COUNTY, MICH

Register of Deeds Stamp & File Number

LIBR0006 PAGE 51

<u>ALLEGAN</u> (County)	Located in:	Corner Code #
1. Public Land Survey	T-3N R-12W	E-13
	T R	SE SEC. 32
	T R	HOPKINS TWP
	T R	
2. Property Controlling in Section	S T R	
	S T R	
3. Miscellaneous Property in Sec.	S T R	
	S T R	

4. Lot No. _____, Recorded Plat _____
5. Private Claims _____

I, ARTHUR W. BRINTNALL, in a field survey on 27 AUG, 1998 do hereby state that under requirements of P.A. 74, Michigan P.A. of 1970, the corner points mentioned in lines 1 and 2 above were in conformance with regulations and rules therefore as required in the current manual of survey instructions of the United States Department of the Interior, Bureau of Land Management or by a decree of a Court of Law and/or that the corner points mentioned in lines 3, 4 and 5 above were in conformance with the rules of the Michigan Board of Land Surveyors or by a Decree of a Court of Law; established, re-established, monumented, recovered, found as expressed below:

NOTE: Not more than 2 corners, all in the same town and range, may be recorded on this certificate.

A	B	C	D	E	F	G	H	I	J	K	L	M
1												
2	6		5		4		3		2		1	
3												
4	7		8		9		10		11		12	
5												
6	18		17		16		15		14		13	
7												
8	19		20		21		22		23		24	
9												
10	30		29		28		27		26		25	
11												
12	31		32		33		34		35		36	
13												

A. Description of original monument and accessories and/or subsequent restoration:

G.L.O.
WEST SOUTH SIDE SEC 33
80.00 SET POST COR SECS 32 & 33
BEECH 13 N 75 E 24
BEECH 8 N 72 W 66

APR 29TH, 30TH & MAY 2ND 1887 E.P. WATERMAN, D.C.S.
- MEAS 40.26 (2657.16') WEST TO S ¼ COR

D.A. RATEKIN, C.S.
WITNESS CARD
M. BOX 9' E OF CENTERLINE 20TH ST
NE CORNER SEC 5 T-2N, R-12W WEST 21.78

B. Description of corner evidence found and/or method applied in restoring or reestablishing corner:

FD ¾" IRON IN M. BOX
MEAS 2655.74' TO S ¼ COR
¾" IRON IN M. BOX (E-1) WEST 21.70

APPROVED REMONUMENTATION CORNER
P.A. 345 OF 1990
ALLEGAN COUNTY

DATE APPROVED Aug. 11, 1998
COUNTY REP. [Signature]

REPLACED ¾" IRON WITH STD A.C. MON (¾" X 24" IRON WITH CAP) AND IS ACCEPTED AS A CAREFUL AND FAITHFUL PERPETUATION OF THE POSITION OF THE ORIGINAL CORNER

APPROVED BY ALLEGAN PEER GROUP 11 AUG 98

C. Description of monument for corner and accessories established to perpetuate locating the position of the corner:

STD A.C. MON (¾" X 24" IRON WITH CAP) IN M. BOX
CENTERLINE 20TH ST WEST 8.8'
IN CENTERLINE 124TH AVE TO WEST
IN LINE WITH OCC TO EAST
E-1 (T-2N, R-12W) STD A.C. MON IN MON BOX WEST 21.78'
NAIL & REMON TAG S SDE COR FE POST EAST 22.50'
NAIL & REMON TAG NW COR FE POST S 45° W 55.33
S EDGE S LEG DIRECTION SIGN S 80° E 12.83'
FD ½" IRON WITH CAP N 60° W 63.40'

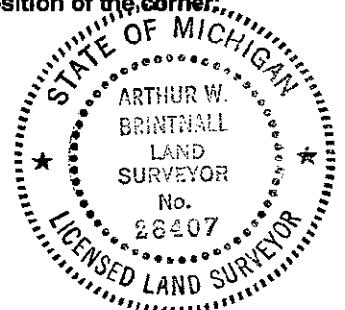

Signed by Arthur W. Brintnall

Date Sept 8, 1998

PREIN&NEWHOF
Surveyor's Michigan License No. #28407