

**ALLEGAN COUNTY REMONUMENTATION
LAND CORNER RECORDATION CERTIFICATE
Filing Requirement of Act 74, Mich. P.A. 1970**

For corners in

<u>Allegan</u> (County)	Located In:	Corner Code #
1. Public Land Survey	T 3N R 14W * A-1 Heath Twp.	
	T 4N R 14W A-13 Overisel Twp.	
	T 3N R 15W M-1 Manlius Twp.	
	T 4N R 15W M-13 Fillmore Twp.	
2. Property Controlling in Section	S ___ T ___ R ___	___
3. Miscellaneous Property in Sec.	S ___ T ___ R ___	___

97 JAN 22 PM 1:23
 REGISTERED
 ALLEGAN COUNTY
 REGISTER OF DEEDS STAMP & FILE NUMBER

4. Lot No. _____, Recorded Plat _____
 5. Private Claims _____

I, Kirk L. Van Order, in a field survey on May 5, 1996 do hereby state that under requirements of P.A. 74, Michigan P.A. of 1970, the corner points mentioned in lines 1 and 2 above were in conformance with regulations and rules therefore as required in the current manual of survey instructions of the United States Department of the Interior, Bureau of Land Management or by a decree of a Court of Law and/or that the corner points mentioned in lines 3, 4 and 5 above were in conformance with the rules of the Michigan Board of Land Surveyors or by a Decree of a Court of Law, established, re-established, monumented, recovered, found as expressed below:

NOTE: Not more than 2 corners, all in the same town and range, may be recorded on this certificate.

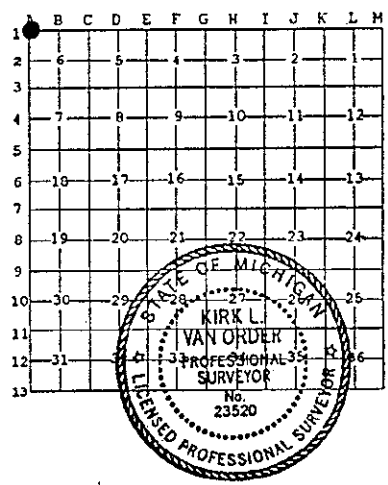

A. Description of original monument and accessories and/or subsequent restoration:

- A-1
- (1) GLO surveyed in 1831 by L. Lyon D.S. West on S side of Sec. 31, T.4N., R.14W. 77.02 chains to range line 5.01 links N of temp. point and set post corner to Town 3 & 4 North, Ranges 14 & 15 West Sugar 12 in. dia. S62°W 17 lks Beech 8 in. dia. N46°E 17 lks
 - (2) A. Gardner Co. Surveyor May 14, 1880 survey notes show iron at SW corner Sec. 31, T.4N., R.14W. (continued on back of sheet)

B. Description of corner evidence found and/or method applied in restoring or reestablishing corner:

A-1
 Kirk L. Van Order Remon. survey dated May 5, 1996
 Pd. 3/4" iron over stone in mon. box using ties as listed in (1) Part "A" and is accepted as a careful and faithful perpetuation of the position of the original corner.

Peer group approved May 14, 1996.

APPROVED REMONUMENTATION CORNER
 P.A. 345 OF 1990
 ALLEGAN COUNTY
 DATE APPROVED 5-14-96
 COUNTY REP. Kirk L. Van Order

C. Description of monument for corner and accessories established to perpetuate locating the position of the corner:

- A-1
- Removed iron and set standard Allegan Co. Remon. monument (3/4" x 11" steel rod w/red cap #23520) in concrete over stone in mon. box
 - Nail & Remon. tag in W side power pole N20°E 80.00'
 - Nail & Remon. tag in SW side tele. pole S30°E 45.61'
 - Nail & Remon. tag in SE side support pole S45°W 43.95'
 - Nail & Remon. tag in NE side power pole N45°W 87.06'

Signed by Kirk L. Van Order
 Surveyor's Michigan License No. 23520

Date 12-31-96

Section A (continued from Page 1)

A-1

Heath Twp., T.3N., R.14W.

- No ties or distance to other government corners
- (3) J.W. Hicks Co. Surveyor mid-1870's survey notes show corner 70.66 rods = 1165.89 West of highway, no corner object described or ties shown
- (4) Hugh MacDougall Co. Surveyor April 29, 1915 survey notes show iron and stone at corner, no ties
- (5) Don E. Allen Co. Surveyor Sept. 5, 19--? survey drawing shows NE corner Section 1, T.3N., R.15W., does not state what is at corner or give ties
- (6) Donald A. Ratekin & Associates, Co. Surveyor Sept. 16, 1970 survey drawing does not describe object at corner or give witness ties, but does show 1165.80' East to C/L Hwy. M-40 and an angle of 89°-10'-50" at the NW corner of Sec. 6, T.3N., R.14W.
- (7) State highway right-of-way map shows a distance 1165.20 feet East to C/L of Hwy. M-40
- (8) Holland Engineering survey dated Aug. 6, 1980
H.E.I. SW corner Sec. 31, T.4N., R.14W.
Fd. steel bar in mon. box
- | | | |
|--------------|-------|--------|
| Light pole | S34°W | 44.33' |
| Power pole | N25°E | 79.75' |
| NE cor. hse. | S40°W | 81.45' |
| Tele. pole | S45°E | 45.39' |
- Show distance of 1166.15' East to C/L Hwy. M-40
- (9) Kirk L. Van Order survey dated Sept. 5, 1985 shows fd. distance of 1166.14' East to C/L Hwy. M-40
Iron in mon. box
- | | | |
|---------------------|----|--------|
| Power pole | NE | 79.75' |
| SE cor. porch fndn. | NE | 98.54' |
| Tele. pole | SE | 45.29' |
| NE cor. Hse. | SW | 81.45' |
- (10) Kirk L. Van Order survey dated Feb. 25, 1986
Fd. iron in mon. box
(same ties as 1985 survey)
- (11) Kirk L. Van Order survey dated May 28, 1987
Fd. iron bar in mon. box
- | | | |
|---------------|----|--------|
| Tele. pole | SE | 45.58' |
| Support pole | SW | 44.03' |
| C/L stop sign | NW | 53.67' |
| Power pole | NE | 79.84' |
- (12) Kirk L. Van Order survey dated April 11, 1988
Show same info. as above in (11)
- (13) Kirk L. Van Order survey dated July 26, 1988
Fd. iron in mon. box
- | | | |
|---------------------|----|--------|
| Power pole | NE | 79.75' |
| SE cor. porch fndn. | NE | 98.54' |
| Tele. pole | SE | 45.29' |
| NE cor. hse. | SW | 81.45' |
- (14) Holland Engineering, Inc., 1996 fax
Fd. steel bar in MB
- | | | |
|---------------------------|----------------|---------|
| SW cor. hse. fndn. | AZ37°-39'-30" | 84.13' |
| NW cor. hse. wood siding | AZ150°-58'-30" | 102.18' |
| NE cor. bottom conc. step | AZ139°-00' | 115.81' |
| NE cor. hse. fndn. | AZ221°-17' | 81.18' |
| SE cor. hse. fndn. | AZ210°-27' | 103.30' |
| NW cor. hse. fndn. | AZ24°-10' | 129.00' |
- (15) Exxel Engineering, Inc. Jan. 24, 1996 fax
NE cor. Sec. 1, T.3N., R.15W., Manlius Twp.
Fd. solid iron in mon. box
- | | | |
|--|----|--------|
| Fd. pk nail in W side power pole | NE | 79.89' |
| Fd. pk nail in E side guy pole | SW | 44.09' |
| Fd. nail & washer in W side power pole | SE | 45.62' |
- On C/L 48th St. B.T. to N & 2'+/- N of C/L 136th Ave
Solid iron in mon. box West 2623.60'

(continued on next page)

Section A (continued from Page 2)

A-1

Heath Twp., T.3N., R.14W.

- (16) Kirk L. Van Order survey dated June 7, 1994
Fd. iron bar in mon. box Same ties as in (11)
Angle of 89°-32'-56" at the NW corner of Sec. 6, T.3N., R.14W.
- (17) Kirk L. Van Order survey dated April 11, 1989
Fd. iron in mon. box
- | | | |
|------------|----|--------|
| Power pole | NE | 79.90' |
| Tele. pole | SE | 45.65' |
| Sup. pole | SW | 44.12' |

RECEIVED
MAY 2 1987

MAY 2 1987

EXAMINATION