

For corners in
COMMISSION
Allegan
(County)

ALLEGAN COUNTY REMONUMENTATION
LAND CORNER RECORDATION CERTIFICATE
Filing Requirement of Act 74, Mich. P.A. 1970

393 DEC 30 PM 2:44
Jasper A. Bostwick
REGISTER OF DEEDS
ALLEGAN COUNTY, MICH.

FILED

Located In: Corner Code #

1. Public Land Survey T 3N R 14W I-9
T R Sec. 22, 23,
T R 26 & 27 Cor.
T R Heath Twp.

2. Property Controlling S T R
in Section S T R
3. Miscellaneous S T R
Property in Sec. S T R

4. Lot No. _____, Recorded Plat _____
5. Private Claims _____

Register of Deeds Stamp & File Number

I, Kirk VanOrder, in a field survey on October 13, 19 93, do hereby certify that under requirements of P.A. 74, Michigan P.A. of 1970, the corner points mentioned in lines 1 and 2 above were in conformance with regulations and rules therofore as required in the current manual of survey instructions of the United States Department of the Interior, Bureau of Land Management or by a decree of a Court of Law and/or that the corner points mentioned in lines 3, 4 and 5 above were in conformance with the rules of the Michigan Board of Land Surveyors or by a Decree of a Court of Law; established, re-established, monumented, re-monumented, recovered, found as expressed below:

NOTE: Not more than 4 corners, all in the same town and range, may be recorded on this certificate.

| | A | B | C | D | E | F | G | H | I | J | K | L | M |
|----|----|----|----|----|----|----|---|---|---|---|---|---|---|
| 2 | 6 | 5 | 4 | 3 | 2 | 1 | | | | | | | |
| 3 | | | | | | | | | | | | | |
| 4 | 7 | 8 | 9 | 10 | 11 | 12 | | | | | | | |
| 5 | | | | | | | | | | | | | |
| 6 | 15 | 17 | 16 | 15 | 14 | 13 | | | | | | | |
| 7 | | | | | | | | | | | | | |
| 8 | 19 | 20 | 21 | 22 | 23 | 24 | | | | | | | |
| 9 | | | | | | | | | | | | | |
| 10 | 30 | 29 | 28 | 27 | 26 | 25 | | | | | | | |
| 11 | | | | | | | | | | | | | |
| 12 | 31 | 32 | 33 | 34 | 35 | 36 | | | | | | | |
| 13 | | | | | | | | | | | | | |

A. Description of original monument and accessories and/or subsequent restoration:

I-9
•GLO set post @ 80.00 chains North of I-11.
9" Beech S24°W 18 links
24" W. Oak N34½°E 36 links

•K.V.O. survey 7-10-1987 #87-1369
15" Maple N,NE 42.04'
19" R. Oak NE 45.10'
6" Ash SE 70.84'
7" Hickory SW 89.14'
C/L gravel rd. S 13'+/-
Old metal culvert N & S W 1'+/-

•No previous LCRC's
•No recorded surveys found

B. Description of corner evidence found and/or method applied in restoring or reestablishing corner:

I-9
No corner found.

Set standard Allegan Co. monument on line using fence lines to N & S and other available field evidence.

Accepted as the best available evidence of the position of the original corner.

C. Description of monument for corner and accessories established to perpetuate locating the position of the corner:

I-9
Set standard Allegan Co. monument (3/4" x 24" steel rod with red plastic cap)
Nail & Allegan Co. Remon. tag in SW side 6" Ash SE 70.64'
Nail & Allegan Co. Remon. tag in N side 11" R. Oak SW 91.48'
Nail & Allegan Co. Remon. tag in W side 19" R. Oak NE 45.11'
Nail & Allegan Co. Remon. tag in W side 15" Maple N 42.11'

Signed by

Surveyor's Michigan License No. 23520

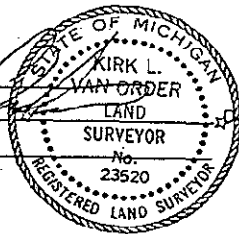

Date

12-30-93

LIBER 004 PAGE 333

FORM APPROVED BY MICHIGAN STATE BOARD OF LAND SURVEYORS, JAN. 28, 1971
REVISED MAY 14, 1975
REVISED JAN., 1983