

LAND CORNER RECORDATION CERTIFICATE
Filing Requirement of Act 74, Mich. P.A. 1970

For corners in
ALLEGAN

(County)	Located In:	Corner Code \neq
1. Public Land Survey	T <u>3N</u> R <u>14W</u>	<u>A-11</u>
	T _____ R _____	_____
	T _____ R _____	_____
	T _____ R _____	_____
2. Property Controlling in Section	S _____ T _____ R _____	_____
	S _____ T _____ R _____	_____
3. Miscellaneous	S _____ T _____ R _____	_____
Property in Sec.	S _____ T _____ R _____	_____

Register of Deeds Stamp & File Number

4. Lot No. _____, Recorded Plat _____
 5. Private Claims _____

I, GARY C. BILOW, in a field survey on APRIL 15, 19 91, do hereby certify that under requirements of P.A. 74, Michigan P.A. of 1970, the corner points mentioned in lines 1 and 2 above were in conformance with regulations and rules therefore as required in the current manual of survey instructions of the United States Department of the Interior, Bureau of Land Management or by a decree of a Court of Law and/or that the corner points mentioned in lines 3, 4 and 5 above were in conformance with the rules of the Michigan Board of Land Surveyors or by a Decree of a Court of Law; established, re-established, monumented, re-monumented, recovered, found as expressed below:

NOTE: Not more than 4 corners, all in the same town and range, may be recorded on this certificate.

	A	B	C	D	E	F	G	H	I	J	K	L	M
2	6	5	4	3	2	1							
3													
4	7	8	9	10	11	12							
5													
6	16	17	16	15	14	13							
7													
8	19	20	21	22	23	24							
9													
10	30	29	28	27	26	25							
11													
12	31	32	33	34	35	36							
13													

A. Description of original monument and accessories and/or subsequent restoration:

ORIGINAL CORNER POST ESTABLISHED BY U.S. GOVERNMENT DEPUTY SURVEYOR C. BRITAIN, 1831, ".7 SOUTH OF POST".
 ACCESSORIES: B. OAK & S75E 76
 W. OAK & N18E 08

FOUND NO RECORD OF PERPETUATION OR REESTABLISHMENT IN COUNTY RECORDS OR WITH LOCAL SURVEYORS.

B. Description of corner evidence found and/or method applied in restoring or reestablishing corner:

ORIGINAL MONUMENT AND ACCESSORIES NOT RECOVERED.
 FOUND A 1/2" DIAMETER THREADED ROD 30' SOUTH OF THE CENTERLINE OF THE GRAVEL SURFACE OF 126TH AVENUE. I NOTED THAT THE POSITION OF THIS CORNER IN RELATION TO ACCEPTED CORNER MONUMENTATION FOUND ALONG THE NORTH LINE OF SECTION 36, T3N-R15W CONFORMS REASONABLY WELL WITH THE G.L.O. RECORD AND WITH FIELD SURVEY NOTES ca. 1937 BY UNKNOWN SURVEYOR (BOOK 7, PAGE 1) SHOWING FOUND CORNERS AT L-11 AND (2) OF T3N-R15W. BASED ON THIS CONFORMITY, I ACCEPTED THE THREADED ROD AS THE BEST AVAILABLE EVIDENCE OF THE POSITION OF THE ORIGINAL CORNER.

C. Description of monument for corner and accessories established to perpetuate locating the position of the corner:

FOUND 1/2" DIAMETER THREADED IRON ROD
 WEST 3.25' SET NAIL AND MICHIGAN DEPARTMENT OF NATURAL RESOURCES TAG
 IN NE FACE 8" TRIPLE WHITE OAK
 N30E 19.66' SET NAIL AND MDNR TAG IN WEST FACE 12" WHITE OAK
 N60E 22.56' SET NAIL AND MDNR TAG IN NW FACE OF SW BOLE OF 10" QUADRUPLE BLACK OAK
 NORTH 46.20' 4" DIAMETER CONCRETE MONUMENT WITH MDNR CAP AT THE NORTHEAST CORNER OF SECTION 36, T2N-R15W

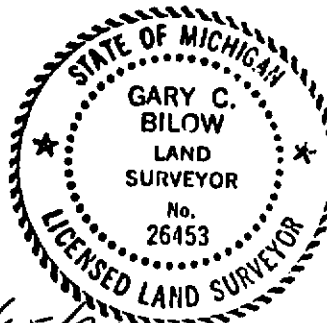

Signed by Gary C. BiLow Date 8/15/91
 Surveyor's Michigan License No. 26453

FORM APPROVED BY MICHIGAN STATE BOARD OF LAND SURVEYORS, JAN. 28, 1971
 REVISED MAY 14, 1975
 REVISED JAN., 1983