

**LAND CORNER RECORDATION CERTIFICATE**  
**Filing Requirement of Act 74, Mich. P.A. 1970**

For corners in  
**ALLEGAN**

	(County)	Located In:	Corner Code #	
1. Public Land Survey		T <u>3N</u> R <u>15W</u>	<u>L-13</u>	
		T _____ R _____	_____	
		T _____ R _____	_____	
		T _____ R _____	_____	
2. Property Controlling in Section	S <u>36</u>	T <u>3N</u> R <u>15W</u>	<u>1</u>	
	S <u>36</u>	T <u>3N</u> R <u>15W</u>	<u>2</u>	
3. Miscellaneous Property in Sec.	S _____	T _____ R _____	_____	
	S _____	T _____ R _____	_____	
4. Lot No. _____		Recorded Plat _____		
5. Private Claims _____				

**Register of Deeds Stamp & File Number**

	A	B	C	D	E	F	G	H	I	J	K	L	M
2	6	5	4	3	2	1							
3													
4	7	8	9	10	11	12							
5													
6	16	17	16	15	14	13							
7													
8	19	20	21	22	23	24							
9													
10	30	29	28	27	26	25							
11													
12	31	32	33	34	35	36							
13													

I, GARY C. BILOW, in a field survey on APRIL 15, 19 91, do hereby certify that under requirements of P.A. 74, Michigan P.A. of 1970, the corner points mentioned in lines 1 and 2 above were in conformance with regulations and rules therefore as required in the current manual of survey instructions of the United States Department of the Interior, Bureau of Land Management or by a decree of a Court of Law and/or that the corner points mentioned in lines 3, 4 and 5 above were in conformance with the rules of the Michigan Board of Land Surveyors or by a Decree of a Court of Law; established, re-established, monumented, re-monumented, recovered, found as expressed below:

**NOTE: Not more than 4 corners, all in the same town and range, may be recorded on this certificate.**

**A. Description of original monument and accessories and/or subsequent restoration:**

(L-13) ORIGINAL CORNER POST ESTABLISHED BY U.S. GOVERNMENT DEPUTY SURVEYOR L. LYON, 1832. ACCESSORIES: W. OAK @ N29W 2.14, W. OAK @ S35E 1.03. OLD NOTES OF D.A. RATEKIN FOUND AT OFFICES OF WIGHTMAN-MOORE, INC. IN ALLEGAN SHOW: "SET IRON DEC. '69". RATEKIN'S ACCESSORIES ARE: CENTER OF R.O.W. MARKER S.W. 66.65', 6" OAK S. 83.85', 8" CHERRY S.E. 88.20', CENTER OF R.O.W. MARKER N.E. 83.35', CENTERLINE OF HIGHWAY M89 NORTH 15.0', 3/4" IRON (N1/4 POST SEC 1 CLYDE) W. 20.15'.

(1) CORNER NOT ESTABLISHED IN ORIGINAL SURVEY. CORNER POSITION SHOWN ON A 1979 SURVEY BY T.E. JOINER RECORDED IN LIBER 960, PAGES 333-334 ALLEGAN COUNTY RECORDS AS BEING MIDWAY AND ON A STRAIGHT LINE BETWEEN K-11 AND L-11. NO MONUMENTATION AT THE POSITION IS SHOWN. FOUND NO OTHER RECORD OF THIS CORNER.

(2) CORNER NOT ESTABLISHED IN ORIGINAL SURVEY. FIELD SURVEY NOTES OF MATZINGER, BOOK 7, PAGE 1, DATED 6-24-37, SHOW "FOUND WOOD STAKE" 1322.3' EAST OF IRON PIPE AT L-11. NO ACCESSORIES ARE SHOWN.

**B. Description of corner evidence found and/or method applied in restoring or reestablishing corner:**

(L-13) ORIGINAL POST AND ACCESSORIES NOT RECOVERED. FOUND AND ACCEPTED A 1" DIAMETER IRON BAR 0.3' SOUTH OF THE SOUTH EDGE OF BITUMINOUS PAVEMENT OF STATE HIGHWAY M-89. RATEKIN'S ACCESSORIES TO R.O.W. MARKERS, CENTERLINE OF M-89, AND TO IRON AT N1/4 CORNER OF SECTION 1 T2N-R15W, CHECK FAIRLY WELL (SEE BELOW).

(1) ESTABLISHED CORNER MIDWAY AND ON A STRAIGHT LINE BETWEEN K-11 AND L-11 AS RECORDED THIS DATE. MONUMENTED THE POSITION WITH A 1/2"x36" REBAR ENCASED IN A 4" DIAMETER CONCRETE CYLINDER CAPPED WITH A CAST ALUMINUM MICHIGAN DEPARTMENT OF NATURAL RESOURCES TABLET. FROM THE POSITION MONUMENTED, I FOUND A 1 1/2" PIPE 0.12' SOUTH AND 0.58' EAST.

(2) FOUND NO MONUMENTATION AT THIS POSITION. ESTABLISHED CORNER MIDWAY AND ON A STRAIGHT LINE BETWEEN L-11 AND M-11 AS RECORDED THIS DATE. MONUMENTED THE CORNER POSITION WITH A 4" DIAMETER CONCRETE MONUMENT WITH MDNR CAP AS DESCRIBED ABOVE. I DETERMINED THE DISTANCE WEST TO L-11 TO BE 1322.32', AGREEING WELL WITH THE MATZINGER DISTANCE NOTED ABOVE.

**C. Description of monument for corner and accessories established to perpetuate locating the position of the corner:**

(L-13) FOUND 1" DIA. IRON BAR	(1) SET CONCRETE MONUMENT WITH MDNR CAP	(2) SET CONCRETE MONUMENT WITH MDNR CAP
N25E 82.11' CONCRETE HIGHWAY R/W MARKER	N35E 39.48' NW FACE 12" OAK	N81E 29.64' NORTH FACE 8" WHITE OAK
S45W 66.51' CONCRETE HIGHWAY R/W MARKER	S59E 51.86' NORTH FACE 13" OAK	N40E 6.69' NW FACE 7" WHITE OAK
N48W 81.31' STREET SIGN	S42W 18.91' SE FACE 12" OAK	N05E 34.38' EAST FACE 6" WHITE OAK
S65E 51.28' SET NAIL AND MDNR TAG IN SW FACE 12" OAK	N16W 25.42' SW FACE 8" OAK	S57E 56.84' NORTH FACE OF N'LY BOLE 14" TWIN OAK
WEST 20.18' FND 1" IRON BAR AT N 1/4 CORNER SECTION 1, T2N-R15W	(ALL MEASUREMENTS ABOVE ARE TO NAILS WITH MDNR TAGS)	(ALL MEASUREMENTS ABOVE ARE TO NAILS WITH MDNR TAGS)
	SOUTH 3' SOUTH EDGE OF GRAVEL 126TH AVENUE	SOUTH 16' CENTERLINE OF GRAVEL SURFACE OF 126TH AVENUE.
	EAST 24' CENTERLINE OF TRAIL TO SOUTH	
	N30E FOUND BENT 1/2" IRON BAR	

Signed by Gary C. Bilow  
 Surveyor's Michigan License No. 26453

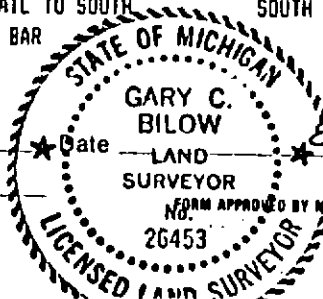

FORM APPROVED BY MICHIGAN STATE BOARD OF LAND SURVEYORS, JAN. 28, 1971  
 REVISED MAY 14, 1975  
 REVISED JAN., 1983