

SURVEY & MONUMENTATION

2-2-

APR 07 1998

ALLEGAN COUNTY REMONUMENTATION
LAND CORNER RECORDATION CERTIFICATE
Filing Requirement of Act 74, Mich. P.A. 1970

For corners in **SECTION**
Allegan Co. Located in: Leighton Twp. Corner Code #
(County)

1. Public Land Survey	T	R	
	T	R	✓ D-5
	T	R	
	T	R	
2. Property Controlling in Section	S	T	R
	S	T	R
3. Miscellaneous Property in Sec.	S	T	R
	S	T	R

98 JAN 21 PM 1:25
REGISTER OF DEEDS
ALLEGAN COUNTY, MICHIGAN
FILED
Register of Deeds Stamp & File Number

4. Lot No. _____, Recorded Plat _____
5. Private Claims _____

I, Robert Jonker in a field survey on 11-28, 1997 do hereby state that under requirements of P.A. 74, Michigan P.A. of 1970, the corner points mentioned in lines 1 and 2 above were in conformance with regulations and rules therefore as required in the current manual of survey instructions of the United States Department of the Interior, Bureau of Land Management or by a decree of a Court of Law and for that the corner points mentioned in lines 3, 4 and 5 above were in conformance with the rules of the Michigan Board of Land Surveyors or by a Decree of a Court of Law; established, re-established, monumented, recovered, found as expressed below:

NOTE: Not more than 2 corners, all in the same town and range, may be recorded on this certificate.

A	B	C	D	E	F	G	H	I	J	K	L	M
1												
2	6	5	4	3	2	1						
3												
4	7	8	9	10	11	12						
5												
6	10	17	16	15	14	13						
7												
8	19	20	21	22	23	24						
9												
10	30	29	28	27	26	25						
11												
12	31	32	33	34	35	36						
13												

A. Description of original monument and accessories and/or subsequent restoration:

1831 G.L.O. survey	LCRC #3-162, 1977, MYK	LCRC #4-69, 1990, Jack Bueche
West between 8 & 17	Set iron @ int. of roads	1 1/2" solid iron
40.00 ch. Set qu. sec. post	C/L bt. S. 3'	C/L bt. 3' S
Sugar 15 S 38 W 25	PK NW side p.pole SW 70.20'	PK NW side p.pole SW 70.20'
Beech 8 N 13°E 24	PK SE side t.pole NE 40.55'	PK twp. post N70°W 46.45'
	PK W. side t.pole SSE 111.50'	PK W. side 48" Elm S45°E
E. Strong, 1870	Spk. S. side 12" Maple ESE 104.17'	109.35'
14 x 8 x 5 stone		SW cor. garage N65°E 112.3'

B. Description of corner evidence found and/or method applied in restoring or reestablishing corner:

Found 1" solid pin with 1 3/4" head by wit. per L.C.R.C. 4-69 listed in "A" above 1996

APPROVED REMONUMENTATION CORNER
P.A. 345 OF 1990
ALLEGAN COUNTY
DATE APPROVED 12-9-97
COUNTY REP. K.V.O.

Accepted as the best available evidence of the position of the corner.

Peer group approved Dec. 9, 1997.

C. Description of monument for corner and accessories established to perpetuate locating the position of the corner:

Replaced with 3/4" x 36" standard Allegan County monument
A.C. Remon. tag on W. side 50" Elm S 34° E 109.55'
SW corner garage foundation N 65° E 112.34'
Found PK nail top. wood post N 70° W 47.09'
Found PK nail NW side p. pole SW 70.65'
C/L. B.T. South 3'+-

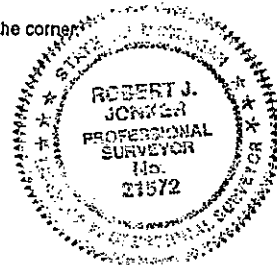

Signed by Robert J. Jonker
Surveyor's Michigan License No. 21572

Date November 29, 1997

Part "A" Cont'd

N & A & Assoc. notes - no date
 2" Solid Iron
 C/L "X" 2.5' S & 2' W +-
 PK nail S. side t. pole NE 40.65'
 PK nail N. side P. pole SW 70.21'
 C/L st. sign SE 37.8

N & A survey - L.1249, P.468 - Iron -1990
 C/L B.T. S. 3'
 Nail NW side p. pole SW 74.20'
 Nail SE side t. pole NE 40.55'
 Nail W. side t. pole SSE 111.50'
 Nail S. side 12" Maple ESE 104.17'

1984 - Jonker Land Surveys
 Found 2" Iron
 PK NW side p. pole S 45° W 70.20'
 PK SE side T. pole N 60° E 40.70'
 PK W. side T. pole S 15° E 111.5'