

LAND CORNER RECORDATION CERTIFICATE
 Filing Requirement of Act 74, Mich. P.A. 1970

For corners in <u>Allegan</u> (County)	Located In:	Corner Code #
	4N 11W	M-5(SE. 12)
1. Public Land Survey	T _____ R _____	Leighton Twp.
	T _____ R _____	
	T _____ R _____	
	T _____ R _____	
2. Property Controlling in Section	S _____ T _____ R _____	
	S _____ T _____ R _____	
3. Miscellaneous Property in Sec.	S _____ T _____ R _____	
	S _____ T _____ R _____	
4. Lot No. _____, Recorded Plat _____		
5. Private Claims _____		

1995 DEC 14 PM 2:34
 REGISTER OF DEEDS
 ALLEGAN COUNTY, MICHIGAN

FILED

Register of Deeds Stamp & File Number

SURVEY & REMONUMENTATION COMMISSION
 APR 29 1996

I, Steven Koerber, in a field survey on August 31, 19 95, do hereby certify that under requirements of P.A. 74, Michigan P.A. of 1970, the corner points mentioned in lines 1 and 2 above were in conformance with regulations and rules therefore as required in the current manual of survey instructions of the United States Department of the Interior, Bureau of Land Management or by a decree of a Court of Law and/or that the corner points mentioned in lines 3, 4 and 5 above were in conformance with the rules of the Michigan Board of Land Surveyors or by a Decree of a Court of Law; established, re-established, monumented, re-monumented, recovered, found as expressed below:

NOTE: Not more than 4 corners, all in the same town and range, may be recorded on this certificate.

	A	B	C	D	E	F	G	H	I	J	K	L	M
2	6	5	4	3	2	1							
3													
4	7	8	9	10	11	12							
5													
6	18	17	16	15	14	13							
7													
8	19	20	21	22	23	24							
9													
10	30	29	28	27	26	25							
11													
12	31	32	33	34	35	36							
13													

A. Description of original monument and accessories and/or subsequent restoration:

- | | |
|---|---|
| <p>M-5
 GLO Sylvester Sibley DS, 1830
 Witness to post set by Lucius Lyon, DS 1826
 B. Ash 7 S 30 W 44
 Beech 6 N 33 W 21
 (additional info. see back of sheet)</p> | <p>1. April 5, 1972 LCRC No. 26 (Barry County)
 Recorded by Douglas Bonnama
 Set 3/4" Iron pipe on line with centerline of gravel to West and fence and tree line to East, centerline of Blacktop to South is 8' East.
 Nail in face 18" W. Cherry NW 47.22'
 Nail in face 10" W. Cherry W-NW 73.27'
 Nail in face of P. pole SW 74.10'
 Nail in face of 40" Maple E-SE 56.43</p> |
|---|---|

B. Description of corner evidence found and/or method applied in restoring or reestablishing corner:

- M-5 Found 3/4" Iron Pipe
 Found PK nail in N. side P. pole S55°W 74.15'
 Found Spike in S. side 24" Maple N35°W 47.51'
 Found spike in E. side 16" Elm N10°W 114.44'
 Found spike in N. side 8" Ash S50°E 45.67'
 C/L bit. read East 7.2'

APPROVED REMONUMENTATION CORNER
 P.A. 345 OF 1990
 ALLEGAN COUNTY
 DATE APPROVED 8-14-95
 COUNTY REP. David L. Van Dyke

Peer Group approval August 14, 1995

And is accepted as a careful and faithful perpetuation of the position of the original corner.

C. Description of monument for corner and accessories established to perpetuate locating the position of the corner:

- M-5 Replaced 3/4" Iron Pipe with Standard Allegan Co. Mon. (3/4" x 24" Iron Rod with cap)
 Set PK nail & Allegan Co. Remon. Tag in S. side P. Pole N 80° W 287.42'
 Set PK nail & Allegan Co. Remon. Tag in NW side P. Pole N 45° E 174.06'
 Set nail & Allegan Co. Remon. Tag in N. side 24" Oak N 90° E 154.55'
 Set 1/2" Rerod N 80° E 150.00'
 Stop sign post S 80° W 53.3'
 C/L N-S bit road
 M-5 corner is a common corner with A-5 Thomaspic Township, Barry County.

Signed by Steven C. Koerber Date 11-13-1995
 Surveyor's Michigan License No. 39085

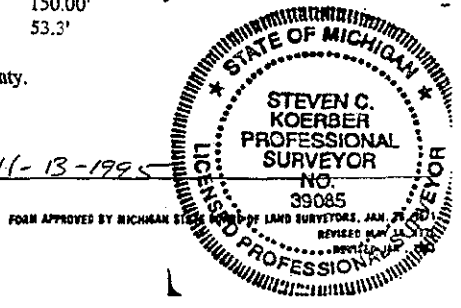

0005 PAGE 239

2. April 27, 1972
Barry Co. Rd. Comm
Iron
Guard Post N45°W 34.2'
Guard Post S45°W 34.7'
18" Cherry N40°W 47.3'
30" Maple S45°E 56.5'
8" Cherry N40°W 73.3'
C/L Road 7.2' East of Sec. cor.
3. Sept. 16, 1982
C.S. Hay & Assoc.
Recorded Survey L. 1, Pg. 726 (Barry Co.)
Found 3/4" I.P.
Nail in E. side 18" W. Cherry NW 47.34'
Nail in N. side 40" Maple ESE 57.56'
N. edge Street sign SW 31.17'
4. Sept. 23, 1985
Jonker Land Surveys
Recorded Surveys L. 1, Pgs. 884-886 (Barry Co.)
Found 3/4" I.P.
Nail in 18" W. Cherry NW 47.34'
Nail in 40" Maple ESE 57.56'
N. Edge Street Sign SW 31.17'
5. July 1991
MBN Eng./ Surv
Recorded Survey L. 2, Pg. 44 (Barry Co.)
Found 1" I.P. per LCRC 344
6. Dec. 2, 1993
Exxel Eng.
Recorded survey L. 2, Pg. 86 (Barry Co.)
1/2" Rerod
Nail in SW side C. Cherry N40°W 52.29'
Dbl hd nail NE side 10" Ash S45°E 39.82'
PK NW side P. pole S60°W 79.78'
Dbl hd nail E. side 14" Elm N10°W 116.08'