

**LAND CORNER RECORDATION CERTIFICATE**  
 Filing Requirement of Act 74, Mich. P.A. 1970

For corners in	Located in:	Corner Code #
Allegan (County)	4N 11W	M-9 (SE, 24)
1. Public Land Survey	T ___ R ___	Leighton Twp.
	T ___ R ___	
	T ___ R ___	
	T ___ R ___	
2. Property Controlling in Section	S ___ T ___ R ___	
3. Miscellaneous Property in Sec.	S ___ T ___ R ___	
	S ___ T ___ R ___	
	S ___ T ___ R ___	

1995 DEC 14 PM 2:35  
 REGISTERED  
 FILED

Register of Deeds Stamp & File Number

**SURVEY & REMONUMENTATION COMMISSION**  
 APR 29 1996

4. Lot No. \_\_\_\_\_, Recorded Plat \_\_\_\_\_  
 5. Private Claims \_\_\_\_\_

	A	B	C	D	E	F	G	H	I	J	K	L
2	6	5	4	3	2	1						
3												
4	7	8	9	10	11	12						
5												
6	16	17	18	19	20	21						
7												
8	10	20	21	22	23	24						
9												
10	30	28	26	27	26	25						
11												
12	31	32	33	34	35	36						
13												

I, Steven Koerber, in a field survey on August 31, 1995, do hereby certify that under requirements of P.A. 74, Michigan P.A. of 1970, the corner points mentioned in lines 1 and 2 above were in conformance with regulations and rules therefore as required in the current manual of survey instructions of the United States Department of the Interior, Bureau of Land Management or by a decree of a Court of Law and/or that the corner points mentioned in lines 3, 4 and 5 above were in conformance with the rules of the Michigan Board of Land Surveyors or by a Decree of a Court of Law; established, re-established, monumented, re-monumented, recovered, found as expressed below:

**NOTE: Not more than 4 corners, all in the same town and range, may be recorded on this certificate.**

- A. Description of original monument and accessories and/or subsequent restoration:
- |     |                          |                          |
|-----|--------------------------|--------------------------|
| M-9 | GLO Lucius Lyon DS. 1826 | 1. County Surveyor notes |
|     | B. Oak 8 S 3 1/2 W 37    | Stone                    |
|     | W. Oak 7 N65 W 28        | 12" Hickory NW 59.10     |
|     |                          | 30" Maple SW 41.50'      |
|     |                          | 12" Walnut SE 53.80'     |

B. Description of corner evidence found and/or method applied in restoring or reestablishing corner:

- |     |  |               |
|-----|--|---------------|
| M-9 | Found rerod in mon. box                            | North 8.56'   |
|     | Found rerod in mon. box                            | N70°W 85.85'  |
|     | Found square nail in N. side 33" Hickory           | N50°W 59.15'  |
|     | Found PK nail in NE side 4x4 wood Church sign post | S70°W 77.9'   |
|     | C/L 24" Maple                                      | N40°E 188.11' |
|     | SW corner Brick Hse.                               | N40°E 145.32' |
|     | Found PK nail in E. Side P. pole                   | N50°E 54.44'  |
|     | Found 3/4" Iron pipe                               |               |

APPROVED REMONUMENTATION CORNER  
 P.A. 345 OF 1990  
 ALLEGAN COUNTY  
 DATE APPROVED 8-14-95  
 COUNTY REP. And J. Koerber

This corner is accepted as a careful and faithful perpetuation of the position of the original corner.  
 Peer Group approval August 14, 1995

C. Description of monument for corner and accessories established to perpetuate locating the position of the corner:

- |     |  |         |         |
|-----|--|---------|---------|
| M-9 | Replaced rerod with Allegan Co. Mon. ( 3/4" x 24" Iron Rod with cap) |         |         |
|     | Set nail & Allegan Co. Remon. Tag in S. side 33" Hickory             | N 70° W | 85.74'  |
|     | Set nail & Allegan Co. Remon. Tag in N. side 24" Maple               | S 70° W | 78.31'  |
|     | Set PK nail & Allegan Co. Remon. Tag in SW side P. Pole              | N 35° W | 168.00' |
|     | Set PK nail & Allegan Co. Remon. Tag in SE side P. Pole              | N 40° E | 145.32' |
|     | SW corner Hse.   | N 40° E | 188.25' |
|     | A-9, Thornapple Township, Barry County, corner is North 8.56'        |         |         |
|     | GLO = 13 links = 5.58'   |         |         |

Signed by Steven C. Koerber Date 11-13-1995  
 Surveyor's Michigan License No. 39085

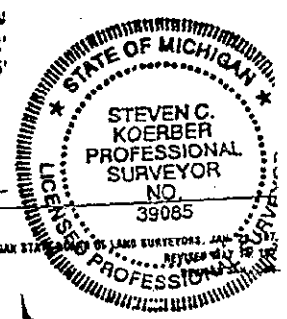

0005 PAGE 245

2. Jonker Land Surveys notes 1984  
Found 1" square bolt in mon box  
SW cor. brick Hse N40°E 188.15'  
1" Square bolt in mon. box North 8.55'  
C/L E. end CMP S25°E 59.4±  
PK nail in face 30" Maple N65°W 84.6'
3. Feb. 14, 1990  
LCRC Rec. L.4, PG 64 (Alleghen Co)  
Found 1" square iron in mon. box  
North. 8.55', 1" square iron @ C-line  
N35E, 145.91'. Spike in Util. pole  
N70W, 85.96', Nail in 36" Hickory  
S70W, 78.34', PK nail in 24" Maple
4. Holland Eng. notes 1990  
Found 1" Square iron in Mon Box  
1" Square iron at C/L road N 8.55'  
Spike in util pole N35°E 145.91'  
Nail in 36" Hickory N70°W 85.96'  
PK in 24" Maple S70°W 78.34'
5. Holland Eng. notes 1993  
1/2" Iron  
1/2" iron (Barry Corner) North 8.55'  
Nail in NE cor. Church sign post NW 59.15'  
17" Maple W-SW 78.10'  
P. pole NE 145.34'  
3/4" Pipe NE 54.44'  
30" Hickory W-NW 85.53'
6. Feb. 15, 1993  
LCRC recorded L. 4, Pg. 187 (Alleghen Co.)  
Basil Andress  
Found 1" iron  
Witness 1/2" iron  
Nail in NE cor. Church sign post NW 59.15'  
17" Maple W-SW 78.10'  
P. pole NE 145.34'  
3/4" Pipe NE 54.44'  
1/2" iron, (Barry Corner) North 8.55'  
30" Hickory W-NW 85.53'
7. Wightman Moored notes  
3/4" Iron pipe  
1/2" iron (Barry Corner) North 8.55'  
NE cor. Church sign post NW 59.15'  
17" Maple W-SW 78.10'  
30" Hickory W-NW 85.53'  
P. pole NE 145.34'