

**ALLEGAN COUNTY REMONUMENTATION
LAND CORNER RECORDATION CERTIFICATE
Filing Requirement of Act 74, Mich. P.A. 1970**

LIBER 006 PAGE 364

For corners in

<u>Allegan</u> (County)	Located In:	Corner Code #
	Dorr Twp.	
1. Public Land Survey	T <u>4</u> R <u>12</u> W	<u>M-3</u>
	T <u> </u> R <u> </u>	<u> </u>
	T <u> </u> R <u> </u>	<u> </u>
	T <u> </u> R <u> </u>	<u> </u>
2. Property Controlling in Section	S <u> </u> T <u> </u> R <u> </u>	<u> </u>
	S <u> </u> T <u> </u> R <u> </u>	<u> </u>
3. Miscellaneous Property in Sec.	S <u> </u> T <u> </u> R <u> </u>	<u> </u>
	S <u> </u> T <u> </u> R <u> </u>	<u> </u>

FILED
1/28/1999 2:44:39 PM
JOYCE A. WATTS
REGISTER OF DEEDS
ALLEGAN COUNTY, MICH

Register of Deeds Stamp & File Number

4. Lot No. _____, Recorded Plat _____
5. Private Claims _____

I, Robert J Jonker, in a field survey on 10-22-19 98 do hereby state that under requirements of P.A. 74, Michigan P.A. of 1970, the corner points mentioned in lines 1 and 2 above were in conformance with regulations and rules therefore as required in the current manual of survey instructions of the United States Department of the Interior, Bureau of Land Management or by a decree of a Court of Law and /or that the corner points mentioned in lines 3, 4 and 5 above were in conformance with the rules of the Michigan Board of Land Surveyors or by a Decree of a Court of Law; established, re-established, monumented, recovered, found as expressed below:

NOTE: Not more than 2 corners, all in the same town and range, may be recorded on this certificate.

1	A	B	C	D	E	F	G	H	I	J	K	L	M
2		6		5		4		3		2		1	
3													
4		7		8		9		10		11		12	
5													
6		18		17		16		15		14		13	
7													
8		19		20		21		22		23		24	
9													
10		30		29		28		27		26		25	
11													
12		31		32		33		34		35		36	
13													

A. Description of original monument and accessories and/or subsequent restoration:

G.L.O. North along East side Section 12 (see additional info. over)
80.00 ch. set post corner sections 1 & 12
Beech 18 S32W 27
Beech 5 N52W 20

B. Description of corner evidence found and/or method applied in restoring or reestablishing corner:

Fd R.R. spide under pk nail by witnesses listed in "A" above (over)

And is accepted as a careful and faithful perpetuation of the position of the original corner.

APPROVED REMONUMENTATION CORNER
P.A. 345 OF 1990
ALLEGAN COUNTY
DATE APPROVED Nov. 24, 1998
COUNTY REP. [Signature]

C. Description of monument for corner and accessories established to perpetuate locating the position of the corner:

Replaced with std. Allegan County monument
NE cor. hse fnd. S60°W 115.25'
SW Cor. brick hse N50°E 120.64'
Found pk - S. side p. pole S45°W 59.85'
Ameritech Utility box #4592 S65°E 114.57'
Allegan Co Remon pin South 9.18'

Traverse M-3 M-4, 2647.04'

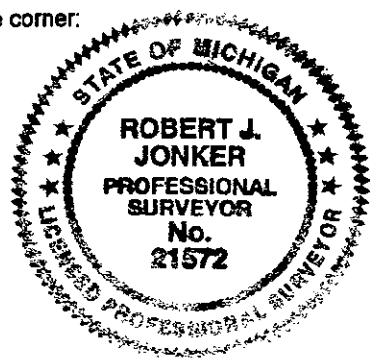

Signed by Robert J. Jonker
Surveyor's Michigan License No. 21572

Date 11-9-98

M-3 DORR TWP.

1. Ratekin-1973, recorded survey 10-22-98
 - Spike- NE Corner hse fnd. S60°W 115.1' check ok
 - SW Corner brick house N50°E 120.61' check ok
 - T. pole N30°E 56.07' out
 - T. pole S40°E 50.44' out
 - 24" maple S75°E 88.78' out
 - Spk. in C/L pavt.S. 9.24' check ok

2. 1973 L.C.R.C. recorded by Doug Bormema (Excel Eng.) in L. 02, P. 99
 - From part "B"-Found p.k. set spike, checks with wit. from Don Ratakin
 - Part "C" took witnesses
 - NE Corner hse. fnd. S60°W 115.10' check ok
 - SW Corner brick house N50°E 120.61' check ok
 - Nail in side T. pole N30°E 56.07' out
 - Nail in side 24 maple S75°E 88.78' out
 - Nail in side T. pole S40°E 50.44' out
 - spk. in pav't. (Leighton Corner) S. 9.24' check ok
 - On C/L pav't. to N. & S. check ok

3. 1974 L.C.R.C. recorded by Duane A. Ankron (RE: CP Co. Strip)
 - recorded in L. 02, on pages 312.
 - Part "B"-Found boat spike
 - Part "C"-took wit.
 - 36" maple N35°E 42.15' out
 - st. sign S40°E 45.25' out
 - P. pole S35°W 59.98' check ok

4. Holland Eng.-No date
 - 1974 L.C.R.C. recorded by Duane A. Ankron (RE: CP Co. strip)
 - recorded in Liber 2 on page 312
 - Part "B"-Found boat spike
 - Part "C"-took Wit.
 - 36" maple N35°E 42.15' out
 - st. sign S40°E 45.25' out
 - p. pole S35°W 59.98' check ok

5. CP Co. survey by Duane Ankron
 - 1974-L.C.R.C. recorded by Duane A. Ankron (RE: CP. Co strip)
 - recorded in Liber 2 on page 312
 - Part "B" found boat spike
 - Part "C" took wit.
 - 36" maple N35°E 42.15' out
 - st. sign S40°E 45.25' out
 - p. pole S35°W 59.98' check ok
 - Nail (SW cor. Section 6-4-11) South 9.24' check ok

LIBER 006 PAGE 365