

**SURVEY
REMONUMENTATION**

APR 29 1998

SECTION

**Allegan County Remonumentation
LAND CORNER RECORDATION CERTIFICATE
Filing Requirement of Act 74, Mich. P.A. 1970**

For corners in

Allegan
(County)

Located In:

Corner Code #

- | | | |
|------------------------------------|---|---|
| 1. Public Land Survey | T <u>4N</u> R <u>13W</u> | <u>A-4 (W$\frac{1}{2}$, 7)</u> |
| | T <u> </u> R <u> </u> | <u>Salem Twp.</u> |
| | T <u> </u> R <u> </u> | <u> </u> |
| | T <u> </u> R <u> </u> | <u> </u> |
| 2. Property Controlling in Section | S <u> </u> T <u> </u> R <u> </u> | <u> </u> |
| | S <u> </u> T <u> </u> R <u> </u> | <u> </u> |
| 3. Miscellaneous Property in Sec. | S <u> </u> T <u> </u> R <u> </u> | <u> </u> |
| | S <u> </u> T <u> </u> R <u> </u> | <u> </u> |

FILED

1/28/1999 2:44:39 PM

JOYCE A. WATTS
REGISTER OF DEEDS
ALLEGAN COUNTY, MICH

LIBR0007 PAGE 57

Register of Deeds Stamp & File Number

4. Lot No. _____, Recorded Plat _____
5. Private Claims _____

I, John C. Bueche, in a field survey on May 8, 1998 do hereby state that under requirements of P.A. 74, Michigan P.A. of 1970, the corner points mentioned in lines 1 and 2 above were in conformance with regulations and rules therefore as required in the current manual of survey instructions of the United States Department of the Interior, Bureau of Land Management or by a decree of a Court of Law and /or that the corner points mentioned in lines 3, 4 and 5 above were in conformance with the rules of the Michigan Board of Land Surveyors or by a Decree of a Court of Law; established, re-established, monumented, recovered, found as expressed below:

NOTE: Not more than 2 corners, all in the same town and range, may be recorded on this certificate.

	A	B	C	D	E	F	G	H	I	J	K	L	M	
1														
2	6			5			4			3			2	1
3														
4	7			6			9			10			11	12
5														
6	18			17			16			15			14	13
7														
8	19			20			21			22			23	24
9														
10	30			29			28			27			26	25
11														
12	31			32			33			34			35	36
13														

A. Description of original monument and accessories and/or subsequent restoration:

A-4 GLO	LCRC 1-38, July, 1972, Ratekin	Survey 949-420, HEI Nov., 1978
Did not set	Fnd. 1" iron	Fnd. 1" pipe
	18" Oak N 60° E 21.8'	18" Oak N 60° E 21.82'
	12" Oak S 15° E 66.6'	12" Oak S 15° E 66.60'
	Fence cor. tree N 75° E 18.4'	PP S 45° E 36.82'
	Tw. Oak N 50° W 21.1'	
	3' S. of fence East of rd.	
	C/L gravel rd. West 2'	

OVER APPROVED REMONUMENTATION CORNER
P.A. 345 OF 1990
ALLEGAN COUNTY
DATE APPROVED JUNE 9 1998
COUNTY REP. [Signature]

B. Description of corner evidence found and/or method applied in restoring or reestablishing corner:

A-4 Found 1/2" rerod on Township Line between M-4 & M-5, 4-14 in gravel road

18" Oak N 60° E 21.8'	PP S 45° E 36.82'
Fence cor. tree N 75° E 18.4'	Peer group approved
3' S. of fence East of rd.	
C/L gravel rd. West 2'	Traverse 2649.89'

This position not established by original government surveyors.

This monument is accepted as the best available evidence of the position of the corner.

C. Description of monument for corner and accessories established to perpetuate locating the position of the corner:

A-4 Replaced 1/2" rerod with 3/4" x 24" Pin with Allegan Co. Cap in gravel road
Nail & Allegan Co. Remon. Tag in NE side PP S 50° E 37.52'
Nail & Allegan Co. Remon. Tag in S side 16" Oak N 80° W 55.08'
Nail & Allegan Co. Remon. Tag in SW side 10" Elm N 25° W 66.58'
Nail & Allegan Co. Remon. Tag in E side 8" Walnut N 30° E 52.41'
Allegan Co. Mon. M-4 (E 1/4 12, 4-14) North 11.07'
C/L gravel road N-S is West 3'±
C/L drive East is South 40'±



Signed by John C. Bueche
Surveyor's Michigan License No. 13027

Date 6-4-98

APR 29 1958

SECTION

A-4 SALEM TWP.
PART A - continued

HEI inform. sheet
Fnd. 3/4" steel bar WRB 1972
12" Oak SE 16.37'
30" Oak ENE 21.58'
PP SE 36.82'
12" Tw. Oak WNW 31.70'

Set iron
18" Oak ENE 21.80'
Tw. Oak WNW 21.10'
Fence cor. E. 1840'
Tree 3' of E-W fence E. of rd.

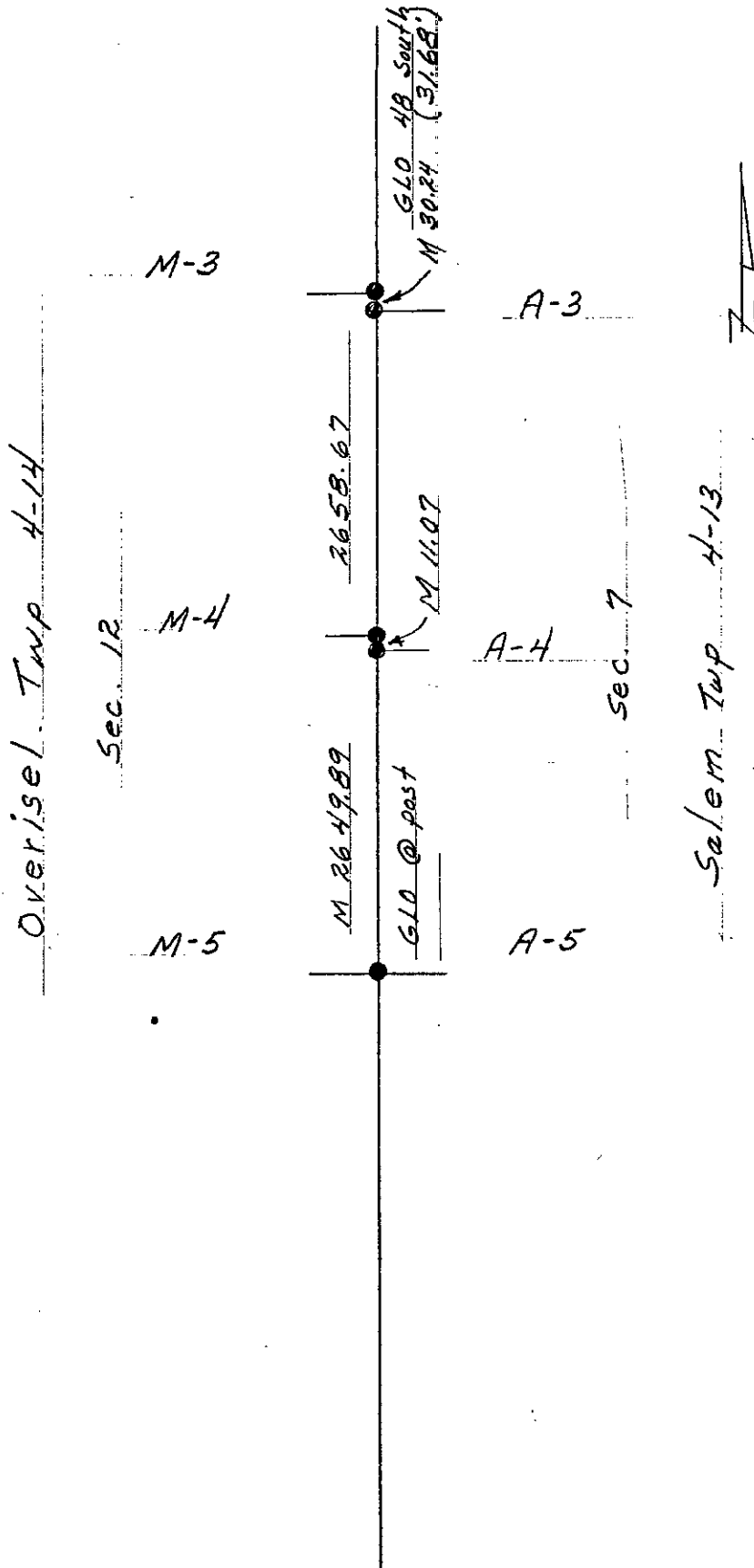

LIBR0007 PAGE058