

DEC 4 2 27 PM '96

*Wanda R. Conway*

REGISTER OF DEEDS

LAND CORNER RECORDATION CERTIFICATE  
Filing Requirement of Act 74, Mich. P.A. 1970

For corners in

ANTRIM

(County)

Located In:

Corner Code #

1. Public Land Survey

T	30N	R	9W	K-7
T	_____	R	_____	_____
T	_____	R	_____	_____
T	_____	R	_____	_____
T	_____	R	_____	_____
S	_____	T	_____	_____
S	_____	T	_____	_____
S	_____	T	_____	_____
S	_____	T	_____	_____

2. Property Controlling in Section

3. Miscellaneous Property in Sec.

4. Lot No. \_\_\_\_\_, Recorded Plat \_\_\_\_\_

5. Private Claims \_\_\_\_\_

Register of Deeds Stamp & File Number

I, NEIL L. WAY, in a field survey on NOV. 4, 1996 do hereby state that under requirements of P.A. 74, Michigan P.A. of 1970, the corner points mentioned in lines 1 and 2 above were in conformance with regulations and rules therefore as required in the current manual of survey instructions of the United States Department of the Interior, Bureau of Land Management or by a decree of a Court of Law and /or that the corner points mentioned in lines 3, 4 and 5 above were in conformance with the rules of the Michigan Board of Land Surveyors or by a Decree of a Court of Law, established, re-established, monumented, recovered, found as expressed below:

NOTE: Not more than 2 corners, all in the same town and range, may be recorded on this certificate.

	A	B	C	D	E	F	G	H	I	J	K	L	M
1													
2		6		5		4		3		2		1	
3													
4		7		8		9		10		11		12	
5													
6		18		17		16		15		14		13	
7													
8		19		20		21		22		23		24	
9													
10		30		29		28		27		26		25	
11													
12		31		32		33		34		35		36	
13													

A. Description of original monument and accessories and/or subsequent restoration:

GLO SET POST AUG. 1855, BEECH 10 N20E 26, BEECH 8 S12W 28  
CHURCH NOV. 1903 SEP ELM STK IN C/L ROAD.  
CHURCH MAR 1909 FOUND STK & USED.  
STATE HWY PLANS 1951 SHOW 1/2" IRON ROD IN MONUMENT BOX 1.5' WEST OF C/L

B. Description of corner evidence found and/or method applied in restoring or reestablishing corner:

FOUND 1/2" IRON PIPE IN MON BOX 1.5' WEST OR C/L INT.

C. Description of monument for corner and accessories established to perpetuate locating the position of the corner:

Ratified by peer group	SET CO. MONT
in accordance with	S62W 91.35' P. POLE
P.O. 345	N70E 76.70' P. POLE
Antrim Co. Chairman	N68E 48.95' STOP SIGN
	S65W 60.10' STOP SIGN

*Arthur L. Lennox*  
Arthur L. Lennox  
Nov. 26, 1996

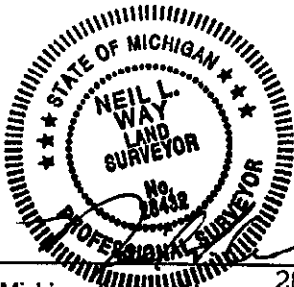

Signed by \_\_\_\_\_  
Surveyor's Michigan License No. 28432

Date NOV. 25, 1996

*112*

002 348