

DEC 4 2 26 PM '96

LAND CORNER RECORDATION CERTIFICATE
Filing Requirement of Act 74, Mich. P.A. 1970

Wanda R. Conway

For corners in

ANTRIM

(County)

Located In:

Corner Code #

- | | | |
|------------------------------------|--------------------------|------------|
| 1. Public Land Survey | T <u>30N</u> R <u>9W</u> | <u>L-5</u> |
| | T ___ R ___ | _____ |
| | T ___ R ___ | _____ |
| | T ___ R ___ | _____ |
| 2. Property Controlling in Section | S ___ T ___ R ___ | _____ |
| | S ___ T ___ R ___ | _____ |
| 3. Miscellaneous Property in Sec. | S ___ T ___ R ___ | _____ |
| | S ___ T ___ R ___ | _____ |

REGISTER OF DEEDS

Register of Deeds Stamp & File Number

4. Lot No. _____, Recorded Plat _____
5. Private Claims _____

I, NEIL L. WAY, in a field survey on NOV. 4, 1996 do hereby state that under requirements of P.A. 74, Michigan P.A. of 1970, the corner points mentioned in lines 1 and 2 above were in conformance with regulations and rules therefore as required in the current manual of survey instructions of the United States Department of the Interior, Bureau of Land Management or by a decree of a Court of Law and /or that the corner points mentioned in lines 3, 4 and 5 above were in conformance with the rules of the Michigan Board of Land Surveyors or by a Decree of a Court of Law; established, re-established, monumented, recovered, found as expressed below:

NOTE: Not more than 2 corners, all in the same town and range, may be recorded on this certificate.

1	A	B	C	D	E	F	G	H	I	J	K	L	M
2		6		5		4		3		2		1	
3													
4		7		8		9		10		11		12	
5													
6		10		17		16		15		14		13	
7													
8		19		20		21		22		23		24	
9													
10		30		29		28		27		26		25	
11													
12		31		32		33		34		35		36	
13													

A. Description of original monument and accessories and/or subsequent restoration:

GLO SET POST AUG 1855, SUGAR 14 N21E 20, SUGAR 6 S63W 10
CHURCH JAN 1886 SET STK FROM WIT'S GLO
CHURCH MAY 1902 FOUND STAKE IN ROAD CUT.
L. FEINDT SET "T" IRON APRIL 1978 & REC. CERT.

B. Description of corner evidence found and/or method applied in restoring or reestablishing corner:

FOUND "T" IRON 7' SOUTH OF ROAD & ON LINE WITH OLD FENCE LINE TO N&S, ALSO FOUND LARGE STONE SURROUNDED BY SMALLER ONES BELOW "T" IRON

C. Description of monument for corner and accessories established to perpetuate locating the position of the corner:

Ratified by peer group
in accordance with
P.O. 345
Antrim Co. Chairman
Arthur L. Lennox
Arthur L. Lennox
Nov. 26, 1996

SET CO. MONT.
NORTH 98.40' MPL 40"
N05E 47.10' FENCE POST
NORTH 52 WEST 123.45' OAK 6"
S50W 60.25' J. PINE 6"

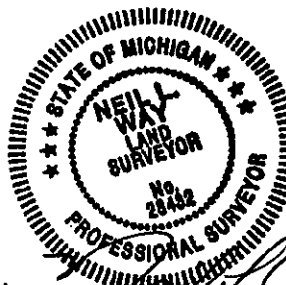

Signed by _____
Surveyor's Michigan License No. 28432

Date NOVEMBER 22, 1996

002 338

102