

DEC 1 0 1993

LIBER 1 PAGE 264

007563

RECORDED ALPENA COUNTY MI.

1993 Alpena County Remonumentation Corner

LAND CORNER RECORDATION CERTIFICATE
Filing Requirement of Act 74, Mich. P.A. 1970

DEC 1 3 16 PM '93

REGISTER OF DEEDS

For corners in Alpena

(County)

Located In:

Corner Code #

- 1. Public Land Survey T 32N R 8E C-6 (E 1/2, 18) (Alpena Twp.)
2. Property Controlling in Section S T R
3. Miscellaneous in Sec. S T R

Register of Deeds Stamp & File Number

- 4. Lot No. , Recorded Plat
5. Private Claims

Grid table with columns A-M and rows 2-13. A dot is marked at row 6, column B.

I, Thomas L. Fabis in a field survey on August 19 19 93 do hereby certify that under requirements of P.A. 74, Michigan P.A. of 1970, the corner points mentioned in lines 1 and 2 above were in conformance with regulations and rules therefore as required in the current manual of survey instructions of the United States Department of the Interior, Bureau of Land Management or by a decree of a Court of Law and/or that the corner points mentioned in lines 3, 4 and 5 above were in conformance with the rules of the Michigan Board of Land Surveyors or by a Decree of a Court of Law; established, re-established, monumented, re-monumented, recovered, found as expressed below:

NOTE: Not more than 4 corners, all in the same town and range, may be recorded on this certificate.

A. Description of original monument and accessories and/or subsequent restoration:

- 1855: G.L.O. Resurvey by Josiah Knauer - Set post (Cedar 8 N32E 31, Lynn 7 S17W 23).
1904: County Survey by Jos. W. McNeil - Found G.L.O. corner and N.B.T. stump (cedar 8 - N32E - 31,) set new 4" X 4" cedar stake.
1908: County survey by Jos. W. McNeil - Found 4" X 4" cedar stake previously set by himself in 1904.

B. Description of corner evidence found and/or method applied in restoring or reestablishing corner:

1993: Set 1/2" iron rod in center of gravel road (Kanowski Rd.) at the intersection with an old E-W 1/4 line fence extended from the West and is accepted as the best available evidence of the position of the original corner. The position of this corner is compatible with the 1904 and 1908 County Surveys by Jos. W. McNeil.

C. Description of monument for corner and accessories established to perpetuate locating the position of the corner:

1993: Set 1/2" iron rod with 3" aluminum cap, stamped to identify the corner. Reestablished witnesses are: Set tag #31591 in 8" Apple - N80°W - 47.08' Set tag #31591 in P. Pole - S55°W - 34.91' Set tag #31591 in 6" Cedar - S65°E - 80.70' Set tag #31591 in 3" Elm - N70°E - 58.05'

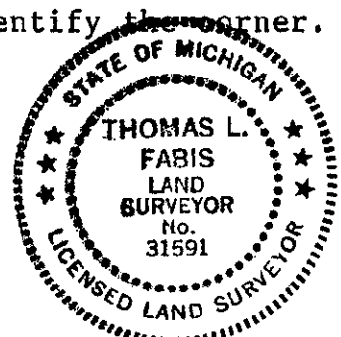

Signed by Thomas L. Fabis

Date November 22, 1993

Surveyor's Michigan License No. 31591