

FEB 18 1999

Liber 00003 Page 0032

SECTION

ANTRIM COUNTY MI.
Register of Deeds
Filing Requirement of Act 74, Mich. P.A. 1970 Recorded

12-21-1998 11:37:24

Wanda R. Conway
REGISTER OF DEEDS

Register of Deeds Stamp & File Number

For corners in

ANTRIM
(County)

MILTON TOWNSHIP
Located In:

Corner Code #

1998 REMONUMENTATION
1. Public Land Survey

T. 28N R. 8W B-5

T. R.

T. R.

T. R.

2. Property Controlling
in Section

S. T. R.

S. T. R.

3. Miscellaneous
Property in Sec.

S. T. R.

S. T. R.

4. Lot No. , Recorded Plat

5. Private Claims

	A	B	C	D	E	F	G	H	I	J	K	L	M
1													
2	6		5		4		3		2		1		
3													
4	7		8		9		10		11		12		
5	●												
6	18		17		16		15		14		13		
7													
8	19		20		21		22		23		24		
9													
10	30		29		28		27		26		25		
11													
12	31		32		33		34		35		36		
13													

I, RICHARD J. KRAL, in a field survey on 11-11, 1998 do hereby state that under requirements of P.A. 74, Michigan P.A. of 1970, the corner points mentioned in lines 1 and 2 above were in conformance with regulations and rules therefore as required in the current manual of survey instructions of the United States Department of the Interior, Bureau of Land Management or by a decree of a Court of Law and /or that the corner points mentioned in lines 3, 4 and 5 above were in conformance with the rules of the Michigan Board of Land Surveyors or by a Decree of a Court of Law; established, re-established, monumented, recovered, found as expressed below:

NOTE: Not more than 2 corners, all in the same town and range, may be recorded on this certificate.

A. Description of original monument and accessories and/or subsequent restoration:

- B-5: 1/4 Cor. Common to Secs. 7 & 18, T28N-R8W, Milton Township
- 1852, Gov't Re-survey, set cor. Tamarack 6", N68°W, 21 Lks. (13.86'); Tamarack 12", S42°E, 33 Lks. (21.78") MC. East, 10.04 Ch. (662.64')
- 1923, Survey by W.S. Merrill (Kalkaska Co. Surveyor) FB.# 31, Pg. 38; found cor.; no desc. or acc.
- 1945, Plat of Fairmount Torch River Sub; by H.L. Botsford, rec. in Lib. 2, Pg. 89; P.O.B. of plat is conc. mon. East, 549.6' from B-5, no desc. or acc.
- 1953, Drawing by A.L. Dragoo, not recorded; shows cor. only
- 1958, Survey by A.G. Ericksen, not recorded; shows conc. mon. East 615.6' from B-5 no desc. or acc.
- 1971, Survey by P.G. Perla, rec. in Lib. 191, Pg. 443; fd square Cedar Stake; found conc. mon. East, 281.97' & set wood stake East, 483.81'
- 1972, Survey by C.F. Roser (DNR Surveyor) not recorded
- 1972, LCRC by C.F. Roser (DNR Surveyor) rec. in Lib. 1, Pg. 150; found square Cedar stakes & set 1" X 6' pipe w/ Alm dept. cap; 5" Tamarack, N82°W, 18.7', 9" W. Pine, due S 34.5'; 9" Cedar, S57°E, 45.0'
- 1973, Survey by L.J. Czubak rec. in Lib. 213, Pg. 288; fd. PK nail; no acc.
- 1984, Survey by T.B. Smith; rec. in Lib. 287, Pg. 511; acc. same as LCRC of 1972, rec. in Lib. 1, Pg. 150
- 1996, Survey by R.J. Kral; not recorded; shows cor. only no desc. or acc.

B. Description of corner evidence found and/or method applied in restoring or reestablishing corner:

- B-5: 1/4 Cor. Common to Secs. 7 & 18, T28N-R8W, Milton Township
- Fd. 3/4" iron pipe in 1 1/4" iron pipe w/DNR cap; cor. is 515 +/- West of Torch River Road along the South prop. line of house #13990 Left DNR mon. in place.
- Fd. blazed W (1/4 S & NBT) scribed in NW faced of 9" Cedar S54°E, 44.51'
- Fd. blazed W (1/4 S & NBT) scribed in N faced 10" W. Pine S04°W, 33.93' (R.34.5')
- Fd. 6" stump, N80°W, 18.5' (R.18.7')
- No G.L.O. witnesses were found.

C. Description of monument for corner and accessories established to perpetuate locating the position of the corner:

- B-5: 1/4 Cor. Common to Secs. 7 & 18, T28N-R8W, Milton Township
- Fd. 3/4" iron pipe in 1 1/4" iron pipe w/DNR cap; cor. is 515 +/- West of Torch River Road along the South prop. line of house #13990 Left DNR mon. in place.
- Fd. blazed W (1/4 S & NBT) scribed in NW faced of 9" Cedar S54°E, 44.51'
- Fd. blazed W (1/4 S & NBT) scribed in N faced 10" W. Pine S04°W, 33.93' (R.34.5')
- Fd. 6" stump, N80°W, 18.5' (R.18.7')
- Set nail in 9" Cedar, S54°E, 44.51'
- Set nail in S. side 8" Spruce, S83°W, 37.14'
- Set nail in W. side 5" Maple, N13°E, 17.92'

Ratified by peer group
in accordance with
P.O. 345
Antrim Co. Chairman
Arthur L. Lennox
Arthur L. Lennox
Nov. 18, 1998

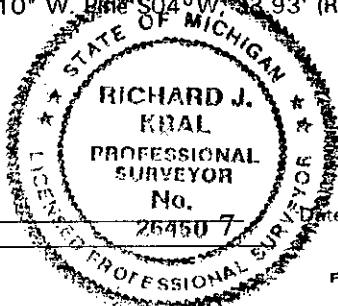

Signed by *Richard J. Kral*
Michigan License No. 26450

12-16-98

Surveyor's