

LAND CORNER RECORDATION CERTIFICATE  
 Filing Requirement of Act 74, Mich. P.A. 1970

Liberal 000003 Page 0154

For corners in "ECHO TWP"

ANTRIM (County) Located In: Corner Code #

1. Public Land Survey T 31N R 7W A-5  
 T R  
 T R  
 T R

2. Property Controlling in Section S T R  
 S T R

3. Miscellaneous Property in Sec. S T R  
 S T R

ANTRIM COUNTY MI.  
 Register of Deeds  
 Recorded

12-21-2000 11:10:04

Manda R. Conway  
 REGISTER OF DEEDS

Register of Deeds Stamp & File Number

4. Lot No. \_\_\_\_\_, Recorded Plat \_\_\_\_\_

5. Private Claims \_\_\_\_\_

I, NEIL L WAY, in a field survey on DEC. 18, 2000 do hereby state that under requirements of P.A. 74, Michigan P.A. of 1970, the corner points mentioned in lines 1 and 2 above were in conformance with regulations and rules therefore as required in the current manual of survey instructions of the United States Department of the Interior, Bureau of Land Management or by a decree of a Court of Law and for that the corner points mentioned in lines 3, 4 and 5 above were in conformance with the rules of the Michigan Board of Land Surveyors or by a Decree of a Court of Law, established, re-established, monumented, recovered, found as expressed below:

NOTE: Not more than 2 corners, all in the same town and range, may be recorded on this certificate.

	A	B	C	D	E	F	G	H	I	J	K	L	M
1													
2	6		5		4		3		2		1		
3													
4	7		8		9		10		11		12		
5													
6	18		17		16		15		14		13		
7													
8	19		20		21		22		23		24		
9													
10	30		29		28		27		26		25		
11													
12	31		32		33		34		35		36		
13													

A. Description of original monument and accessories and/or subsequent restoration:

A-5 NW CORNER SEC. 18  
 GLO SET CORNER POST 1857.

BEECH 12 N35 1/2 W 39L  
 BEECH 12 S31W 42L  
 OLD CORNER 550 L N, 56 L E.

SURVEY &  
 REMONUMENTATION  
 JAN 23 2001  
 SECTION

B. Description of corner evidence found and/or method applied in restoring or reestablishing corner:

A-5 NW CORNER SEC. 18  
 FOUND 3/4" IRON BAR IN CENTERLINE ROAD TO SOUTH, ON LINE WITH FENC. LINES TO EAST AND WEST.  
 33' EAST OF OLD RIGHT OF WAY FENCE TO NORTH.

C. Description of monument for corner and accessories established to perpetuate locating the position of the corner:

A-5 NW CORNER SEC. 18  
 ACCEPTED AS CORNER, REMOVED 3/4" IRON AND REPLACED WITH COUNTY MONUMENT.

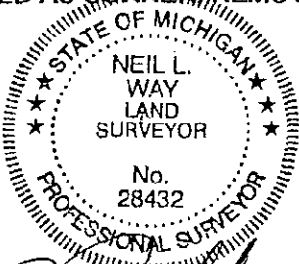

N68E 22.34' MAPLE 12"  
 N38E 10.30' MAPLE 6"  
 S65W 27.29' MAPLE 12"  
 S10W 51.41' MAPLE 6

Ratified by Peer Group  
 In accordance with  
 P.A. 345  
 Antrim Co. Chairman

*Arthur L. Lennox*  
 Arthur L. Lennox, P.E., P.S.  
 Nov. 28, 2000

Signed by Neil L. Way  
 Surveyor's Michigan License No. 28432

Date Dec. 18, 2000