

For corners in "ECHO TWP"

ANTRIM (County) Located In: Corner Code #  
 1. Public Land Survey T 31N R 7W D-5  
 T R  
 T R  
 T R  
 2. Property Controlling S T R  
 in Section S T R  
 3. Miscellaneous S T R  
 Property in Sec. S T R

ANTRIM COUNTY MI.  
 Register of Deeds  
 Recorded

12-21-2000 11:09:17

Wanda R. Conway  
 REGISTER OF DEEDS

Register of Deeds Stamp & File Number

4. Lot No. \_\_\_\_\_, Recorded Plat \_\_\_\_\_  
 5. Private Claims \_\_\_\_\_

I, NEIL L. WAY, in a field survey on DEC. 18, 2000 do hereby state that under requirements of P.A. 74, Michigan P.A. of 1970, the corner points mentioned in lines 1 and 2 above were in conformance with regulations and rules therefore as required in the current manual of survey instructions of the United States Department of the Interior, Bureau of Land Management or by a decree of a Court of Law and/or that the corner points mentioned in lines 3, 4 and 5 above were in conformance with the rules of the Michigan Board of Land Surveyors or by a Decree of a Court of Law, established, re-established, monumented, recovered, found as expressed below:

NOTE: Not more than 2 corners, all in the same town and range, may be recorded on this certificate.

	A	B	C	D	E	F	G	H	I	J	K	L	M
1													
2	6		5		4		3		2		1		
3													
4	7		8		9		10		11		12		
5													
6	18		17		16		15		14		13		
7													
8	19		20		21		22		23		24		
9													
10	30		29		28		27		26		25		
11													
12	31		32		33		34		35		36		
13													

A. Description of original monument and accessories and/or subsequent restoration:

D-5 NORTH 1/4 CORNER SEC. 17  
 GLO SET CORNER POST, A STAKE 3 1/2"  
 BEECH 7 N30 1/4 E 27L  
 BEECH 13 S32 1/4 W 39L  
 MARY FEINDT, SEPT 18, 1975, L 224, P 402 FOUND A 1 1/2" IRON PIPE.  
 LENNOX, LCR AUG. 6, 1998, L 3, P 10 FOUND A 1 1/2" IRON PIPE AT FENCE END.

SURVEY &  
 REMONUMENTATION

JAN 23 2001

SECTION

B. Description of corner evidence found and/or method applied in restoring or reestablishing corner:

D-5 NORTH 1/4 CORNER SEC. 17  
 FOUND 1 1/2" IRON PIPE AT END OF FENCE TO EAST AND IN CENTERLINE OF TRAIL ROAD TO NORTH.

C. Description of monument for corner and accessories established to perpetuate locating the position of the corner:

D-5 NORTH 1/4 CORNER SEC. 17  
 ACCEPTED 1 1/2" IRON PIPE AS CORNER, REMOVED AND REPLACED WITH COUNTY MONUMENT.

EAST 21.14' FENCE COR POST (LANE FNC. TO)  
 S55E 16.71' P. POLE  
 S32W 28.67' MAPLE 8"  
 N25W 34.38' POPLAR 12"  
 S60W 94.50' NE COR. HOUSE

Ratified by Peer Group  
 In accordance with  
 P.A. 345  
 Antrim Co. Chairman

Arthur L. Lennox, P.E., P.S.  
 Nov. 28, 2000

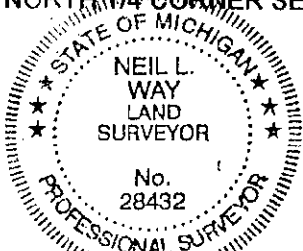

igned by Neil L. Way  
 urveyor's Michigan License No. 28432

Date DEC. 18, 2000