

LAND CORNER RECORDATION CERTIFICATE
Filing Requirement of Act 74, Mich. P.A. 1970

For corners in "ECHO TWP"

<u>ANTRIM</u> (County)	Located In:	Corner Code #
1. Public Land Survey	T <u>31N</u> R <u>7W</u>	<u>D-7</u>
	T ___ R ___	_____
	T ___ R ___	_____
	T ___ R ___	_____
2. Property Controlling in Section	S ___ T ___ R ___	_____
	S ___ T ___ R ___	_____
3. Miscellaneous Property in Sec.	S ___ T ___ R ___	_____
	S ___ T ___ R ___	_____

ANTRIM COUNTY MI.
Register of Deeds
Recorded

12-31-2000 11:09:04

Wanda P. Conway
REGISTER OF DEEDS

Register of Deeds Stamp & File Number

4. Lot No. _____, Recorded Plat _____

5. Private Claims _____

I, NEIL L WAY, in a field survey on DEC. 18, 2000 do hereby state that under requirements of P.A. 74, Michigan P.A. of 1970, the corner points mentioned in lines 1 and 2 above were in conformance with regulations and rules therefore as required in the current manual of survey instructions of the United States Department of the Interior, Bureau of Land Management or by a decree of a Court of Law and for that the corner points mentioned in lines 3, 4 and 5 above were in conformance with the rules of the Michigan Board of Land Surveyors or by a Decree of a Court of Law; established, re-established, monumented, recovered, found as expressed below.

NOTE: Not more than 2 corners, all in the same town and range, may be recorded on this certificate.

	A	B	C	D	E	F	G	H	I	J	K	L	M
1													
2	6		5		4		3		2		1		
3													
4	7		8		9		10		11		12		
5													
6	18		17		16		15		14		13		
7													
8	19		20		21		22		23		24		
9													
10	30		29		28		27		26		25		
11													
12	31		32		33		34		35		36		
13													

1. Description of original monument and accessories and/or subsequent restoration:

D-7 SOUTH 1/4 CORNER SEC. 17
GLO SET CORNER POST, A STAKE 3 1/2"

HEMLOCK 32 N32 1/4 E 3L
SUGAR 13 S46 3/4 W 27L

MARY FEINDT, MAY 27, 1976, L 226, P 630 SET A T IRON AT SINGLE PRORATION MEASUREMENT.
JONES, CERT. AUG. 25, 1980, L 254, P 347 FOUND AND USED ABOVE T IRON.

2. Description of corner evidence found and/or method applied in restoring or reestablishing corner:

D-7 SOUTH 1/4 CORNER SEC. 17

FOUND T IRON AND CAP #3920 (FEINDT) AS STATED ABOVE.

SURVEY &
REMONUMENTATION

JAN 23 2001

SECTION

3. Description of monument for corner and accessories established to perpetuate locating the position of the corner:

D-7 SOUTH 1/4 CORNER SEC. 17

ACCEPTED T IRON AS CORNER, REMOVED AND
REPLACED WITH COUNTY MONUMENT.

NORTH 53.88' MAPLE 18"
S05W 49.70' PINE 12"
S75E 54.92' MAPLE 20"
S30E 50.58' PINE 8"

Ratified by Peer Group
In accordance with
P.A. 345
Antrim Co. Chairman

Arthur L. Lennox
Arthur L. Lennox, P.E., P.S.
Nov. 28, 2000

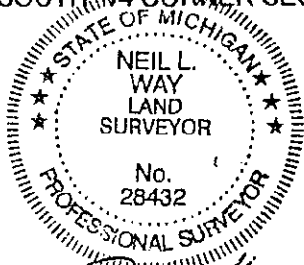

igned by *Neil L. Way*
urveyor's Michigan License No. 28432

Date DEC. 18, 2000